



Road Running Technical Council
USA Track & Field
Measurement Certificate



Name of the course Pacer Trail 300 Meters Distance 300 M
Location (state) OH (city) Beavercreek
Type of course: Calibration
Measuring Methods: Steel Tape
Measured By Joe Riess - 1379 Bareback Trail - Beavercreek, OH 45434 - (937) 361-6925 - vojoe26@yahoo.com
Race Contact N/A
Date(s) when course measured: December 6, 2020
Number of measurements of entire course: 2 Course Configuration: point to point
Elevation (meters above sea level) Start 249.94 Finish 249.94 Lowest N/A Highest N/A
Straight line distance between start and finish 300 M Drop 0.00 m/km Separation 100.00 %
Type of surface: Paved 100 % Dirt 0 % Gravel 0 % Grass 0 % Track 0 %
Effective date of certification: December 7, 2020 Certification code: OH20012DH

Note to Race Director: Use this Certification Code
in all public announcements relating to your race.

Be It Officially Noted That

Based on examination of data provided by the above named measurer, the course described above and in the map attached is hereby certified as reasonably accurate in measurement according to the standards adopted by the Road Running Technical Council. If any changes are made to the course, this certification becomes void, and the course must then be recertified.

Verification of Course --- In the event a National Open Record is set on the course, or at the discretion of USA Track & Field, a verification measurement may be required to be performed by a member of the Road Running Technical Council. If such a remeasurement shows the course to be short, then all pending records will be rejected and the course certification will be cancelled.

This certification expires on December 31 of the year: **2030**

AS NATIONALLY CERTIFIED BY:

Date: December 8, 2020

David Heithaus - USATF/RRTC Certifier - 23000 Caves Road, Gambier OH 43022
(928) 210-7578 - heithausd@kenyon.edu



USATF Certificate
OH20012DH
Effective: 12/07/2020
Through: 12/31/2030

PACER TRAIL 300 METERS
CALIBRATION COURSE
BEAVERCREEK, OHIO

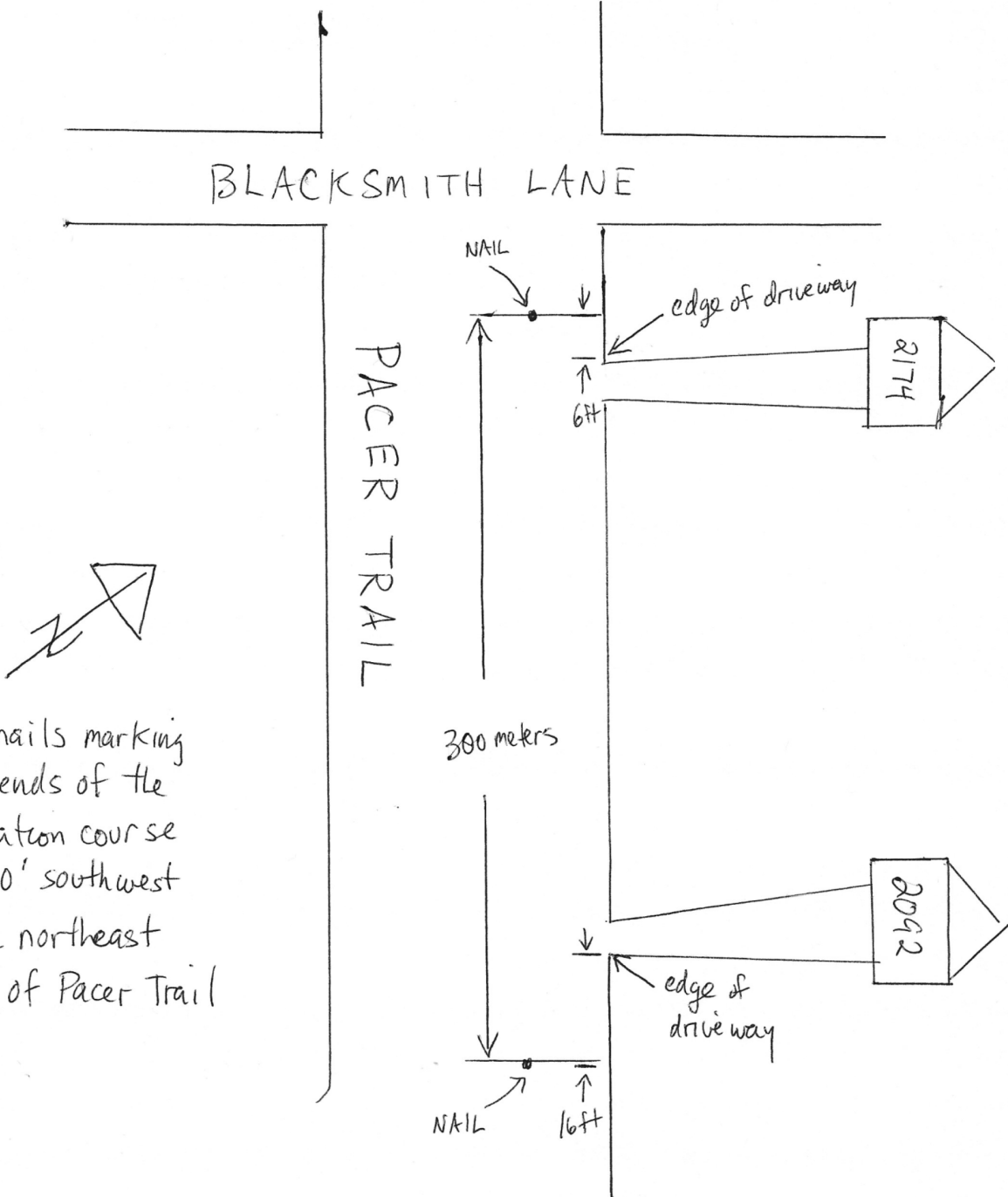

The nails marking both ends of the calibration course are 10' southwest of the northeast edge of Pacer Trail

MEASURED BY: JOE RIES'S
(937) 361-6925
Y0JOE26@YAHOO.COM