



*Road Running Technical Council  
USA Track & Field*  
**Measurement Certificate**



Name of the course 2022 Nantucket North Beach Street 1000 ft. Calibration Course Distance 1000 FT  
Location (state) MA (city) Nantucket  
Type of course: Calibration  
Measuring Methods: Steel Tape  
Measured By Bob Kennedy - 18 Riverview Road - Durham, NH 03824 - (508) 577-4105 - osprey02554@yahoo.com  
Race Contact N/A  
Date(s) when course measured: April 5, 2022  
Number of measurements of entire course: 2 Course Configuration: point to point  
Elevation (meters above sea level) Start 0.30 Finish 0.30 Lowest N/A Highest N/A  
Straight line distance between start and finish 1000 FT Drop 0.00 m/km Separation 100.00 %  
Type of surface: Paved 100 % Dirt 0 % Gravel 0 % Grass 0 % Track 0 %  
Effective date of certification: April 11, 2022 Certification code: MA22002BK

Note to Race Director: Use this Certification Code  
in all public announcements relating to your race.

## *Be It Officially Noted That*

Based on examination of data provided by the above named measurer, the course described above and in the map attached is hereby certified as reasonably accurate in measurement according to the standards adopted by the Road Running Technical Council. If any changes are made to the course, this certification becomes void, and the course must then be recertified.

**Verification of Course ---** In the event a National Open Record is set on the course, or at the discretion of USA Track & Field, a verification measurement may be required to be performed by a member of the Road Running Technical Council. If such a remeasurement shows the course to be short, then all pending records will be rejected and the course certification will be cancelled.

***This certification expires on December 31 of the year:*** **2032**

**AS NATIONALLY CERTIFIED BY:**

Date: April 14, 2022

Bob Kennedy - USATF/RRTC Certifier - 18 Riverview Road, Durham NH 03824  
(508) 577-4105 - osprey02554@yahoo.com

# 2022 Nantucket North Beach Street 1000 ft. Calibration Course (304.8 m) Nantucket, Massachusetts



**Note:** This course was measured using the Shortest Possible Route (SPR) between 2 points on a straight road.

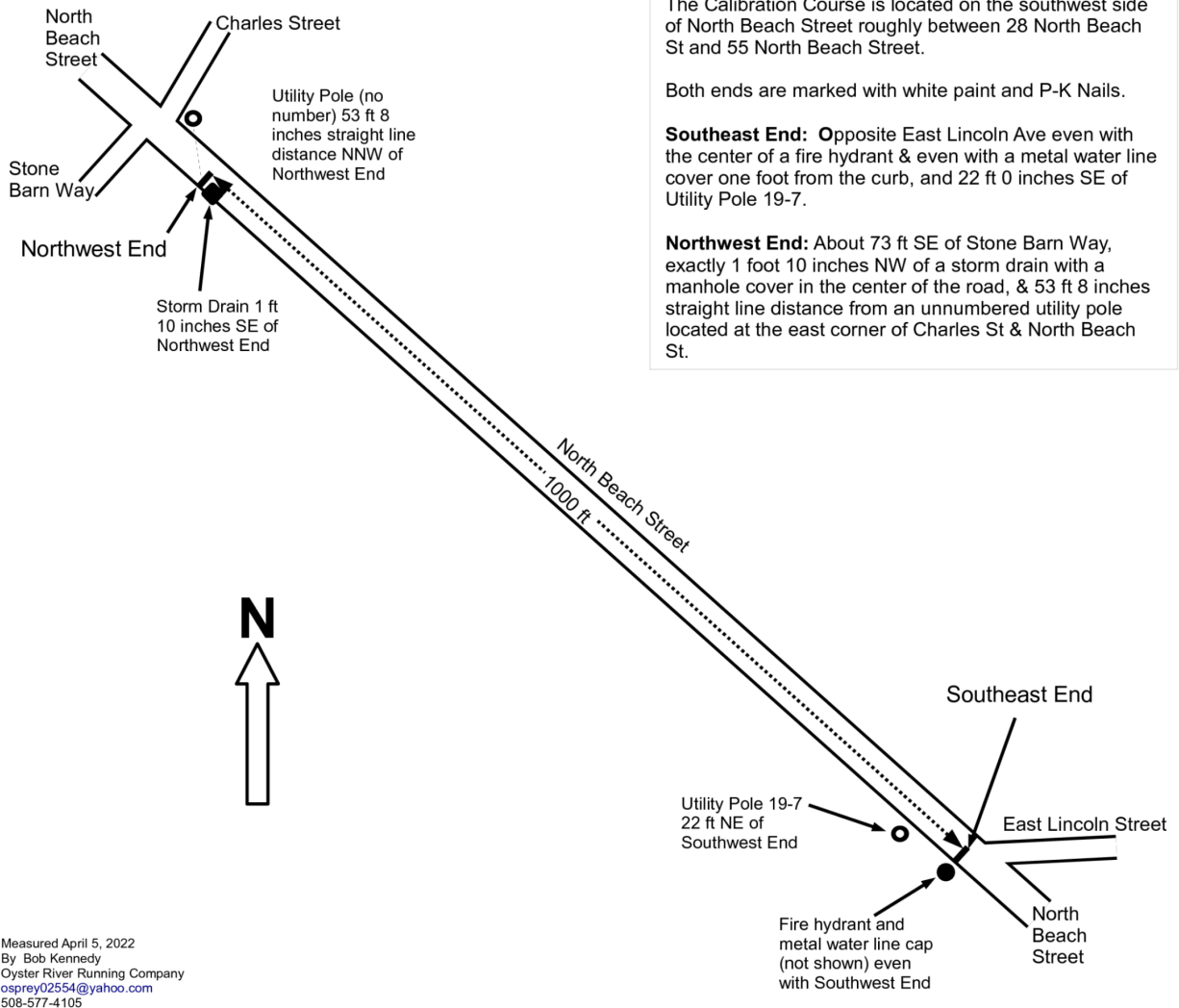

Measured April 5, 2022  
By Bob Kennedy  
Oyster River Running Company  
osprey02554@yahoo.com  
508-577-4105