



Road Running Technical Council
USA Track & Field
Measurement Certificate



Name of the course Harry Wright Lake Road 1000 foot Calibration Course Distance 304.8 M
Location (state) NJ (city) Manchester Twp
Type of course: Calibration
Measuring Methods: Steel Tape
Measured By Jane Parks - 8606 Wiese Rd - Brecksville, OH 44141 - (973) 349-0033 - janehp3+ctcert@gmail.com
Race Contact N/A
Date(s) when course measured: October 28, 2019
Number of measurements of entire course: 2 Course Configuration: point to point
Elevation (meters above sea level) Start 11.58 Finish 11.58 Lowest N/A Highest N/A
Straight line distance between start and finish 304.8 M Drop 0.00 m/km Separation 100.00 %
Type of surface: Paved 100 % Dirt 0 % Gravel 0 % Grass 0 % Track 0 %
Effective date of certification: November 1, 2019 Certification code: NJ19015JHP

Note to Race Director: Use this Certification Code
in all public announcements relating to your race.

Be It Officially Noted That

Based on examination of data provided by the above named measurer, the course described above and in the map attached is hereby certified as reasonably accurate in measurement according to the standards adopted by the Road Running Technical Council. If any changes are made to the course, this certification becomes void, and the course must then be recertified.

Verification of Course --- In the event a National Open Record is set on the course, or at the discretion of USA Track & Field, a verification measurement may be required to be performed by a member of the Road Running Technical Council. If such a remeasurement shows the course to be short, then all pending records will be rejected and the course certification will be cancelled.

This certification expires on December 31 of the year: **2029**

AS NATIONALLY CERTIFIED BY:

Date: November 1, 2019

Jane Parks - USATF/RRTC Certifier - 8606 Wiese Rd, Brecksville OH 44141
(973) 349-0033 - janehp3+ctcert@gmail.com

Harry Wright Lake Road 1000 foot calibration course
Manchester Township, NJ 08759



Eastern end: On Harry Wright Lake Park Road, marked by a pk nail in the yellow centerline, 6.39 meters southwest of the 10 mph sign on the north side of the road at the first parking lot entrance.
Western end: On Harry Wright Lake Park Road, marked by a pk nail in the yellow centerline, 20.62 meters northeast of the 10 mile per hour sign on the south side of the road at the western end of the road.

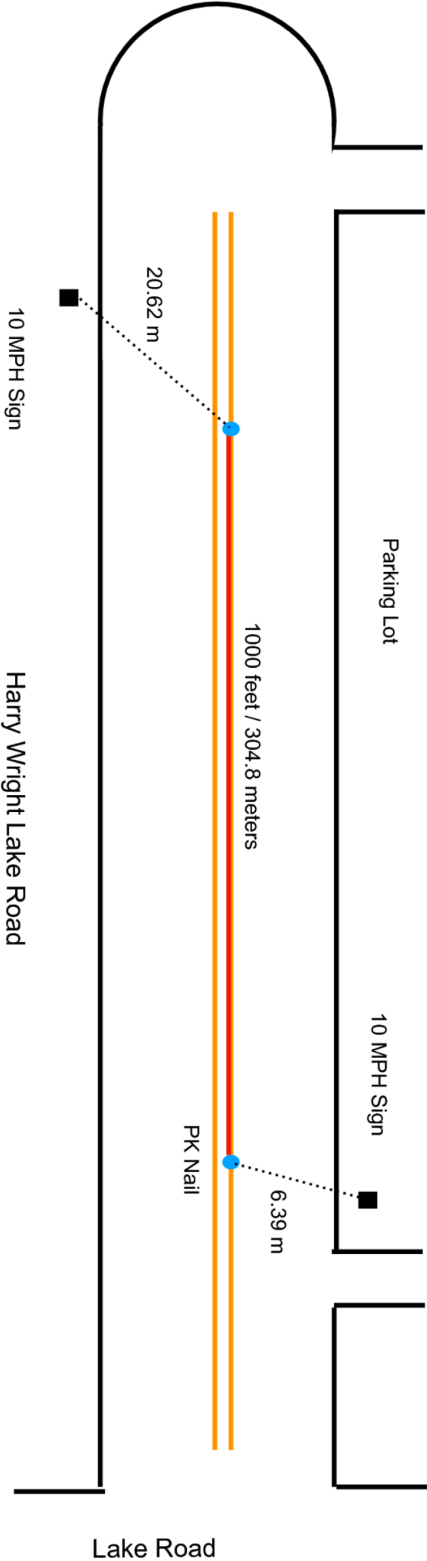

Measured by Gary Westerfield (IAAF B)
and Jane Parks (IAAF A)
October 28, 2019
janehp3@gmail.com