



**Road Running Technical Council
USA Track & Field
Measurement Certificate**



Name of the course River Center 1000 Foot Calibration Distance 1000 FT
Location (state) CA (city) Fresno
Type of course: Calibration
Measuring Methods: Steel Tape
Measured By Andrew Arzate - 2651 DENNIS AVE - Clovis, CA 93611 - (559) 286-5347 - andrew.arzate@gmail.com
Race Contact N/A
Date(s) when course measured: July 19, 2022
Number of measurements of entire course: 2 Course Configuration: point to point
Elevation (meters above sea level) Start 91.44 Finish 91.44 Lowest N/A Highest N/A
Straight line distance between start and finish 1000 FT Drop 0.00 m/km Separation 100.00 %
Type of surface: Paved 100 % Dirt 0 % Gravel 0 % Grass 0 % Track 0 %
Effective date of certification: August 31, 2022 Certification code: CA22022TEB

Note to Race Director: Use this Certification Code
in all public announcements relating to your race.

Be It Officially Noted That

Based on examination of data provided by the above named measurer, the course described above and in the map attached is hereby certified as reasonably accurate in measurement according to the standards adopted by the Road Running Technical Council. If any changes are made to the course, this certification becomes void, and the course must then be recertified.

Verification of Course --- In the event a National Open Record is set on the course, or at the discretion of USA Track & Field, a verification measurement may be required to be performed by a member of the Road Running Technical Council. If such a remeasurement shows the course to be short, then all pending records will be rejected and the course certification will be cancelled.

This certification expires on December 31 of the year: **2032**

AS NATIONALLY CERTIFIED BY:

Date: September 17, 2022

Todd E. Byers - USATF/RRTC Certifier - 16835 Algonquin St #325, Huntington Beach CA 92649
(562) 665-1485 - byers_todd2@hotmail.com

River Center 1000 Foot Calibration Course

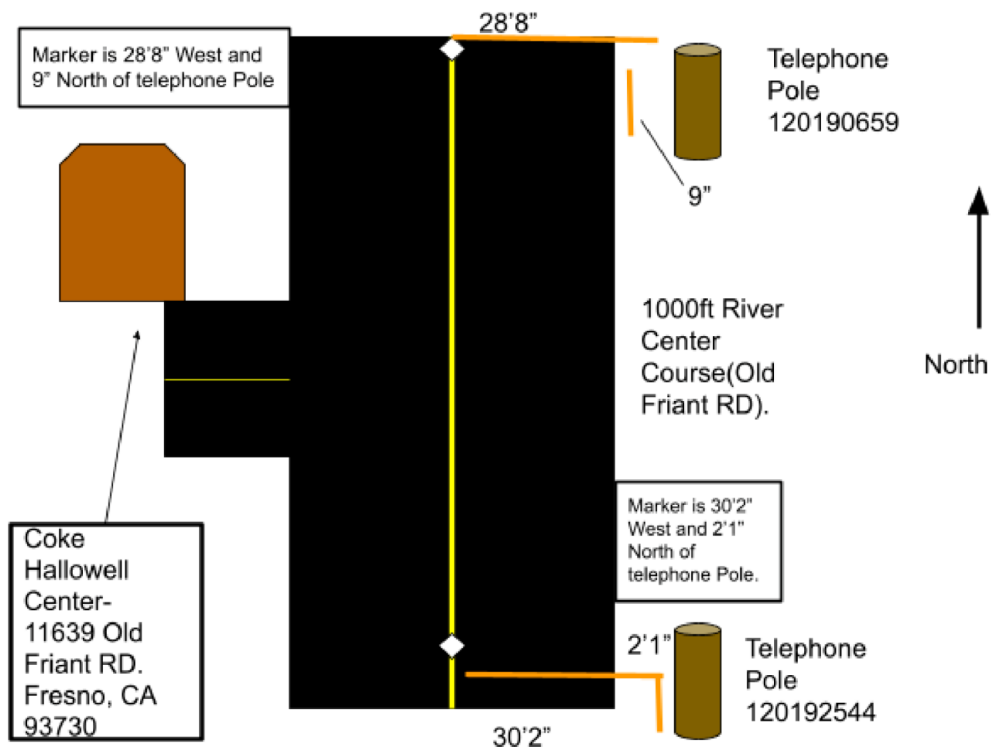

-Measured In the center of the road hugging the West Side of the East Side of the Double Line of Paint.

-Start and End Points are marked with Permanent Survey Markers(Nails w/ washers in pavement) Along with Florescent Pink Paint for easy visibility.



USATF Certificate

CA22022TEB
Effective: 08/31/2022
Through: 12/31/2032

Map by Andrew Arzate

Lead Tape Measurer- Andrew Arzate(talleytiming@yahoo.com)
Rear Tape- Mike Herman
Helper- Nancy Talley

*Note- MAP NOT TO SCALE!