



**Road Running Technical Council  
USA Track & Field  
Measurement Certificate**



Name of the course WDW Marathon Weekend Marathon 2024 Distance 42.195 km  
Location (state) FL (city) Lake Buena Vista  
Type of course: Road Race  
Measuring Methods: Bicycle  
Measured By Jonathan Branson - 50 Lakeview Reserve Blvd - Winter Garden, FL 34787 - (321) 312-0787 - jbranson@acroi  
Race Contact Jon Hughes - 1013 Montana Street Orlando, FL 32803 - (407) 896-1160 - info@trackshack.com  
Date(s) when course measured: 11/20/2023, 11/21/2023  
Number of measurements of entire course: 2 Course Configuration: partial loop  
Elevation (meters above sea level) Start 29.87 Finish 31.70 Lowest 25.3 Highest 35.97  
Straight line distance between start and finish 464.82 m Drop -0.04 m/km Separation 1.10 %  
Type of surface: Paved 100 % Dirt 0 % Gravel 0 % Grass 0 % Track 0 %  
Effective date of certification: December 14, 2023 Certification code: FL23055JK

Note to Race Director: Use this Certification Code  
in all public announcements relating to your race.

## ***Be It Officially Noted That***

Based on examination of data provided by the above named measurer, the course described above and in the map attached is hereby certified as reasonably accurate in measurement according to the standards adopted by the Road Running Technical Council. If any changes are made to the course, this certification becomes void, and the course must then be recertified.

**Verification of Course ---** In the event a National Open Record is set on the course, or at the discretion of USA Track & Field, a verification measurement may be required to be performed by a member of the Road Running Technical Council. If such a remeasurement shows the course to be short, then all pending records will be rejected and the course certification will be cancelled.

***This certification expires on December 31 of the year:*** **2033**

**AS NATIONALLY CERTIFIED BY:**

Date: December 18, 2023

Justin Kuo - USATF/RRTC Certifier - 39 Oakland Rd, Brookline MA 02445  
(617) 487-4463 - jkuo+certifier@usatfne.org

# WDW MARATHON WEEKEND MARATHON 2024

LAKE BUENA VISTA, FLORIDA  
MARATHON RACE DISTANCE

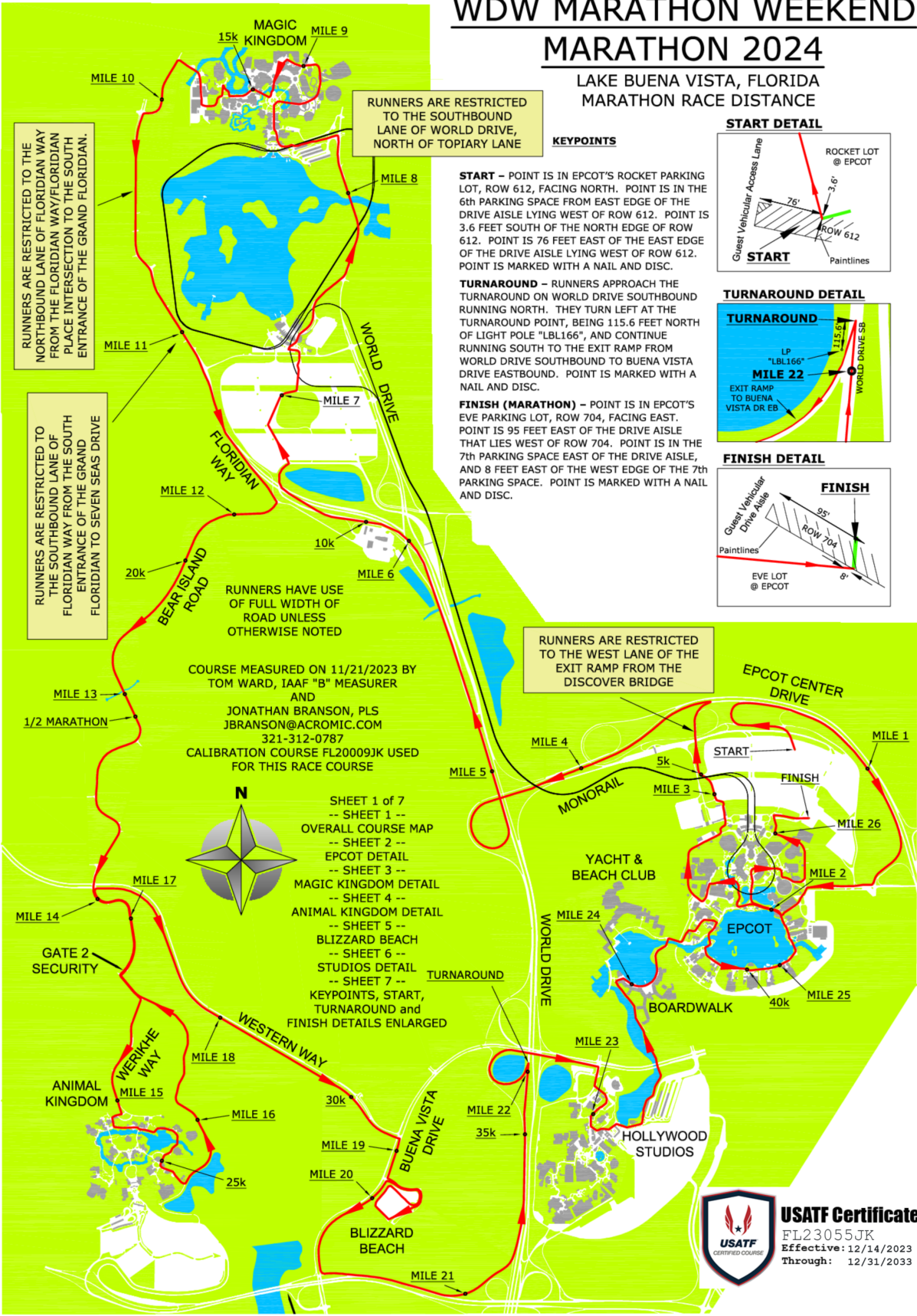

WDW MARATHON WEEKEND  
MARATHON 2024

LAKE BUENA VISTA, FLORIDA  
MARATHON RACE DISTANCE

COURSE MEASURED  
ON 11/21/2023 BY  
TOM WARD,  
IAAF "B" MEASURER

AND  
JONATHAN BRANSON, PLS  
JBRANSON@ACROMIC.COM  
321-312-0787

CALIBRATION COURSE  
FL20009JK USED FOR  
THIS RACE COURSE

EPCOT DETAIL



WDW MARATHON WEEKEND  
MARATHON 2024

LAKE BUENA VISTA, FLORIDA  
MARATHON RACE DISTANCE

COURSE MEASURED ON 11/21/2023 BY TOM WARD, 1A&F 'B' MEASURER AND JONATHAN BRANSON, PLS JBRANSON@ACKRONIC.COM 321-312-0787 CALIBRATION COURSE FL20009JK USED FOR THIS RACE COURSE

MAGIC KINGDOM DETAIL

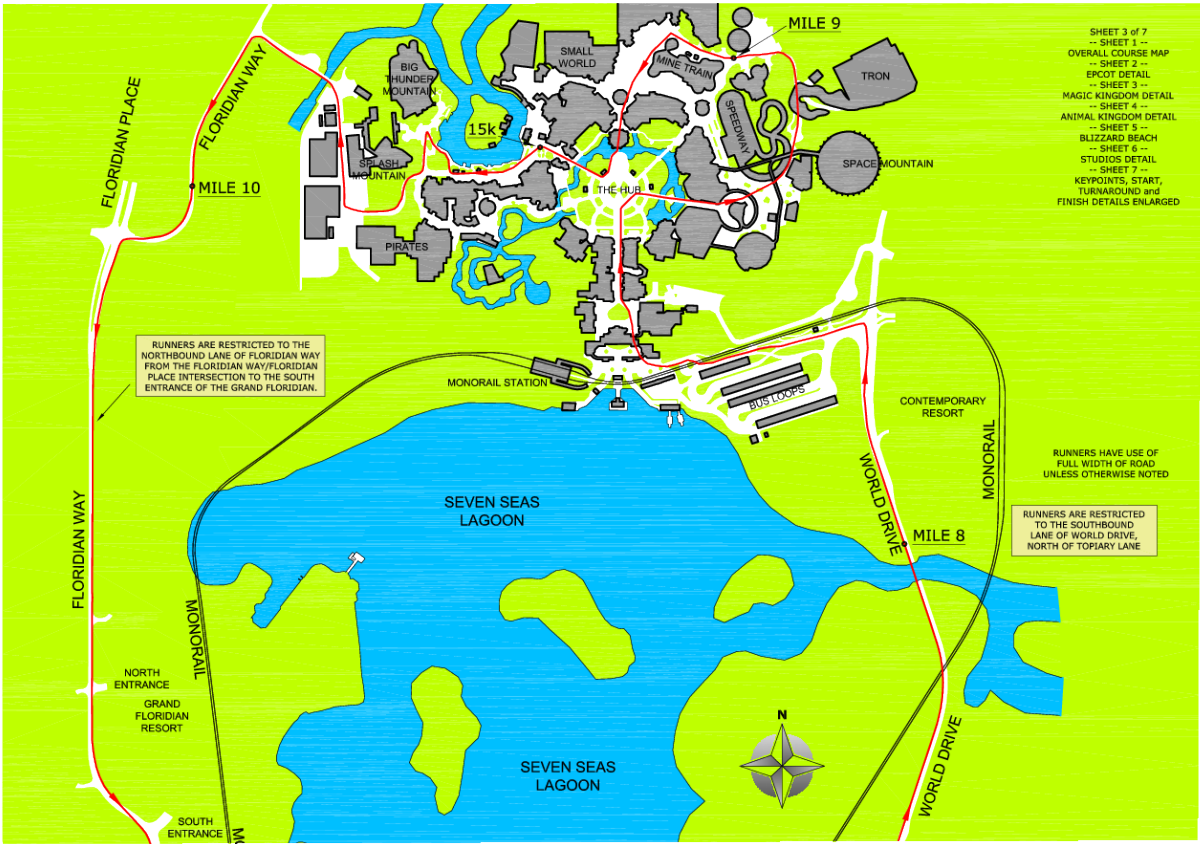



WDW MARATHON WEEKEND  
MARATHON 2024

LAKE BUENA VISTA, FLORIDA  
MARATHON RACE DISTANCE    ANIMAL KINGDOM DETAIL

COURSE MEASURED  
ON 11/21/2023 BY  
TOM WARD,  
IAAF "B" MEASURER

AND  
JONATHAN BRANSON, PLS  
JBRANSON@ACROMIC.COM  
321-312-0787

CALIBRATION COURSE  
FL20009JK USED FOR  
THIS RACE COURSE

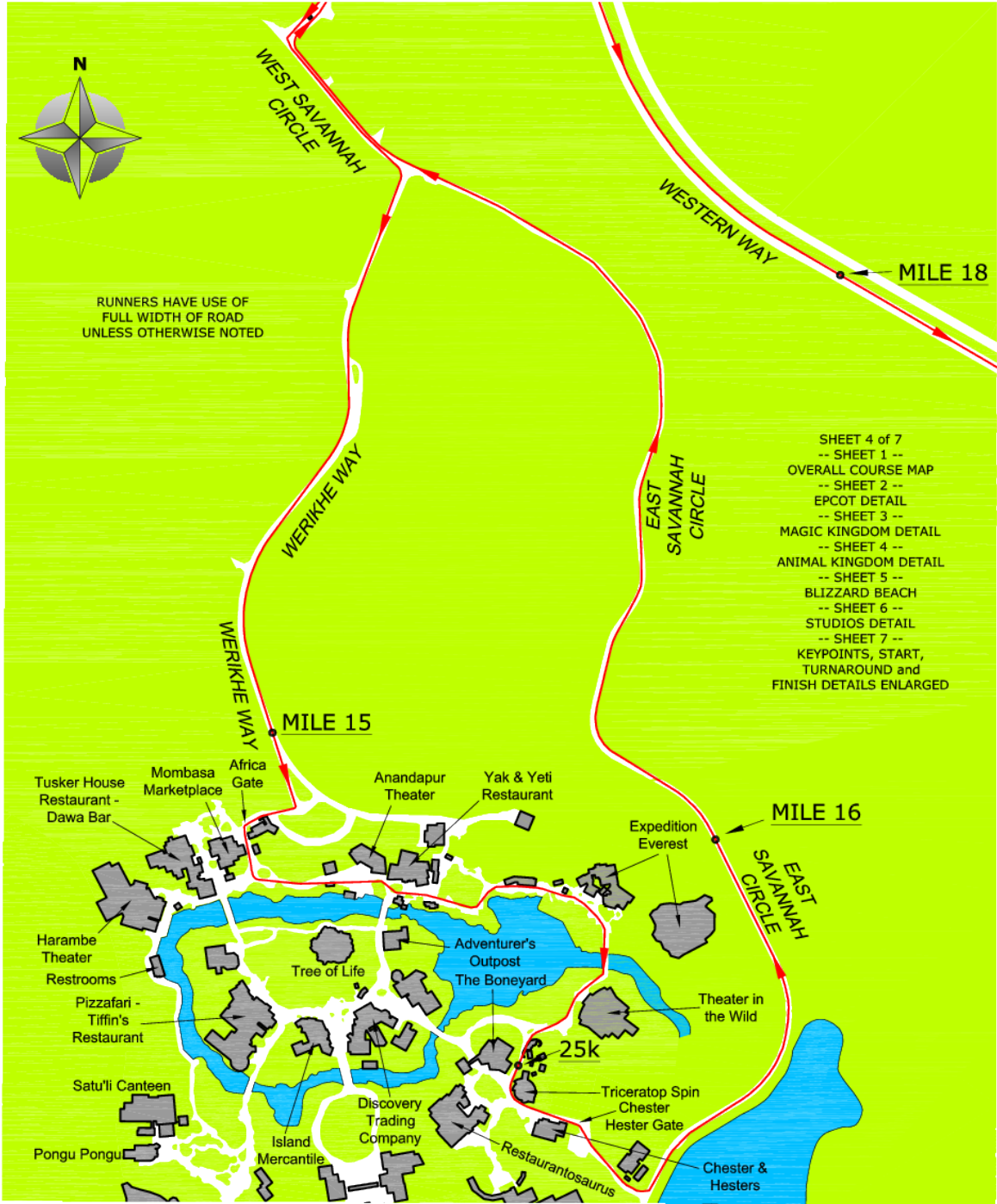

WDW MARATHON WEEKEND  
MARATHON 2024

LAKE BUENA VISTA, FLORIDA  
MARATHON RACE DISTANCE

COURSE MEASURED  
ON 11/21/2023 BY  
TOM WARD,  
IAAF "B" MEASURER

AND  
JONATHAN BRANSON, PLS  
JBRANSON@ACROMIC.COM  
321-312-0787

CALIBRATION COURSE  
FL20009JK USED FOR  
THIS RACE COURSE

STUDIOS DETAIL

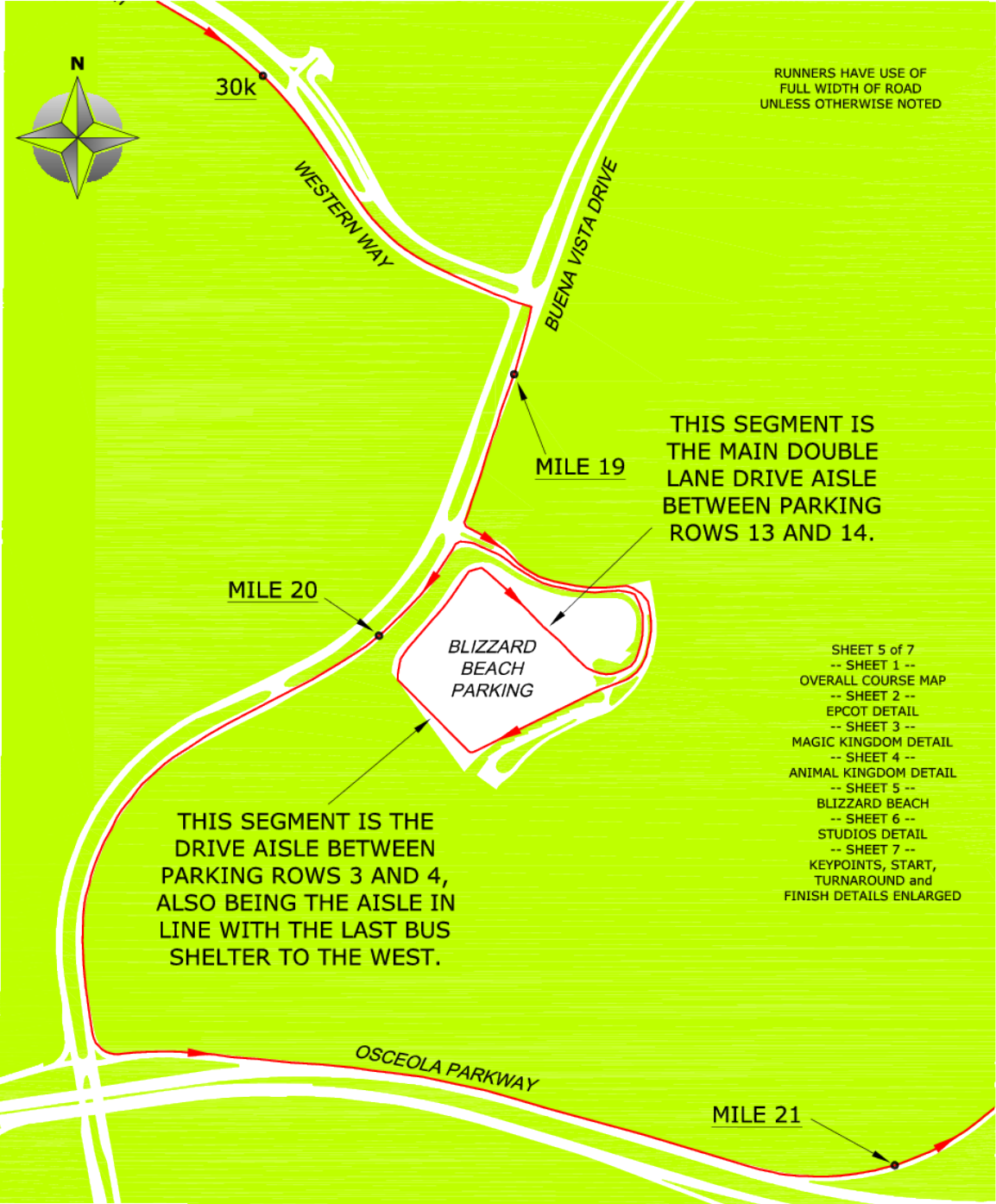

## STUDIOS DETAIL

CALIBRATION COURSE  
FL20009JK USED FOR  
THIS RACE COURSE





# WDW MARATHON WEEKEND MARATHON

## 2024

LAKE BUENA VISTA, FLORIDA  
MARATHON RACE DISTANCE

### START DETAIL

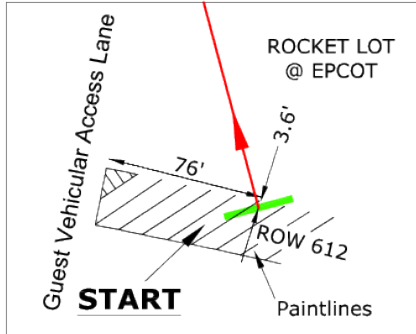

### TURNAROUND DETAIL

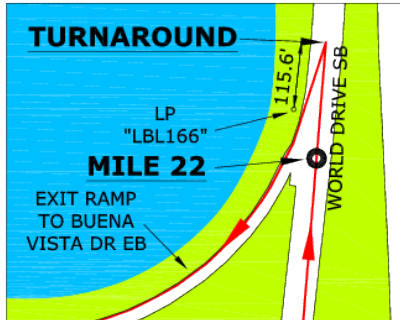

### FINISH DETAIL

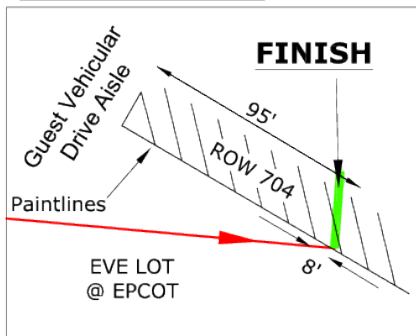

COURSE MEASURED ON 11/21/2023 BY  
TOM WARD, IAAF "B" MEASURER  
AND  
JONATHAN BRANSON, PLS  
JBRANSON@ACROMIC.COM  
321-312-0787  
CALIBRATION COURSE FL20009JK USED  
FOR THIS RACE COURSE

### KEYPOINTS

START - POINT IS IN EPCOT'S ROCKET PARKING LOT, ROW 612, FACING NORTH. POINT IS IN THE 6th PARKING SPACE FROM EAST EDGE OF THE DRIVE AISLE LYING WEST OF ROW 612. POINT IS 3.6 FEET SOUTH OF THE NORTH EDGE OF ROW 612. POINT IS 76 FEET EAST OF THE EAST EDGE OF THE DRIVE AISLE LYING WEST OF ROW 612. POINT IS MARKED WITH A NAIL AND DISC.

1 MILE - IS ON WEST SIDE OF EPCOT CENTER DRIVE EASTBOUND, FACING SOUTH. POINT IS 105 FEET SOUTH OF (AFTER) LIGHT POLE "ECD73". POINT IS MARKED WITH A NAIL AND DISC.

2 MILE - POINT IS ON SOUTH SIDE OF BRIDGE BETWEEN MEXICO AND ODYSSEY BRIDGE, FACING WEST. POINT IS 19.6 FEET WEST OF (AFTER) CENTER OF ARCH/SIGN FOR "LA CANTINA" RESTAURANT. POINT IS NOT PERMANENTLY MARKED.

3 MILE - POINT IS ON WEST SIDE OF EPCOT'S "HEI HEI" PARKING LOT, FACING NORTH. POINT IS 8.6 FEET SOUTH OF (BEFORE) CENTERLINE OF EAST/WEST ROW 104. POINT IS MARKED WITH A NAIL AND DISC.

5k - POINT IS IN CENTER OF EPCOT EXIT, SOUTH OF THE DISCOVER BRIDGE, FACING NORTH. POINT IS 94 FEET NORTH OF (AFTER) CENTER OF MONORAIL BEAM. POINT IS MARKED WITH A NAIL AND DISC.

4 MILE - POINT IS ON THE NORTH SIDE OF EPCOT CENTER DRIVE, FACING WEST. POINT IS 112.2 FEET WEST OF (AFTER) LIGHT POLE "ECD139". POINT IS MARKED WITH A NAIL AND DISC.

5 MILE - POINT IS ON THE WEST SIDE OF WORLD DRIVE SOUTHBOUND, FACING NORTH. POINT IS 141 FEET SOUTH OF (BEFORE) LIGHT POLE "WDS6" AND 79 FEET SOUTH OF (BEFORE) DIGITAL OVERHEAD SIGN. POINT IS MARKED WITH A NAIL AND DISC.

6 MILE - POINT IS ON WEST SIDE OF WORLD DRIVE SOUTHBOUND, FACING NORTH. POINT IS 84.2 FEET SOUTH OF (BEFORE) SOUTH EDGE OF OVERPASS. POINT IS MARKED WITH A NAIL AND DISC.

10k - POINT IS ON SOUTH SIDE OF WORLD DRIVE SOUTHBOUND, FACING WEST. POINT IS 123 FEET EAST OF (BEFORE) THE WEST EDGE OF CONCRETE AND METAL BARRIER TO THE NORTH OF CAR CARE. POINT IS MARKED WITH A NAIL AND DISC.

7 MILE - POINT IS ON EAST SIDE OF MAGIC KINGDOM'S "PETER PAN" PARKING LOT, FACING NORTH. POINT IS 20.6 FEET NORTH OF (AFTER) NORTH LINE OF ROW 211. POINT IS MARKED WITH A NAIL AND DISC.

8 MILE - POINT IS ON WEST SIDE OF WORLD DRIVE SOUTHBOUND, FACING NORTH. POINT IS 118 FEET NORTH OF (AFTER) NORTH SIDE OF WATER BRIDGE. POINT IS MARKED WITH A NAIL AND DISC.

9 MILE - POINT IS ON THE NORTH SIDE OF THE PATH IN MAGIC KINGDOM'S STORYBOOK CIRCUS, FACING WEST. POINT IS 6 FEET WEST OF (AFTER) OVERHEAD SIGN FOR "STORYBOOK CIRCUS", POINT IS ON THE SOUTH OF "BIG TOP SOUVENIRS" STORE. POINT IS NOT PERMANENTLY MARKED.

15k - POINT IS IN MAGIC KINGDOM'S LIBERTY SQUARE ON THE SOUTH SIDE OF A PATH, FACING WEST. POINT IS 14.2 FEET WEST OF (AFTER) CENTER OF PATH LEADING TO LIBERTY BELL. POINT IS NOT PERMANENTLY MARKED.

10 MILE - POINT IS ON THE EAST SIDE OF FLORIDIAN WAY, FACING SOUTH. POINT IS 138 FEET NORTH OF (BEFORE) "14 192 LEFT" SIGN. POINT IS MARKED WITH A NAIL AND DISC.

11 MILE - POINT IS ON THE WEST SIDE OF FLORIDIAN WAY, FACING SOUTH. POINT IS 64 FEET NORTH OF (BEFORE) SIGN SAYING "GOLF COURSES SHADES OF GREEN NEXT RIGHT". POINT IS MARKED WITH A NAIL AND DISC.

12 MILE - POINT IS IN CENTER OF BEAR ISLAND ROAD, FACING WEST. POINT IS 16.4 FEET EAST OF (BEFORE) FIBER OPTIC VAULT ON NORTH SIDE OF ROAD. POINT IS MARKED WITH A NAIL AND DISC.

20k - POINT IS ON WEST SIDE OF BEAR ISLAND ROAD, FACING SOUTH. NOTHING PERMANENT IN AREA, POINT IS ADJACENT TO FLAGGED PALM TREE ON WEST SIDE OF ROAD. POINT IS MARKED WITH A NAIL AND DISC.

13 MILE - POINT IS IN CENTER OF BEAR ISLAND ROAD, FACING SOUTH. POINT IS 64.6 FEET SOUTH OF (AFTER) SOUTH END OF BRIDGE CONCRETE/METAL GUARD RAIL MARKED "HS20" IN CONCRETE ON EAST BRIDGE CONCRETE. POINT IS MARKED WITH A NAIL AND DISC.

HALF-MARATHON - POINT IS ON WEST SIDE OF BEAR ISLAND ROAD, FACING SOUTH. POINT IS 87.6 FEET NORTH OF (BEFORE) SIGN SAYING "REEDY CREEK TRANSPORTATION MAINTENANCE AND NURSERY". POINT IS MARKED WITH A NAIL AND DISC.

14 MILE - POINT IS ON WEST SIDE OF BEAR ISLAND ROAD, FACING SOUTH. POINT IS 25.6 FEET SOUTH OF (AFTER) WEST EDGE OF 1ST GATE OF TREE FARM AFTER CROSSING WESTERN WAY. GATE ALSO HAS A STOP SIGN AT DIRT ROAD ENTRANCE TO BEAR ISLAND ROAD. POINT IS MARKED WITH A NAIL AND DISC.

15 MILE - POINT IS ON WEST SIDE OF WERIKHE WAY, FACING SOUTH. POINT IS 151.2 FEET NORTH OF (BEFORE) SIGN SAYING "ASIA VENUES STRAIGHT TURNAROUND RIGHT" AT SPLIT OF SPINE ROAD. POINT IS MARKED WITH A NAIL AND DISC.

25k - POINT IS ON THE EAST SIDE OF THE PATH ON THE WEST SIDE OF DINORAMA IN DINOLAND, FACING SOUTH. POINT IS 94.4 FEET SOUTH OF (AFTER) RIGHT FRONT FOOT OF CEMENTOSAURUS. POINT IS NOT PERMANENTLY MARKED.

16 MILE - POINT IS IN THE CENTER IF SAVANNAH CIRCLE, FACING NORTH. POINT IS 115. 2 FEET NORTH OF (AFTER) ELECTRIC BOX P660 ON EAST SIDE OF ROAD. POINT IS MARKED WITH A NAIL AND DISC.

17 MILE - POINT IS IN CENTER OF BEAR ISLAND ROAD, FACING NORTH. POINT IS 88.2 FEET NORTH OF (AFTER) CENTER OF ROLLING GATE TO TREE FARM WITH LIGHT POLE AND STOP SIGN AT SOUTH SIDE OF GATE ON TREE FARM SIDE. POINT IS MARKED WITH A NAIL AND DISC.

18 MILE - POINT IS ON SOUTH SIDE OF WESTERN WAY EASTBOUND, FACING EAST. POINT IS 147 FEET WEST OF (BEFORE) LIGHT POLE "WW75" IN THE MEDIAN. POINT IS MARKED WITH A NAIL AND DISC.

30k - POINT IS ON SOUTH SIDE OF WESTERN WAY EASTBOUND, FACING EAST. POINT IS 111 FEET WEST OF (BEFORE) LIGHT POLE "WW105". POINT IS MARKED WITH A NAIL AND DISC.

19 MILE - POINT IS ON WEST SIDE OF BUENA VISTA DRIVE EASTBOUND, SOUTH OF WESTERN WAY INTERSECTION, FACING SOUTH. POINT IS 24.4 FEET NORTH OF (BEFORE) LIGHT POLE "BVE310". POINT IS MARKED WITH A NAIL AND DISC.

20 MILE - POINT IS ON SOUTH SIDE OF BUENA VISTA DRIVE EASTBOUND, FACING WEST. POINT IS 38.8 FEET WEST OF (AFTER) LIGHT POLE "BVE320". POINT IS MARKED WITH A NAIL AND DISC.

21 MILE - POINT IS ON NORTH SIDE OF THE EXIT RAMP FROM WORLD DRIVE SOUTHBOUND TO OSCEOLA PARKWAY WESTBOUND, FACING EAST. POINT IS 29 FEET WEST OF (BEFORE) LIGHT POLE "WOPR14". POINT IS MARKED WITH A NAIL AND DISC.

35k - POINT IS ON THE WEST SIDE OF WORLD DRIVE SOUTHBOUND, FACING NORTH. POINT IS 18.6 FEET NORTH OF (AFTER) LIGHT POLE "LBR318". POINT IS MARKED WITH A NAIL AND DISC.

22 MILE - POINT IS ON EAST SIDE OF WORLD DRIVE SOUTHBOUND, FACING NORTH. POINT IS 64 FEET SOUTH OF (BEFORE) LIGHT POLE "LBL166". POINT IS MARKED WITH A NAIL AND DISC.

TURNAROUND - RUNNERS APPROACH THE TURNAROUND ON WORLD DRIVE SOUTHBOUND RUNNING NORTH. THEY TURN LEFT AT THE TURNAROUND POINT, BEING 115.6 FEET NORTH OF LIGHT POLE "LBL166", AND CONTINUE RUNNING SOUTH TO THE EXIT RAMP FROM WORLD DRIVE SOUTHBOUND TO BUENA VISTA DRIVE EASTBOUND. POINT IS MARKED WITH A NAIL AND DISC.

23 MILE - POINT IS IN CENTER OF SUNSET BOULEVARD AT HOLLYWOOD STUDIOS, FACING SOUTHWEST. POINT IS 34.4 FEET SOUTHWEST OF (AFTER) CLOCK AT CENTER OF RIDE ENTRANCE TO TOWER OF TERROR. POINT IS NOT PERMANENTLY MARKED.

24 MILE - POINT IS ON NORTH SIDE OF BOARDWALK PATH AT BOARDWALK RESORT, FACING EAST. POINT IS 40.8 FEET EAST OF (AFTER) CENTER OF MAIN ENTRANCE TO BIG RIVER GRILLE & BREWING WORKS. POINT IS NOT PERMANENTLY MARKED.

40k - POINT IS ON NORTH SIDE OF WORLD SHOWCASE IN AMERICA, FACING EAST. POINT IS 76.6 FEET EAST OF (AFTER) CENTER OF WINDOW FOR FUNNEL CAKE KIOSK. POINT IS NOT PERMANENTLY MARKED.

25 MILE - POINT IS ON NORTH SIDE OF WORLD SHOWCASE PATH IN GERMANY, FACING EAST. POINT IS 14.0 FEET EAST OF (AFTER) SIGN SAYING "ROMANTIC ROAD" AT GERMANY RESTROOMS. POINT IS NOT PERMANENTLY MARKED.

26 MILE - POINT IS ON NORTH SIDE OF AVENUE OF THE STARS, AT THE INTERSECTION WITH THE ROAD LEADING TO KENNEL GATE, FACING NORTHWEST. POINT IS 54.0 FEET WEST OF (AFTER) PURPLE RECLAIMED WATER BACKFLOW PREVENTOR ON NORTH SIDE OF AVENUE OF THE STARS. POINT IS MARKED WITH A NAIL AND DISC.

FINISH (MARATHON) - POINT IS IN EPCOT'S EVE PARKING LOT, ROW 704, FACING EAST. POINT IS 95 FEET EAST OF THE DRIVE AISLE THAT LIES WEST OF ROW 704. POINT IS IN THE 7th PARKING SPACE EAST OF THE DRIVE AISLE, AND 8 FEET EAST OF THE WEST EDGE OF THE 7th PARKING SPACE. POINT IS MARKED WITH A NAIL AND DISC.