

UA Campus Drive

Tuscaloosa, AL

300 m Calibration Course

Both ends are marked with a pk nail and washer.
Course runs parallel to curb within bike lane.

USATF Certificate AL14011JD

Effective 02/18/2014 to 12/31/2024

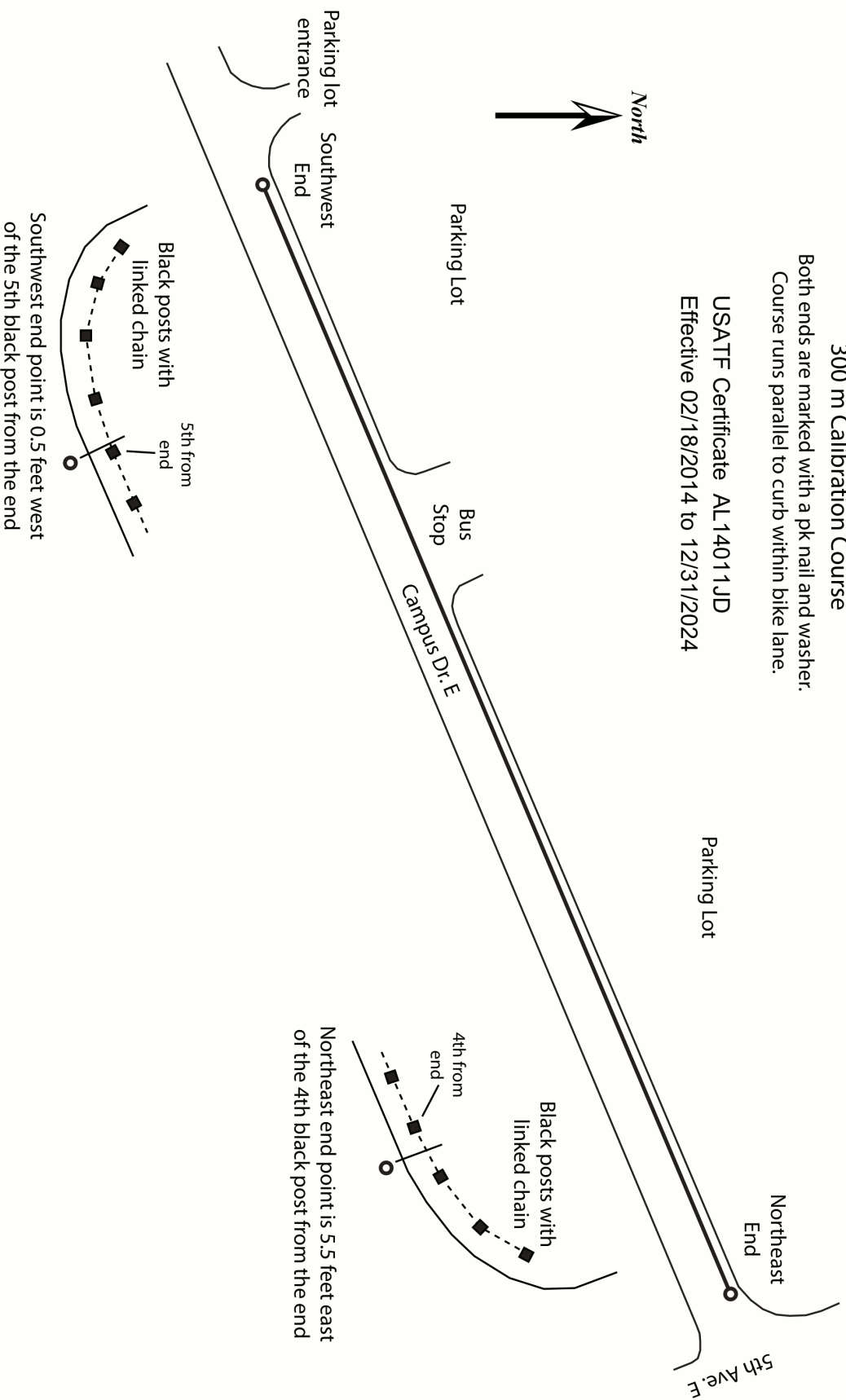

Locational information is given to find the endpoints only, not to replace lost endpoints. Should an endpoint be lost to paving or other cause, the course needs to be remeasured.



Road Running Technical Council
USA Track & Field
Measurement Certificate



Name of the course UA Campus Drive Distance 300 m
 Location (state) Alabama (city) Tuscaloosa
 Type of course: road race calibration track Configuration: Point To Point
 Type of surface: paved 100 % dirt _____ % gravel _____ % grass _____ % track _____ %
 Elevation (meters above sea level) Start 71 Finish 71 Highest _____ Lowest _____
 Straight line distance between start & finish 300 m Drop 0 m/km Separation 100 %
 Measured by (name, address, phone & e-mail) Richard Carroll, 6110 Loblolly Ln.
Tuscaloosa, AL 35405, 205-765-4853, runrunrichard@gmail.com
 Race contact (name, address, phone & e-mail) N/A

Measuring Methods: bicycle steel tape electronic distance meter
 Number of measurements of entire course: 2 Date(s) when course measured: Feb. 08, 2014
 Race date: N/A Course certification effective date: Feb. 18, 2014
 Certification code: AL14011JD

Notice to Race Director: Use this Certification Code in *all* public announcements relating to your race.

Be It Officially Noted That

Based on examination of data provided by the above named measurer, the course described above and in the map attached is hereby certified as reasonably accurate in measurement according to the standards adopted by the Road Running Technical Council. If *any* changes are made to the course, this certification becomes void, and the course must then be recertified.

Verification of Course — In the event a National Open Record is set on this course, or at the discretion of USA Track & Field, a verification remeasurement may be required to be performed by a member of the Road Running Technical Council. If such a remeasurement shows the course to be short, then all pending records will be rejected and the course certification will be cancelled.

This certification expires on December 31 in the year **2024**

AS NATIONALLY CERTIFIED BY:

 Date: **Feb. 21, 2014**

John J DeHaye – USATF/RRTC National Certifier
 824 Annlau Avenue, Huntsville, AL 35802, 256-881-9326, jdehaye@comcast.net