

# UA Campus Drive II

## Tuscaloosa, AL

### 300 m Calibration Course

Both ends are marked with a pk nail and washer.

Course runs parallel to curb within bike lane on the south side of the road.

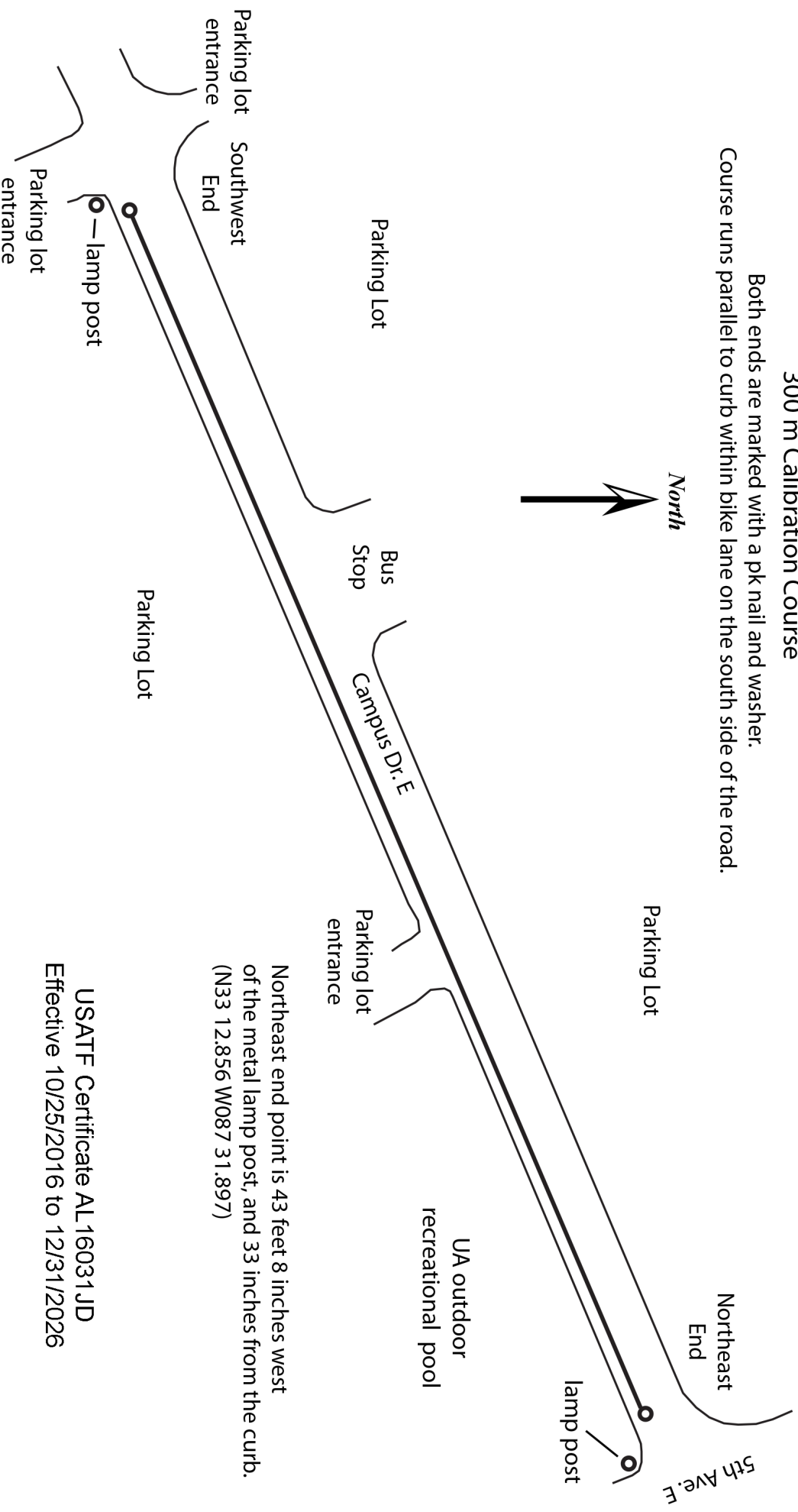

Southwest end point is 13 feet east of the metal lamp post, and 31 inches from the curb. (N33 12.795 W087 32.081)

Northeast end point is 43 feet 8 inches west of the metal lamp post, and 33 inches from the curb. (N33 12.856 W087 31.897)

USATF Certificate AL 16031JD  
Effective 10/25/2016 to 12/31/2026

Locational information is given to find the endpoints only, not to replace lost endpoints. Should an endpoint be lost to paving or other cause, the course will be remeasured.



**Road Running Technical Council**  
**USA Track & Field**  
**Measurement Certificate**



Name of the course UA Campus Drive 11 Distance 300 m  
 Location (state) Alabama (city) Tuscaloosa  
 Type of course: road race  calibration  track  Configuration: Point to Point  
 Type of surface: paved 100 % dirt \_\_\_\_\_ % gravel \_\_\_\_\_ % grass \_\_\_\_\_ % track \_\_\_\_\_ %  
 Elevation (meters above sea level) Start 71 m Finish \_\_\_\_\_ Highest \_\_\_\_\_ Lowest \_\_\_\_\_  
 Straight line distance between start & finish 300 m Drop \_\_\_\_\_ m/km Separation 100 %  
 Measured by (name, address, phone & e-mail) Richard Carroll, 6110 Loblolly Ln.  
Tuscaloosa, AL35405, 205-765-4853, runrunrichard@gmail.com  
 Race contact (name, address, phone & e-mail) \_\_\_\_\_

Measuring Methods: bicycle  steel tape  electronic distance meter   
 Number of measurements of entire course: 2 Date(s) when course measured: Oct. 20, 2016  
 Race date: \_\_\_\_\_ Course certification effective date: Oct. 25, 2016  
 Certification code: AL16031JD

Notice to Race Director: Use this Certification Code in **all** public announcements relating to your race.

***Be It Officially Noted That***

Based on examination of data provided by the above named measurer, the course described above and in the map attached is hereby certified as reasonably accurate in measurement according to the standards adopted by the Road Running Technical Council. If **any** changes are made to the course, this certification becomes void, and the course must then be recertified.

**Verification of Course** — In the event a National Open Record is set on this course, or at the discretion of USA Track & Field, a verification remeasurement may be required to be performed by a member of the Road Running Technical Council. If such a remeasurement shows the course to be short, then all pending records will be rejected and the course certification will be cancelled.

***This certification expires on December 31 in the year*** **2026**

**AS NATIONALLY CERTIFIED BY:**

*John J DeHaye*

Date: **Dec. 12, 2016**

Name – USATF/RRTC National Certifier John J DeHaye  
 824 Annlau Ave, Huntsville, AL 35802, 256-881-9326, jdehaye@comcast.net