



Salisbury Park Calibration Course

1,000 Feet
Parker, CO

USATF Certification CO18003MWC
Effective 2.6.18 to 12.31.2018
Map not to scale. No restrictions.

Baseball Diamonds

Concessions Stand

Baseball Diamonds

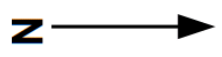
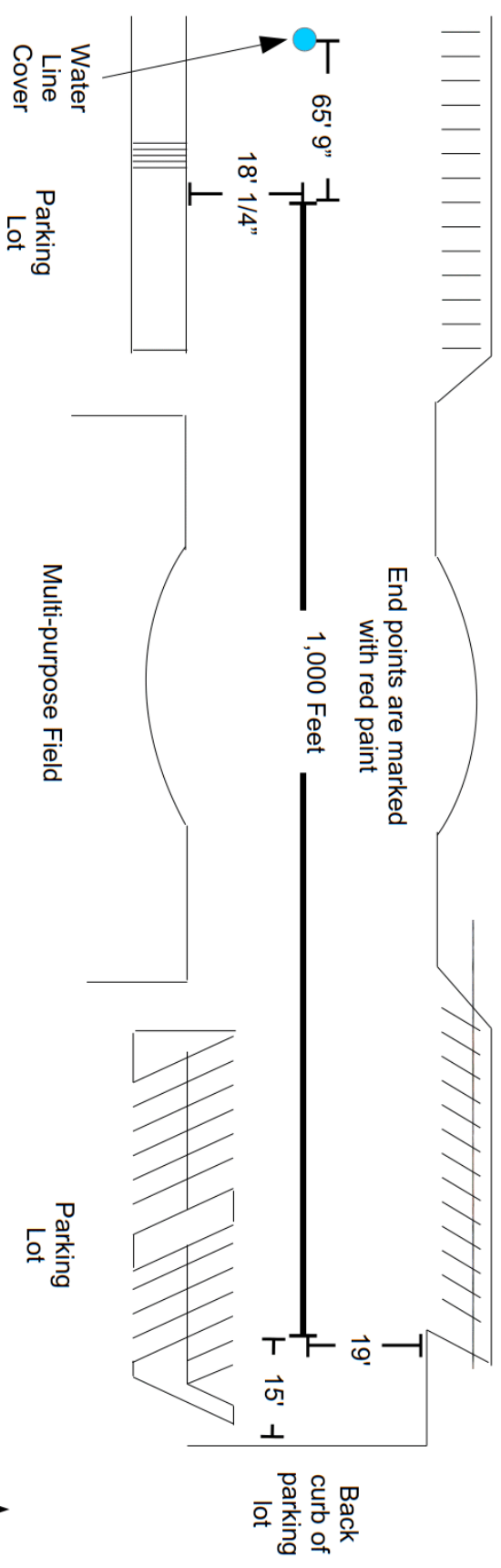



*Road Running Technical Council
USA Track & Field*

Measurement Certificate



Name of the course Salisbury Park Calibration Course Distance 304.8 m
 Location (state) Colorado (city) Parker
 Type of course: road race calibration course
 Measuring method: bicycle steel tape electronic distance meter
 Measured by (name, address, phone & e-mail) Charlie Rhode. 18700 E. Plaza Dr. Parker, CO 80134
Phone: 303-805-6304 / cwrhode@parkeronline.org
 Race contact (name, address, phone & e-mail) Not Applicable

Date(s) when course measured: February 2nd, 2018
 Number of measurements of entire course: 2 Course Configuration: Calibration Course
 Elevation (meters above sea level) Start 1785 m Finish 1785 m Highest 1785 m Lowest 1785 m
 Straight line distance between start & finish 304.706 m Drop 0 m/km Separation 100 %
 Type of surface: paved 100 % dirt _____ % gravel _____ % grass _____ % track _____ %
 Effective date of certification: February 6th, 2018 Certification code: CO18003MWC

Notice to Race Director: Use this Certification Code in **all** public announcements relating to your race.

Be It Officially Noted That

Based on examination of data provided by the above named measurer, the course described above and in the map attached is hereby certified as reasonably accurate in measurement according to the standards adopted by the Road Running Technical Council. If **any** changes are made to the course, this certification becomes void, and the course must then be recertified.

Verification of Course — In the event a National Open Record is set on this course, or at the discretion of USA Track & Field, a verification remeasurement may be required to be performed by a member of the Road Running Technical Council. If such a remeasurement shows the course to be short, then all pending records will be rejected and the course certification will be cancelled.

This certification expires on December 31 in the year **2028**

AS NATIONALLY CERTIFIED BY:

Date: February 6th, 2018

Matthew Compton – USATF/RRTC Certifier
 113 Elmcrest, Murphy TX 75094 / 214-924-4645 / mwc@timeandmeasure.com