

Eastview Christian Church Calibration Course
1000.0587921706 FEET
Normal, IL

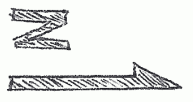

MAP IS NOT TO SCALE

USATF CERTIFICATION NUMBER

IL-14119-JW

Eastview
Christian Church

Normal Community
High School

Notice to Race Director: Use this
Certification Code in all public
announcements relating to your race.

**COURSE CERTIFICATION EFFECTIVE
FROM 31 JULY 2014
THROUGH 31 DECEMBER 2024**

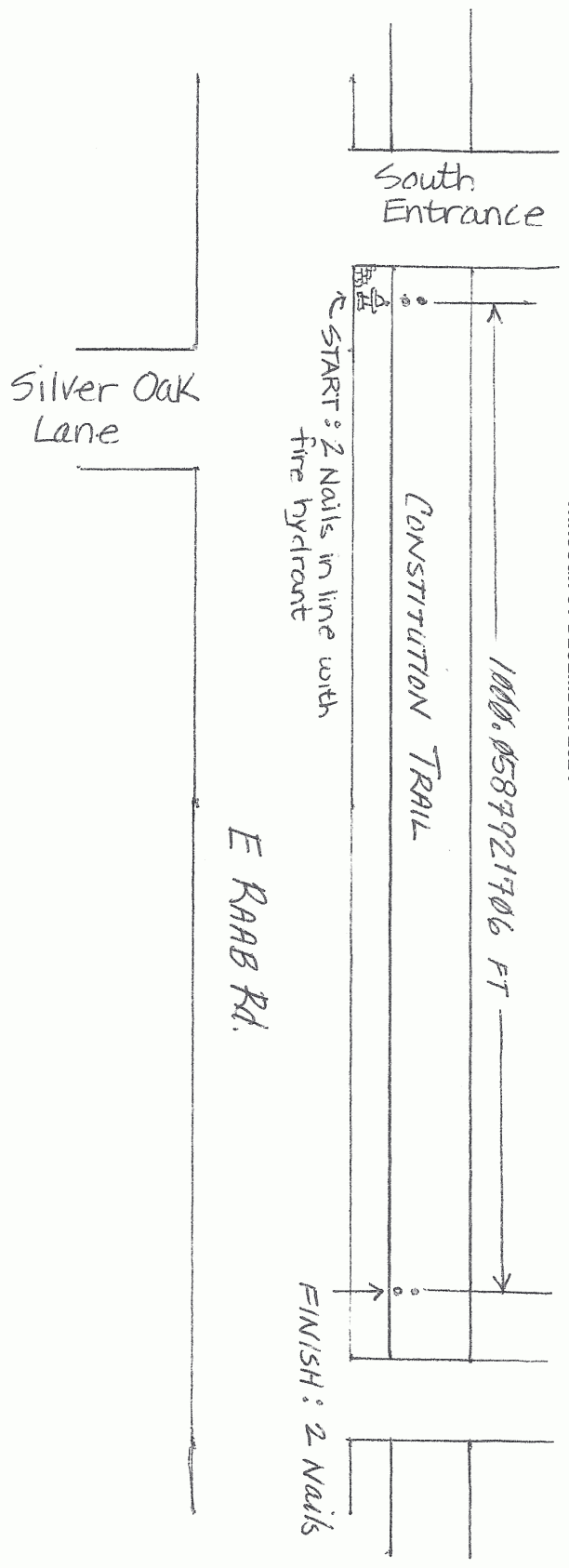



Road Running Technical Council
USA Track & Field
Measurement Certificate



Name of the course Eastview Christian Church Calibration Course Distance 304.818 meters
 Location (state) Illinois (city) Normal
 Type of course: road race calibration track Configuration: Straight Line
 Type of surface: paved 100 % dirt _____ % gravel _____ % grass _____ % track _____ %
 Elevation (meters above sea level) Start 252 Finish 252 Highest 252 Lowest 252
 Straight line distance between start & finish 304.818 meters Drop zero m/km Separation 100 %
 Measured by (name, address, phone & e-mail) Robert Catanese 1630 Frontier Drive
Normal, Illinois 60671-5625 (309) 451-1254 bob.catanese@gmail.com
 Race contact (name, address, phone & e-mail) N/A

Measuring Methods: bicycle steel tape electronic distance meter
 Number of measurements of entire course: 2 Date(s) when course measured: September 21, 2013
 Race date: N/A Course certification effective date: July 31, 2014
 Certification code: IL-14119-JW

Notice to Race Director: Use this Certification Code in **all** public announcements relating to your race.

Be It Officially Noted That

Based on examination of data provided by the above named measurer, the course described above and in the map attached is hereby certified as reasonably accurate in measurement according to the standards adopted by the Road Running Technical Council. If **any** changes are made to the course, this certification becomes void, and the course must then be recertified.

Verification of Course — In the event a National Open Record is set on this course, or at the discretion of USA Track & Field, a verification remeasurement may be required to be performed by a member of the Road Running Technical Council. If such a remeasurement shows the course to be short, then all pending records will be rejected and the course certification will be cancelled.

This certification expires on December 31 in the year **2024**

AS NATIONALLY CERTIFIED BY:

_____ Date: August 14, 2014
 Jay W. Wight • USA TF/RRTC Regional Certifier
 4556 Opal Drive, Hoffman Estates, Illinois 60192-1185 847-359-4598 jaywight@icloud.com