

Park Valley Calibration Course Loves Park, IL

Measured On 7/15/2014

by

Norman Yarger

NLYarger@yahoo.com

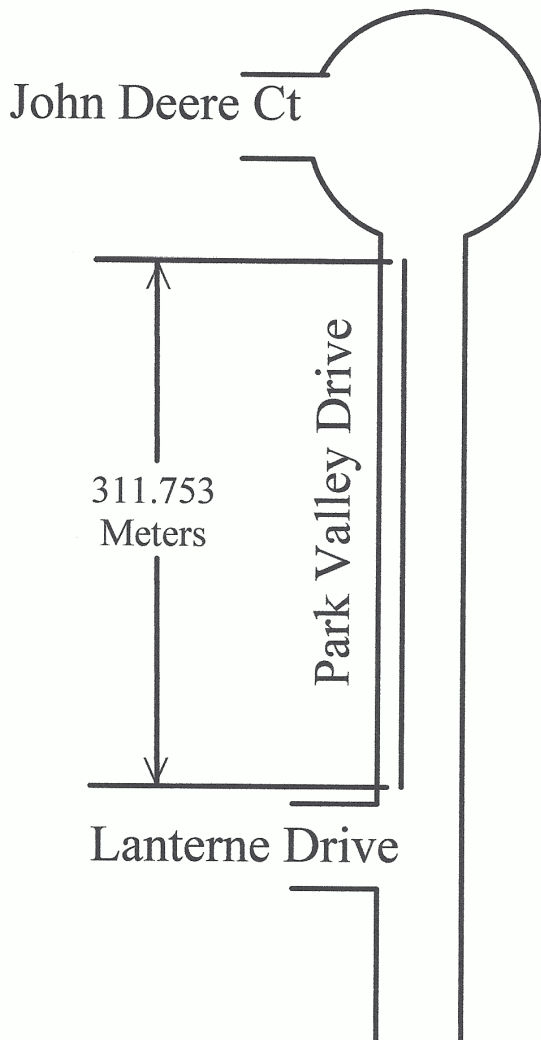

USATF CERTIFICATION NUMBER

IL-14126-JW

Notice to Race Director: Use this
Certification Code in all public
announcements relating to your race.

**COURSE CERTIFICATION EFFECTIVE
FROM 11 AUGUST 2014
THROUGH 31 DECEMBER 2024**

North End: South side of
concrete pad for first
storm sewer south of
John Deere Ct.

South End: North side of
concrete pad for first
storm sewer north of
Lanterne Drive



Road Running Technical Council
USA Track & Field
Measurement Certificate

recognized by



Name of the course Park Valley Calibration Course Distance 311.753 meters
 Location (state) Illinois (city) Loves Park
 Type of course: road race calibration track Configuration: Straight Line
 Type of surface: paved 100 % dirt _____ % gravel _____ % grass _____ % track _____ %
 Elevation (meters above sea level) Start 275 Finish 275 Highest 275 Lowest 275
 Straight line distance between start & finish 311.753 meters Drop zero m/km Separation 100 %
 Measured by (name, address, phone & e-mail) Norman Yarger 2685 Graham Road
Belvidere, Illinois 61008-6803 (815) 298-2966 nlyarger@yahoo.com
 Race contact (name, address, phone & e-mail) n/a

Measuring Methods: bicycle steel tape electronic distance meter
 Number of measurements of entire course: 2 Date(s) when course measured: July 15, 2014
 Race date: n/a Course certification effective date: August 11, 2014
 Certification code: IL-14126-JW

Notice to Race Director: Use this Certification Code in **all** public announcements relating to your race.

Be It Officially Noted That

Based on examination of data provided by the above named measurer, the course described above and in the map attached is hereby certified as reasonably accurate in measurement according to the standards adopted by the Road Running Technical Council. If **any** changes are made to the course, this certification becomes void, and the course must then be recertified.

Verification of Course — In the event a National Open Record is set on this course, or at the discretion of USA Track & Field, a verification remeasurement may be required to be performed by a member of the Road Running Technical Council. If such a remeasurement shows the course to be short, then all pending records will be rejected and the course certification will be cancelled.

This certification expires on December 31 in the year **2024**

AS NATIONALLY CERTIFIED BY:

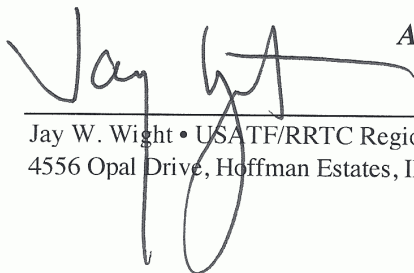

Date: August 14, 2014

Jay W. Wight • USATF/RRTC Regional Certifier
 4556 Opal Drive, Hoffman Estates, Illinois 60192-1185 847-359-4598 jaywight@icloud.com