

Beverly Ann Dr Calibration Course, Lowell, Indiana
300.00 Meters

Measured By
David Mauger
03-15-2015
froggermauger@comcast.net
708-227-5250

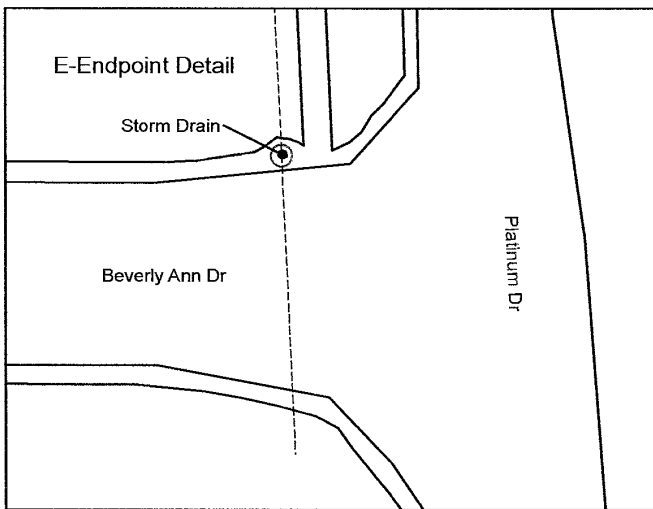
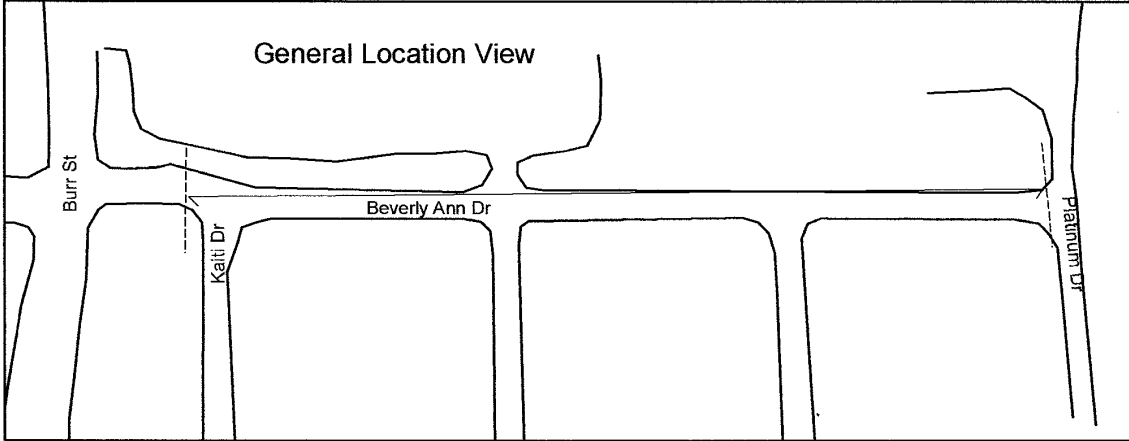

E-Endpoint is even with a line through center of 23-in diameter circular storm sewer at NW-corner of Beverly Ann and Platinum Drives, said line through center of drain cover approximately 2.0-ft W of the W-edge of sidewalk at corner, and said line through center of storm drain is perpendicular to the N-edge of asphalt and seam at flat apron of concrete curb. Marked with a mag nail 4-in S of edge of asphalt and flat edge of curb.

W-Endpoint is a mag nail centrally in road to W-side of Kaiti and Beverly Ann Dr intersection, said nail exactly 18.625-in E of a N-S perpendicular line intersecting 7th curb joint seam E of the stop sign post at NE corner of Beverly Ann Dr and Burr St. Said 7th curb joint-seam line is approximately 80-ft E of stop sign, and approximately 16-ft W of a line parallel to the W-edge of curb along W-side of Kaiti Dr. The said curb 7th joint-seam line is also marked with a mag nail in asphalt 6-in S of edge of N-curb, and backed-up with a 3/8-in steel rod in grass at the top-edge of said N-curb.

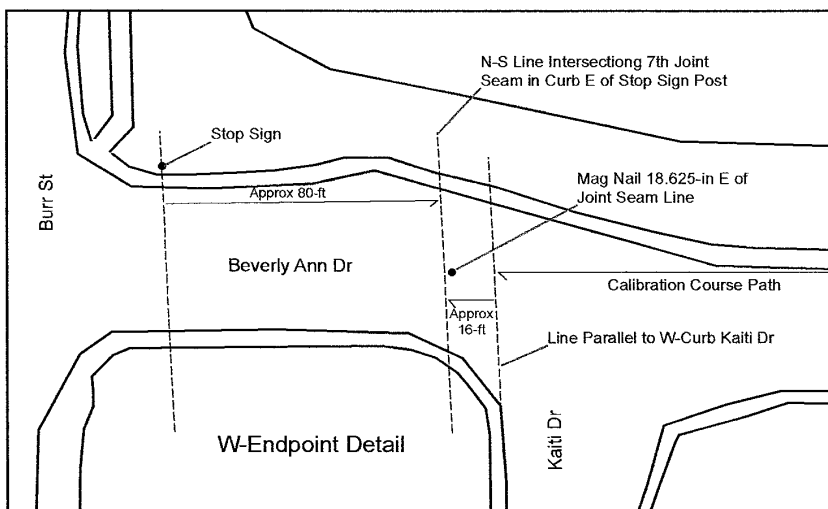

USATF Certificate IN15026TDK
Effective 8/4/15 - 12/31/2025



Road Running Technical Council
USA Track & Field
Measurement Certificate



Name of the course Beverly Ann Drive Calibration Course Distance 300 m
 Location (state) Indiana (city) Lowell
 Type of course: road race calibration track Configuration: Calibration
 Type of surface: paved 100 % dirt _____ % gravel _____ % grass _____ % track _____ %
 Elevation (meters above sea level) Start 213 Finish _____ Highest _____ Lowest _____
 Straight line distance between start & finish 300 m Drop N/A m/km Separation 100 %
 Measured by (name, address, phone & e-mail) David Mauger; 17029 Henry St.; Lansing, IL 60438
Ph: 708 227 5250; froggermauger@comcast.net
 Race contact (name, address, phone & e-mail) N/A

Measuring Methods: bicycle steel tape electronic distance meter
 Number of measurements of entire course: 2 Date(s) when course measured: 3/15/2015
 Race date: N/A Course certification effective date: 8/4/2015
 Certification code: IN15026TDK

Notice to Race Director: Use this Certification Code in **all** public announcements relating to your race.

Be It Officially Noted That

Based on examination of data provided by the above named measurer, the course described above and in the map attached is hereby certified as reasonably accurate in measurement according to the standards adopted by the Road Running Technical Council. If **any** changes are made to the course, this certification becomes void, and the course must then be recertified.

Verification of Course — In the event a National Open Record is set on this course, or at the discretion of USA Track & Field, a verification remeasurement may be required to be performed by a member of the Road Running Technical Council. If such a remeasurement shows the course to be short, then all pending records will be rejected and the course certification will be cancelled.

This certification expires on December 31 in the year **2025**

AS NATIONALLY CERTIFIED BY:

Date: 8/8/2015

Thomas D. Konieczny – USATF/RRTC Certifier
 110 Willow Bend Drive LaPorte, IN 46350 Phone: 219 326 1967 E-mail: konieczny@csinet.net