

Mulvane Calibration Course

Mulvane, KS

USATF Certification
KS14041KH
Effective 8-19-14 to 12-31-24

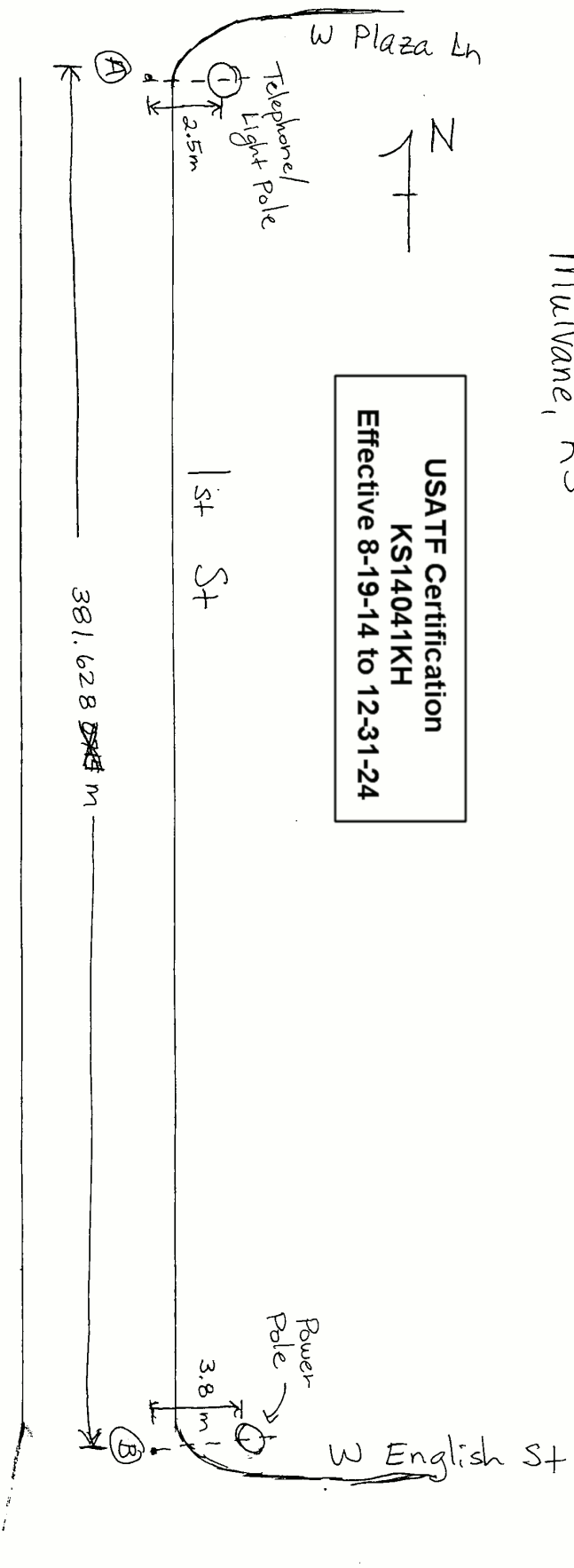

(A) Nail & washer #1

(B) Nail & washer #2

* Nail & washer are centered on the telephone pole and/or power pole in the E-W direction



Road Running Technical Council
USA Track & Field
Measurement Certificate



Name of course: Mulvane Calibration Course Distance: 381.628 m
Location (state) Kansas (city) Mulvane
Type of course: road race ☐ calibration ☒ track ☐ Configuration: Point-to-Point
Type of Surface: paved 100% dirt 0% gravel 0% grass 0% track 0%
Elevation (meters above sea level) Start 381 m Finish 381 m Highest Lowest
Straight line distance between start & finish 381.628 m Drop 0 m/km Separation 100.0%
Measured by (name, address, phone & e-mail) Chris Wyant 1203 Plaza Ln Ct Mulvane, KS 67110
316-529-4662 thewynots@outlook.com
Race Contact (name, address, phone & email) Chris Wyant 1203 Plaza Ln Ct Mulvane, KS 67110
316-529-4662 thewynots@outlook.com
Measuring Methods : bicycle ☐ steel tape ☒ electronic distance meter ☐
Number of measurements of entire course: 2 Date(s) when course measured: Aug. 08, 2014
Race date : n/a Course certification effective date: Aug. 19, 2014
Certification code: KS14041KH

Notice to Race Director : Use this Certification Code
in **all** public announcements relating to your race

Be It Officially Noted That

Based on examination of data provided by the above named measurer, the course described above and in the map attached is hereby certified as reasonably accurate in measurement according to the standards adopted by the Road Running Technical Council. If any changes are made to the course, this certification becomes void, and the course must then be recertified.

Verification of Course — In the event a National Open Record is set on this course, or at the discretion of USA Track & Field, a verification remeasurement may be required to be performed by a member of the Road Running Technical Council. If such a remeasurement shows the course to be short, then all pending records will be rejected and the course certification will be cancelled.

This certification expires on December 31 in the year

2024

AS NATIONALLY CERTIFIED BY

Ken Hardwick

Date: Aug. 31, 2014

Ken Hardwick USATF/RRTC National Certifier
1509 Shrill Ct, Norman, Ok 73071 405-820-6007 Ken@KenHardwick.com