

**BATESVILLE INDUSTRIAL PARK**

**CALIBRATION COURSE**

Installed and Measured: 7/1/13

**Course Description:** The course is in a long, flat, straight section of Industrial Drive located in the Batesville Industrial Park. The baseline is approximately 3" inside the north painted berm line of the roadway. It is marked at 100' intervals beginning at a P-K nail opposite the westernmost paved drive entering the South Mississippi Electric Generating Station and ending near a fire hydrant at the base of a slight incline 1600' from the start. The course was measured with a steel tape and corrected for temperature. (1,600.09' corrected length)

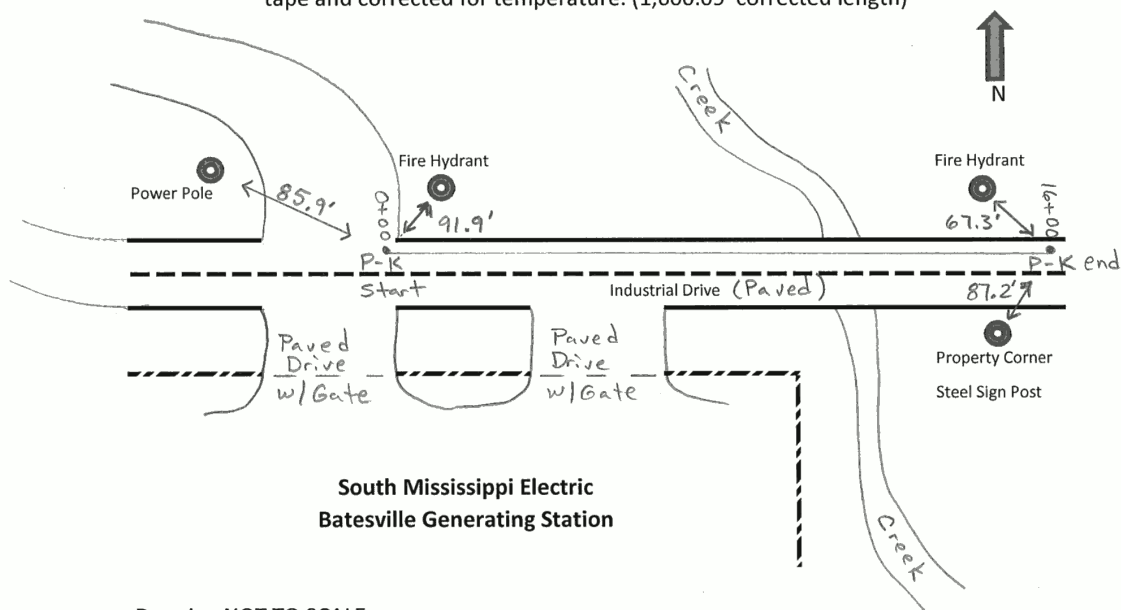

Drawing NOT TO SCALE.



# Road Running Technical Council USA Track & Field Measurement Certificate



Name of the course Batesville Industrial Park 1600.09 feet Distance 1600.09 feet  
 Location (state) Mississippi (city) Batesville  
 Type of course: road race  calibration  track  Configuration: straight line  
 Type of surface: paved 100 % dirt \_\_\_\_\_ % gravel \_\_\_\_\_ % grass \_\_\_\_\_ % track \_\_\_\_\_ %  
 Elevation (meters above sea level) Start 67 m Finish 67 m Highest 67 m Lowest 67 m  
 Straight line distance between start & finish 487.71 m Drop 0 m/km Separation 100 %  
 Measured by (name, address, phone & e-mail) Edward Dean & Jeff Gant e-mail: eddean2008@yahoo.com  
15 Edgarwood Road, Batesville, MS 38606 ph: (662) 609-9222  
 Race contact (name, address, phone & e-mail) not applicable

Measuring Methods: bicycle  steel tape  electronic distance meter   
 Number of measurements of entire course: 2 Date(s) when course measured: 07/01/2013  
 Race date: not applicable Course certification effective date: 08/30/2013  
 Certification code: MS13020MS

Notice to Race Director: Use this Certification Code in *all* public announcements relating to your race.

## Be It Officially Noted That

Based on examination of data provided by the above named measurer, the course described above and in the map attached is hereby certified as reasonably accurate in measurement according to the standards adopted by the Road Running Technical Council. If *any* changes are made to the course, this certification becomes void, and the course must then be recertified.

**Verification of Course** — In the event a National Open Record is set on this course, or at the discretion of USA Track & Field, a verification remeasurement may be required to be performed by a member of the Road Running Technical Council. If such a remeasurement shows the course to be short, then all pending records will be rejected and the course certification will be cancelled.

This certification expires on December 31 in the year 2023

AS NATIONALLY CERTIFIED BY:

Matthew Studholme Date: 01/13/2014  
 Matthew Studholme – USATF/RRTC National Certifier  
 452 Brookhill Drive, Abingdon, Virginia 24210 Phone: (276) 492-1181 E-mail: sheddingcat@comcast.net