

# Cresskill 10K Course Map

3rd St., Cresskill, NJ 07626

USATF Certificate: NT15033LMB

Effective: 9/21/2015 to 12/31/2025

All Directions are Given Relative to the Running Direction.

**Start:** Located 40ft south of Utility Pole 60161, in the entrance to the Cresskill Community Center parking lot

**Mile 1:** On Brookside Ave located 94ft south of Utility Pole 60063 near the Godfrey Pl intersection

**Mile 2:** On 12th St 67ft north of Utility Pole 59875 near the Lexington Ave intersection

**Mile 3:** On Jefferson Ave 53ft north of Utility Pole 60021

**Mile 4:** On 12th St 32ft south of Utility Pole 59879 between Madison Ave & Monument Pl

**Mile 5:** Aligned with the west edge of the tree in front of 74 Heatherhill Rd

**Mile 6:** On 3rd st located 39ft north of Utility Pole 60157 near the Madison Ave intersection

**Finish:** In front of the Cresskill Community Center aligned with the 2nd Handicapped Parking sign to the right of the main entrance. Located 2ft south of the light pole to the right of the main entrance.

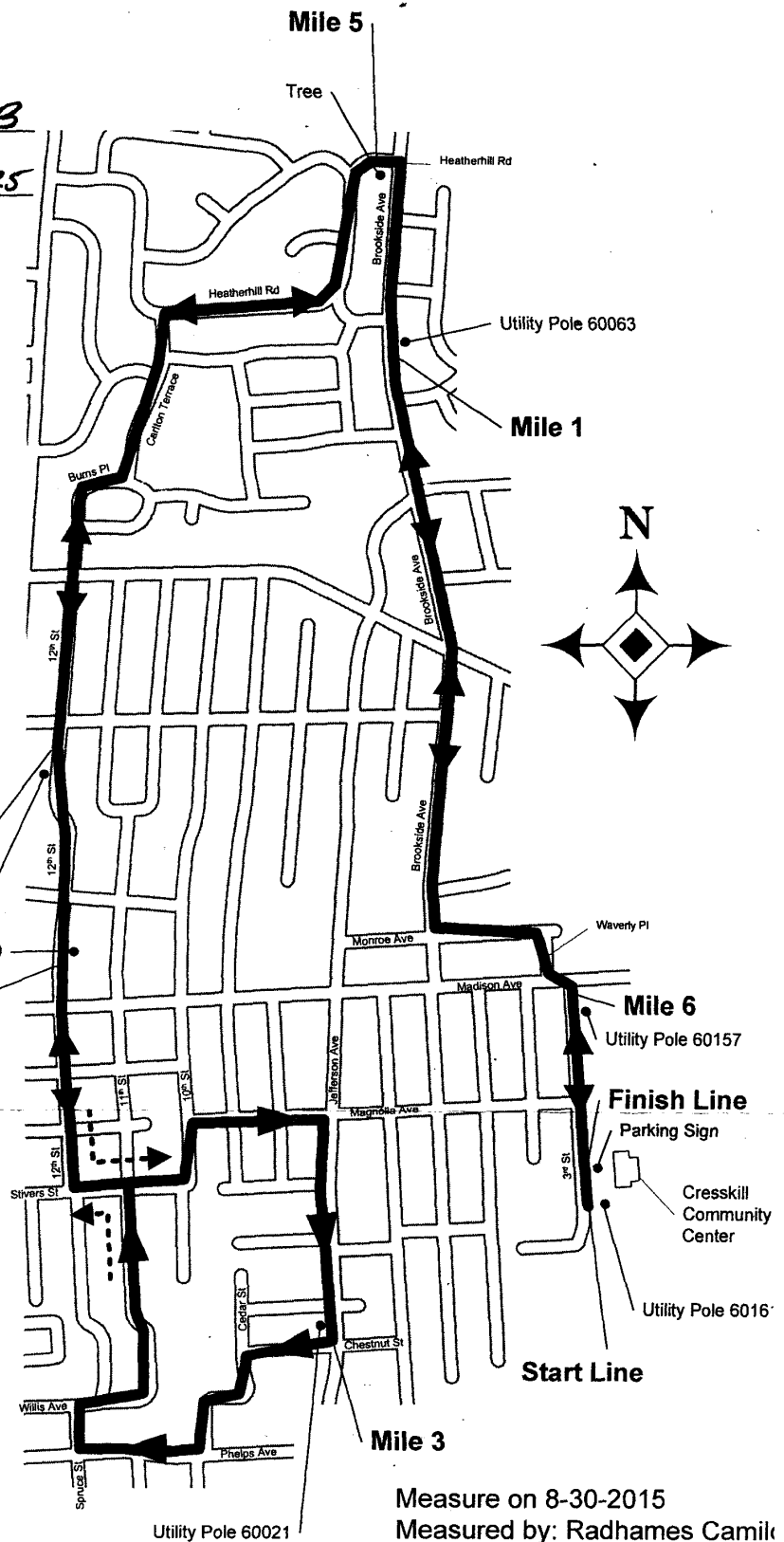
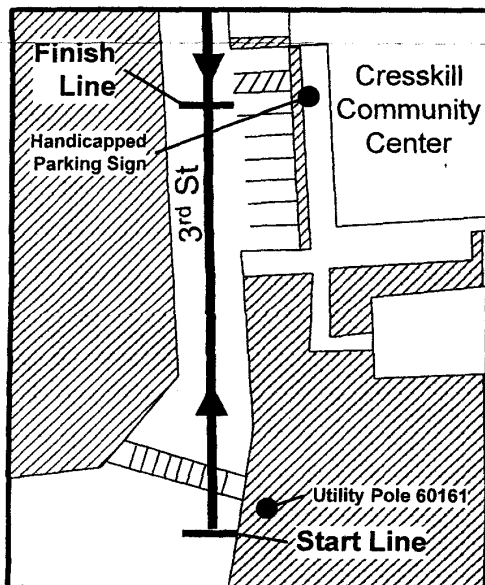

Measure on 8-30-2015  
Measured by: Radhames Camilo  
rcamilo29@yahoo.com

Course Map not to scale



**Road Running Technical Council**  
**USA Track & Field**  
**Measurement Certificate**



Name of the course Cresskill 10K Distance 10 km  
Location (state) New Jersey (city) Cresskill  
Type of course: road race ☒ calibration ☐ track ☐ Configuration: Keyhole  
Type of surface: paved 100 % dirt      % gravel      % grass      % track      %  
Elevation (meters above sea level) Start 11 m Finish 11 m Highest 48 m Lowest 11m  
Straight line distance between start & finish 54 m Drop 0 m/km Separation 0.54 %  
Measured by (name, address, phone & e-mail) Radhames Camilo, 346 Stuyvestant Ave, Lyndhurst, NJ 07071  
rcamilo29@yahoo.com, 201-657-1599  
Race contact (name, address, phone & e-mail) Julie Balay, 144 County Rd, Cresskill, NJ 07626  
971-596-3998, balayjulie@gmail.com  
Measuring Methods: bicycle ☒ steel tape ☐ electronic distance meter ☐  
Number of measurements of entire course: 2 Date(s) when course measured: 8/30/2015  
Race date: 10/18/2015 Course certification effective date: 9/21/2015  
Certification code: NJ15033LMB

Notice to Race Director: Use this Certification Code  
in *all* public announcements relating to your race.

***Be It Officially Noted That***

Based on examination of data provided by the above named measurer, the course described above and in the map attached is hereby certified as reasonably accurate in measurement according to the standards adopted by the Road Running Technical Council. If *any* changes are made to the course, this certification becomes void, and the course must then be recertified.

**Verification of Course** — In the event a National Open Record is set on this course, or at the discretion of USA Track & Field, a verification remeasurement may be required to be performed by a member of the Road Running Technical Council. If such a remeasurement shows the course to be short, then all pending records will be rejected and the course certification will be cancelled.

***This certification expires on December 31 in the year*** **2025**

**AS NATIONALLY CERTIFIED BY:**

Larry M. Baldasari Date: 9/30/2015  
Larry M. Baldasari, Sr. • USATF/RRTC Course Certifier • Phone 609-890-8343  
3448 Nottingham Way, Hamilton Square, NJ 08690 • Email: larsurfrun@gmail.com