

NJ State Fair/SC Farm & Horse Show 5K

THE FOLLOWING MARKS ARE DESCRIBED RELATIVE TO RUNNING DIRECTION.

Map is *not*
drawn to Scale

START: Facing Southwest perpendicular to the side fence gate in line with the (fenced in) greenhouse 1ft Northwest of the gate's Northernmost post.

Mile 1: Facing Southwest in the southern middle section of the Circle Road loop adjacent the fence 7ft 6in. **AFTER** the Power Outlet (many) utility pole (inside fence) that aligns with stables #18/#19 of "Horse Barn B".

Mile 2: Facing East on Northrop Road (dirt gravel section) 73ft 7in **BEFORE** the alignment of the Parking EXIT Sign, Large Tree and E5 Parking section sign to the West.

Mile 3: Facing Northeast 49ft **AFTER** the sewer grate (located inside the Circle Rd loop) Northwest trailing edge.

Finish: Facing Northwest perpendicular to the side fence gate in line with the (fenced in) greenhouse 1ft Northwest of the gate's Northwest post.

Notes: Participants make two (2) laps around the fairgrounds utilizing the interconnects of Northrop and Circle Rds before turning into the finish lane in which they started from.

USATF Certificate #	
NJ16019LMB	
Effective	Jul 30, 2016
From/To:	Dec 31, 2016

Measured: 7-24-2016	
Measurer:	Ross Mistretta
Phone:	917-597-5857
Email:	rmistret@optionline.net

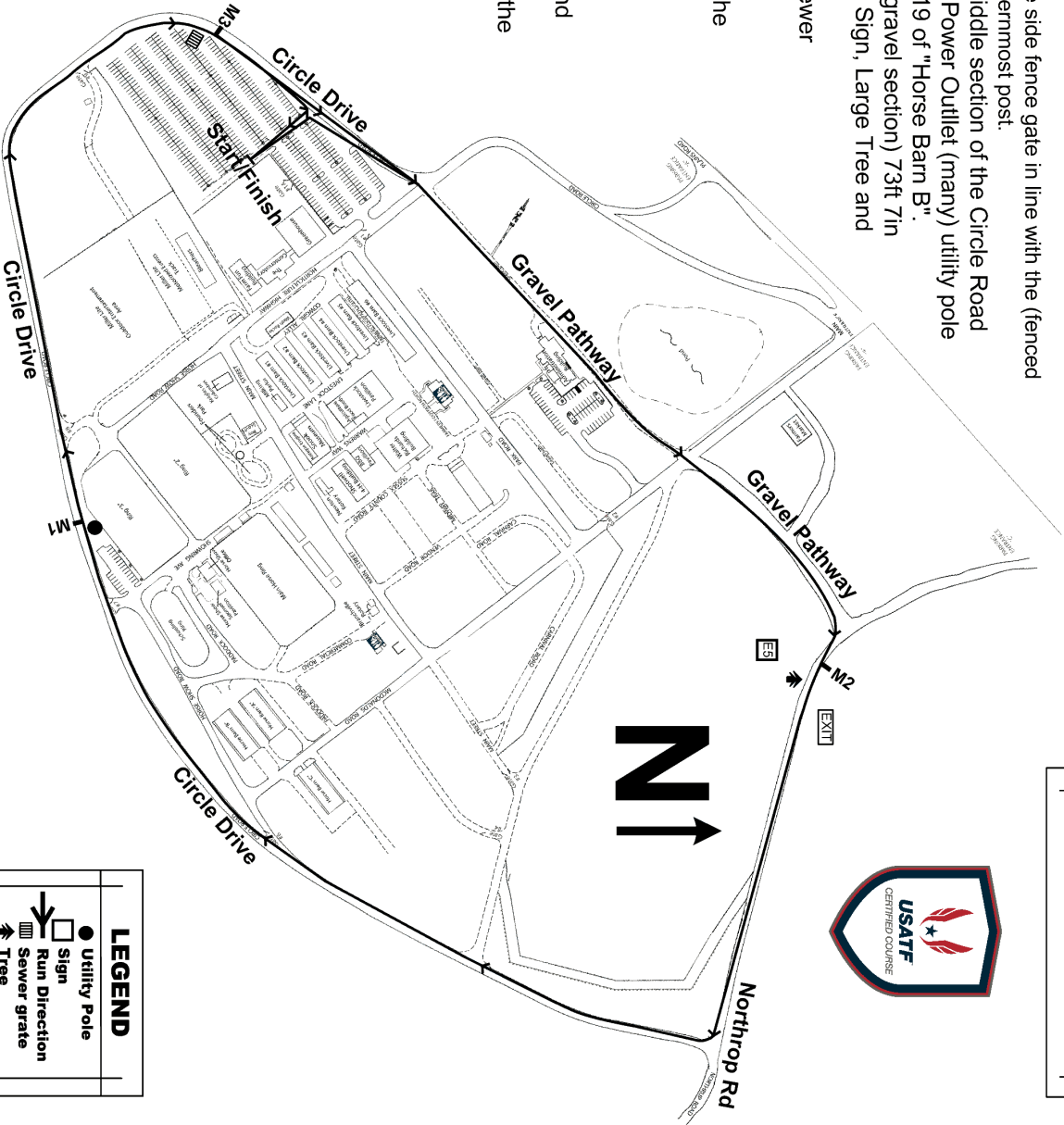

LEGEND	
●	Utility Pole
□	Sign
→	Run Direction
⌘	Sewer grate
🌳	Tree



**Road Running Technical Council
USA Track & Field
Measurement Certificate**



Name of the course NJ State Fair/SC Farm & Horse Show 5K Course Distance 5 km
Location (state) New Jersey (city) Augusta
Type of course: road race ☒ calibration course ☐ track ☐
Measuring methods: bicycle ☒ steel tape ☐ electronic distance meter ☐
Measured by (name, address, phone & e-mail) Ross Mistretta, 96 Carol Place, Wayne NY 07470
973-706-8969; rmistret@optonline.net
Race contact (name, address, phone & e-mail) Fair Manager, PO Box 2456, Branchville NJ 07826
973-948-5500 ex 224; fairmgr@njstatefair.org
Date(s) when course measured: Jul 24, 2016
Number of measurements of entire course: 2 Course Configuration: loop
Elevation (meters above sea level) Start 153 m Finish 153 m Highest 164 m Lowest 151 m
Straight line distance between start & finish 0 m Drop 0 m/km Separation 0 %
Type of surface: paved 70 % dirt - % gravel 30 % grass - % track - %
Effective date of certification: Jul 30, 2016 Certification code: NJ16019LMB

Notice to Race Director: Use this Certification Code
in **all** public announcements relating to your race.

Be It Officially Noted That

Based on examination of data provided by the above named measurer, the course described above and in the map attached is hereby certified as reasonably accurate in measurement according to the standards adopted by the Road Running Technical Council. If **any** changes are made to the course, this certification becomes void, and the course must then be recertified.

Verification of Course — In the event a National Open Record is set on this course, or at the discretion of USA Track & Field, a verification remeasurement may be required to be performed by a member of the Road Running Technical Council. If such a remeasurement shows the course to be short, then all pending records will be rejected and the course certification will be cancelled.

This certification expires on December 31 in the year **2026**

AS NATIONALLY CERTIFIED BY:

Date: Aug 3, 2016

Larry M. Baldasari, Sr. • USATF/RRTC Course Certifier

3448 Nottingham Way, Hamilton Square, NJ 08690 • 609-577-7314 • larsurfrun@gmail.com