

# Ramapo College 5K Mahwah, NJ

THE FOLLOWING MARKS ARE DESCRIBED  
RELATIVE TO THE RUNNING DIRECTION.

**Start:** Start: Facing Northeast on Popular Ave (across from the North end of Visitor Circle parking lot) 17' 10" **AFTER** Lighting pole #75 which is the second lighting pole from the South corner due East of the Guard House at the end of Magnolia Rd.

**Mile 1:** Facing East on Woods Rd **AT** an unmarked lighting pole (has an emergency pack attached) just before the bend that leads South into the Woods Rd, Willow Way and Tupelo Rd intersection.

**Turn Around:** 17' 10" South of the unmarked lighting pole on the West corner of Magnolia Rd & Cherry Ln adjacent the Bradley Sports & Recreation Center and **AFTER**, North of the center island gate barrier system on Cherry Ln

**Mile 2:** Facing Southwest on Willow Way **AT** guard rail post #3 counting back from the end that leading into the Woods, Willow, Tupelo intersection.

**Mile 3:** Facing West 3' 6" **AFTER** the Popular Ave and Sumach Rd street sign.

**Finish:** Same location as **START** facing Southeast.

**Notes:** The beginning and end of the course along Popular and through the Evergreens will share the same line to/from Overlook Residence Hall. From Overlook starting on Woods Rd through Cherry Ln will need the Centerline **CONED** so participants have the entire width of the **RIGHT** side of each road in either direction.

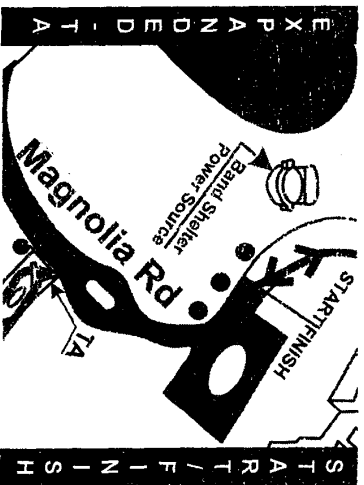

Map is not  
drawn to Scale

LEGEND	
●	Util/Light Pole
▲	Cones
→	Run Direction
⚡	Guard Rail

USATF Certificate #	NT/8001/LMB
Effective	Feb 6, 2018
From/To:	Dec 31, 2018



Measured: 2-1-2018	
Measurer:	Ross Mistretta
Phone:	917-597-5857
Email:	rmistret@optonline.net

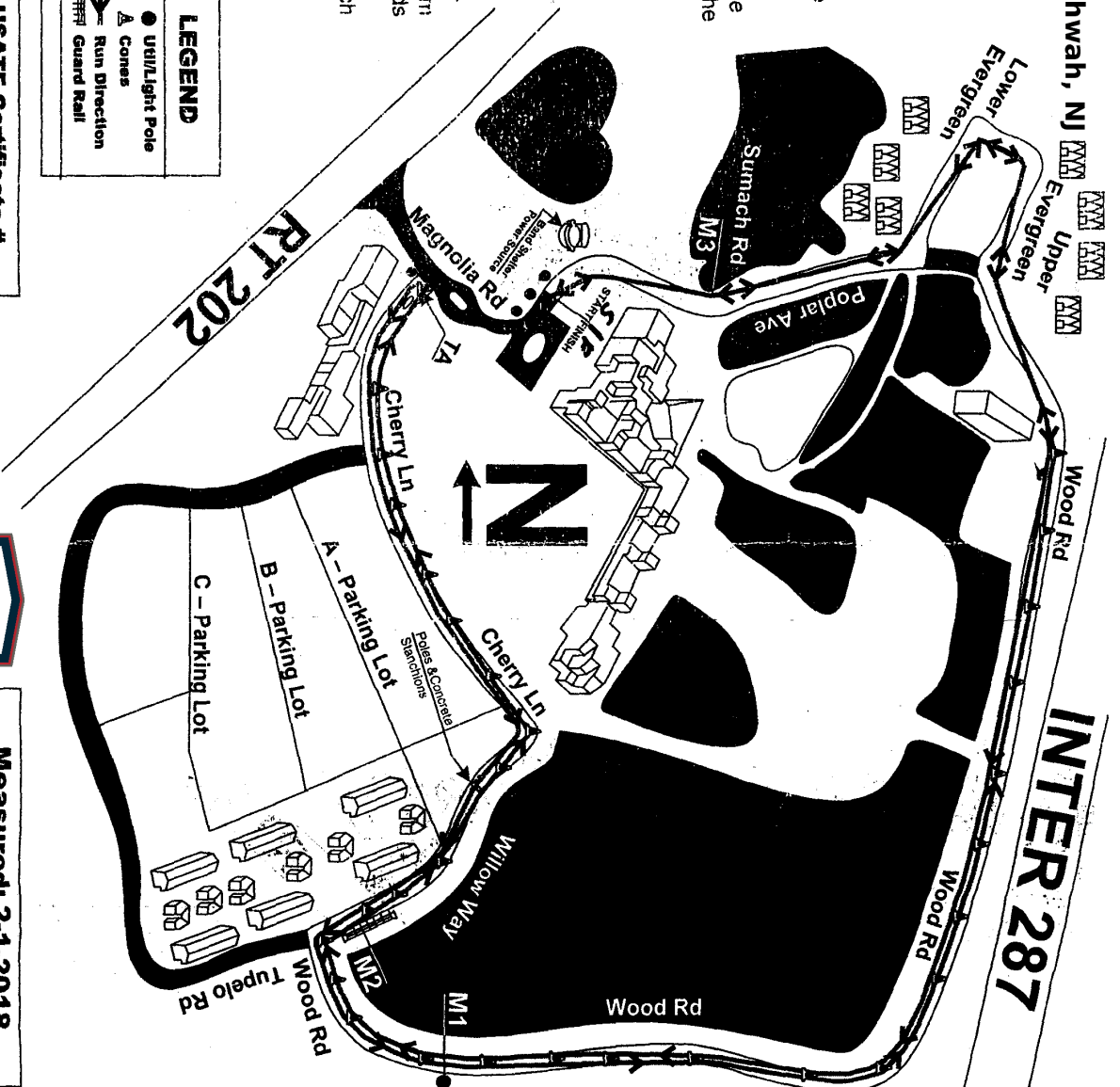

INTER 287



**Road Running Technical Council  
USA Track & Field**

**Measurement Certificate**

recognized by



Name of the course Ramapo College 5K Distance 5 km  
Location (state) New Jersey (city) Mahwah  
Type of course: road race ☒ calibration course ☐  
Measuring method: bicycle ☒ steel tape ☐ electronic distance meter ☐  
Measured by (name, address, phone & e-mail) Ross Mistretta 96 Carol Place Wayne, NJ 07470  
973-706-8969 rmistret@optonline.net  
Race contact (name, address, phone & e-mail) Lisa M. Johnson Ramapo College of NJ 07430  
201-684-6259 ljohnson@ramapo.edu  
Date(s) when course measured: Feb. 1, 2018  
Number of measurements of entire course: 2 Course Configuration: Out/Back  
Elevation (meters above sea level) Start 83.5 m Finish 83.5 m Highest 113 m Lowest 80.5 m  
Straight line distance between start & finish 0 m Drop 0 m/km Separation 0 %  
Type of surface: paved 100 % dirt      % gravel      % grass      % track      %  
Effective date of certification: Feb. 6, 2018 Certification code: NJ18001LMB

Notice to Race Director: Use this Certification Code  
in *all* public announcements relating to your race.

***Be It Officially Noted That***

Based on examination of data provided by the above named measurer, the course described above and in the map attached is hereby certified as reasonably accurate in measurement according to the standards adopted by the Road Running Technical Council. If *any* changes are made to the course, this certification becomes void, and the course must then be recertified.

**Verification of Course** — In the event a National Open Record is set on this course, or at the discretion of USA Track & Field, a verification remeasurement may be required to be performed by a member of the Road Running Technical Council. If such a remeasurement shows the course to be short, then all pending records will be rejected and the course certification will be cancelled.

***This certification expires on December 31 in the year*** **2028**

**AS NATIONALLY CERTIFIED BY:**

  
Larry M. Baldasari, Sr. USATF/RRTC Certifier

Date: Feb. 13, 2018

3448 Nottingham Way Hamilton Square, NJ 08690 - 609-577-7314 - larsurfrun@gmail.com