

# Arthritis Jingle Bell Run – Bergen County

THE FOLLOWING MARKS ARE DESCRIBED RELATIVE TO THE RUNNING DIRECTION.

Start: Facing Northwest on Odabash Way **INLINE** with the LOT C D-7 light/sign pole,

**Mile 1:** Facing Southwest on Odabash Way **AFTER** the Sewer grate (center island) and Scoskie Hall Vet Tech (SHVT) sign and **BEFORE** the lighting pole that proceeds the parking lot entrance for the SHVT.

**TURNAROUND:** Facing Northwest on Odabash Way 28ft 12in **AFTER** the Service box (has bollards on either side) which is on the West side of the roadway just **AFTER** the northmost Ender Hall parking area.

**Mile 2:** Facing Northeast on the BCC LOT C (northend) path **AFTER** the Buehler Challenger & Space Center **BEFORE** Pole E22.

**Mile 3:** Facing Southwest on Odabash Wayne **INLINE** with the LOT B O-11 light/sign pole (off in the distance)

**Finish:** Facing Southwest on Odabash Way **INLINE** with LOT C D-7 light/sign pole.

**Notes:** All roadways will be closed to traffic on the day of the event. Coning is **REQUIRED** down the centerline of Odabash Way to ensure an accurate distance.



USATF Certificate #	<b>NT18021LH8</b>
Effective	<b>Nov 7, 2018</b>
From/To:	<b>Dec 31, 2018</b>

<b>Measured: 10-20-2018</b>	
<b>Measurer:</b>	Ross Mistrretta
<b>Phone:</b>	917-597-5857
<b>Email:</b>	rmistrret@optonline.net

LEGEND	
	Turn Around
	Run Direction
	Coned Area
	Sewer grate

**Map is not  
drawn to Scale**

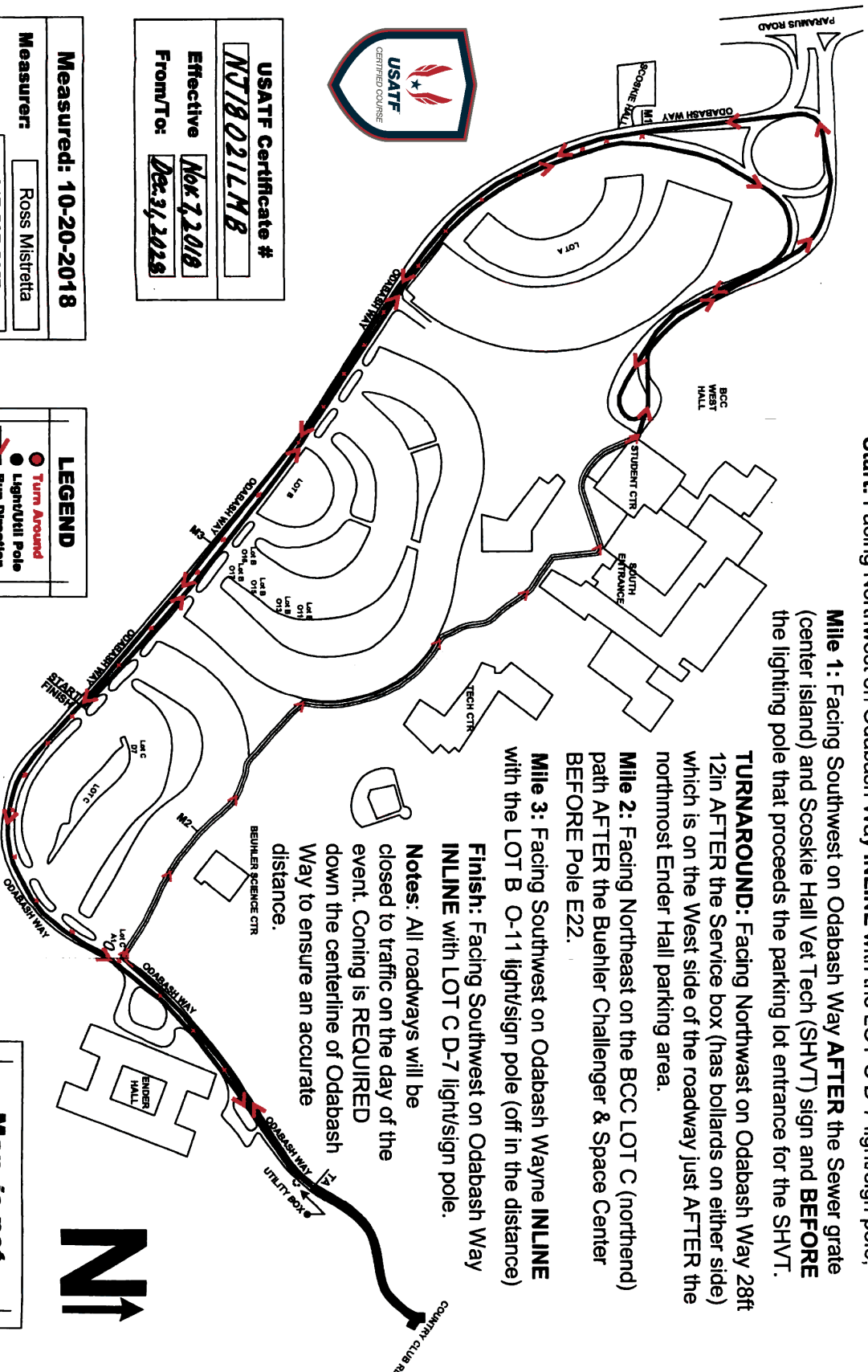



**Road Running Technical Council  
USA Track & Field  
Measurement Certificate**



Name of the course Arthritis Jingle Bell Run - Bergen County Distance 5 km  
Location (state) New Jersey (city) Paramus  
Type of course: road race ☒ calibration course ☐  
Measuring method: bicycle ☒ steel tape ☐ electronic distance meter ☐  
Measured by (name, address, phone & e-mail) Ross Mistretta 96 Carol Place Wayne, NJ 07470  
973-706-8969 rmistret@optonline.net  
Race contact (name, address, phone & e-mail) Emily Meyers 55 Route 1 South Iselin, NJ 07028  
732-400-5467 emeyers@arthritis.org  
Date(s) when course measured: October 20, 2018  
Number of measurements of entire course: 3 Course Configuration: Complex of Loops  
Elevation (meters above sea level) Start 21 m Finish 21 m Highest 27 m Lowest 17 m  
Straight line distance between start & finish 0 m Drop 0 m/km Separation 0 %  
Type of surface: paved 100 % dirt      % gravel      % grass      % track      %  
Effective date of certification: November 7, 2018 Certification code: NJ18021LMB

Notice to Race Director: Use this Certification Code  
in **all** public announcements relating to your race.

***Be It Officially Noted That***

Based on examination of data provided by the above named measurer, the course described above and in the map attached is hereby certified as reasonably accurate in measurement according to the standards adopted by the Road Running Technical Council. If **any** changes are made to the course, this certification becomes void, and the course must then be recertified.

**Verification of Course** — In the event a National Open Record is set on this course, or at the discretion of USA Track & Field, a verification remeasurement may be required to be performed by a member of the Road Running Technical Council. If such a remeasurement shows the course to be short, then all pending records will be rejected and the course certification will be cancelled.

***This certification expires on December 31 in the year*** **2028**

**AS NATIONALLY CERTIFIED BY:**

Larry M. Baldasari Date: November 7, 2018  
Larry M. Baldasari, Sr. USATF/RRTC Certifier  
3448 Nottingham Way Hamilton Square, NJ 08690 - 609-577-7314 - larsurfrun@gmail.com