

# PRO BIKE + RUN TIMING 1,000 FT CALIBRATION

Pittsburgh, PA

Certified Course#  
PA19007NP



Effective Dates:  
2..7.19 thru 12.31.19

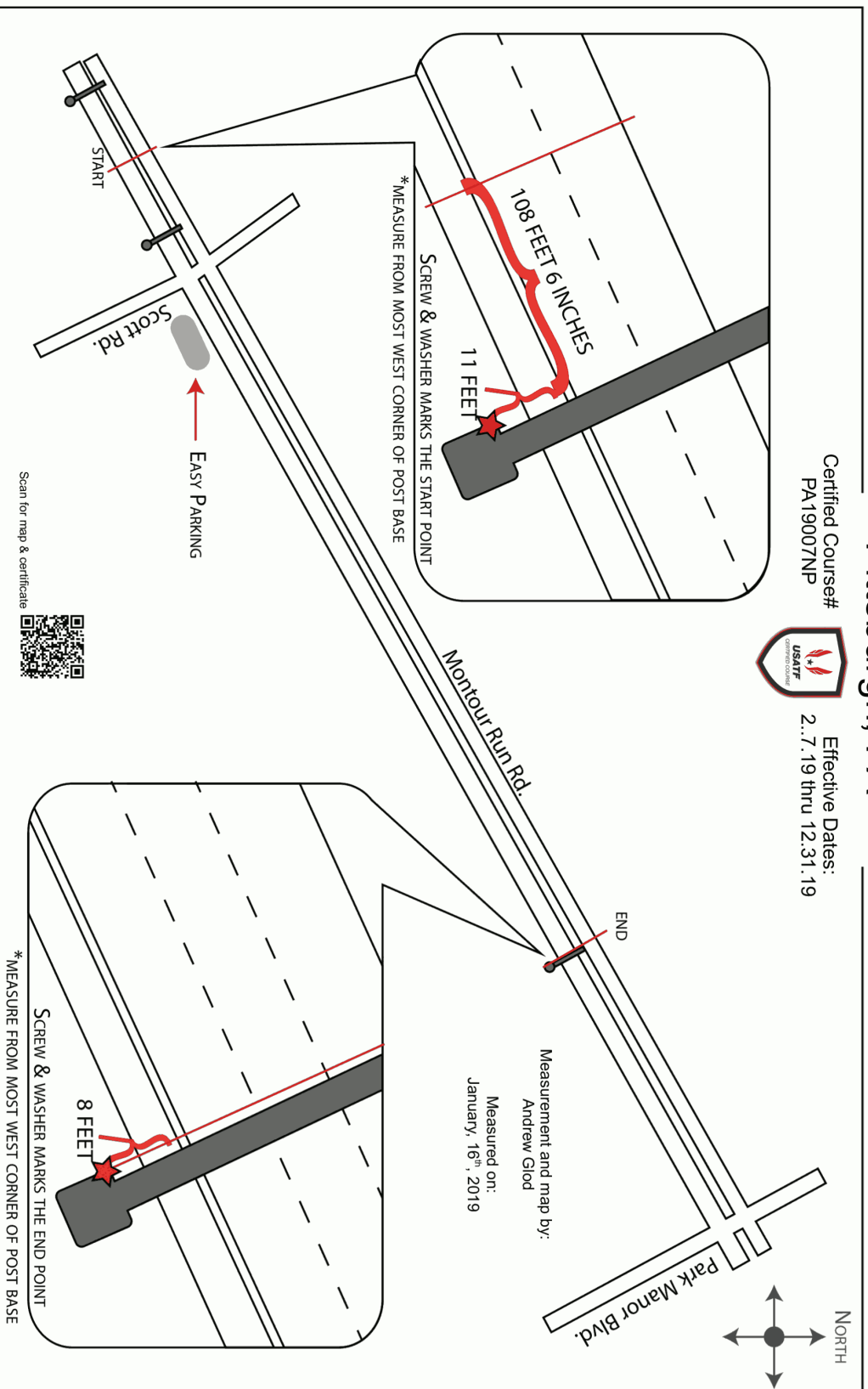



*Road Running Technical Council  
USA Track & Field*

# *Measurement Certificate*



Name of the course Pro Bike + Run Timing 1000' Calibration Distance 304.8m  
 Location (state) Pennsylvania (city) Pittsburgh  
 Type of course: road race  calibration course   
 Measuring method: bicycle  steel tape  electronic distance meter   
 Measured by (name, address, phone & e-mail) Andrew Glod, 3100 Robinson Ln, Pittsburgh, PA 15205  
412.577.8556 | andrew@probikerun.com  
 Race contact (name, address, phone & e-mail) Same

Date(s) when course measured: Jan. 16, 2019  
 Number of measurements of entire course: 2 Course Configuration: Point to Point  
 Elevation (meters above sea level) Start 260m Finish 260m Highest 260m Lowest 260m  
 Straight line distance between start & finish 304.8m Drop 0.00 m/km Separation 100.0 %  
 Type of surface: paved 100 % dirt \_\_\_\_\_ % gravel \_\_\_\_\_ % grass \_\_\_\_\_ % track \_\_\_\_\_ %  
 Effective date of certification: Feb. 7, 2019 Certification code: PA19007NP

Notice to Race Director: Use this Certification Code in *all* public announcements relating to your race.

## *Be It Officially Noted That*

Based on examination of data provided by the above named measurer, the course described above and in the map attached is hereby certified as reasonably accurate in measurement according to the standards adopted by the Road Running Technical Council. If *any* changes are made to the course, this certification becomes void, and the course must then be recertified.

*Verification of Course* — In the event a National Open Record is set on this course, or at the discretion of USA Track & Field, a verification remeasurement may be required to be performed by a member of the Road Running Technical Council. If such a remeasurement shows the course to be short, then all pending records will be rejected and the course certification will be cancelled.

*This certification expires on December 31 in the year* 2029

*AS NATIONALLY CERTIFIED BY:*

Nathan Porch Date: Feb. 7, 2019

Nathan J. Porch – USATF/RRTC Certifier  
 940 Frenchtown Rd., Perryville, MD 21903 | 856.803.7678 | E-mail