

Pine Tree 1000 Feet
East Palatka, FL

Map is not to scale.

Points are marked with nails and yellow paint on the road.

List of Measured Points

Start – On SR 207A, at the intersection with Pine Tree Road, directly even with Power Pole #34039844801.

Finish – On SR 207A, 4 feet 9 1/2 inches, west of Power Pole # 34139063808.

PP # 34039844801

PP # 34139063808

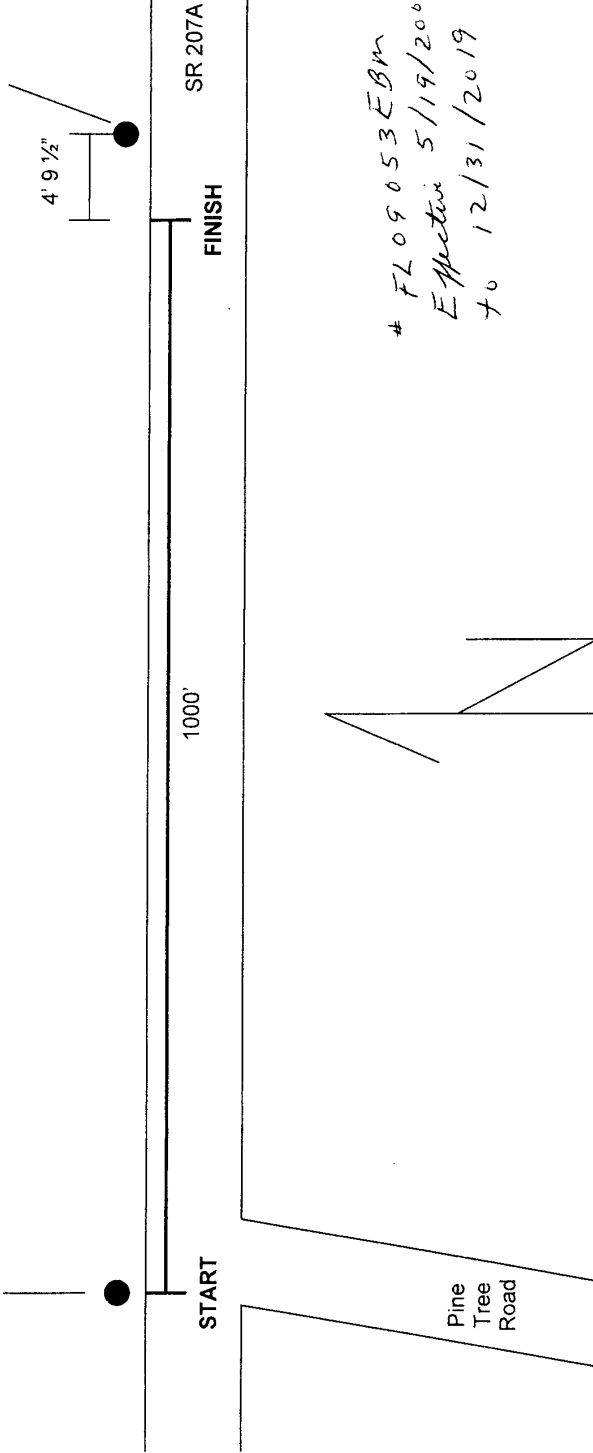



Road Running Technical Council
USA Track & Field
Measurement Certificate



Name of the course Pine Tree 1000' Distance 1000'
 Location (state) Florida (city) East Palatka
 Type of course: road race calibration track Configuration: Point to Point
 Type of surface: paved 100 % dirt _____ % gravel _____ % grass _____ % track _____ %
 Elevation (meters above sea level) Start 3m Finish 3m Highest 3m Lowest 3m
 Straight line distance between start & finish 304.8m Drop 0 m/km Separation 100 %
 Measured by (name, address, phone & e-mail) Jacob Smith, 114 Oak Lane, East Palatka,
Florida 32131 386-747-3532 jacob@racesmith.com
 Race contact (name, address & phone) Same as above

Measuring Methods: bicycle _____ steel tape electronic distance meter
 Number of measurements of entire course: 2 Date(s) when course measured: 5/6/09
 Race date: N/A Course certification effective date: 5/19/09
 Replaces: N/A (if applicable) Certification code: FL09053EBM

Notice to Race Director
 Use this Certification Code in **all** public
 announcements relating to your race.

Be It Officially Noted That

Based on examination of data provided by the above named measurer, the course described above and in the map attached is hereby certified as reasonably accurate in measurement according to the standards adopted by the Road Running Technical Council. If **any** changes are made to the course, this certification becomes void, and the course must then be recertified.

Validation of Course — In the event a National Open Record is set on this course, or at the discretion of USA Track & Field, a validation remeasurement may be required to be performed by a member of the Road Running Technical Council. If such a remeasurement shows the course to be short, then all pending records will be rejected and the course certification will be cancelled.

This certification expires on December 31 in the year **2019**

AS NATIONALLY CERTIFIED BY:

Event McDowell Date: 5/24/09
 Name – USATF/RRTC National Certifier
 Address Phone E-mail

FL09053 EB M