

Excalibur 10 Miller

Viera, FL

Map is not to scale.

Points are marked with yellow paint in the road.

List of Measured Points

Start – On the bus drop off loop road, 42 feet 7 inches east of the western gate post of the furthest east gate at Viera High School.

Mile 1 – On Stadium Parkway, on the overpass of the trail, 134 feet 1 inches south of the center of the tunnel.

Mile 2 – On Porada Drive, 25 feet 10 inches northwest of the end of the median, leading to the intersection with Stadium Parkway.

Mile 3 – On Viera Blvd., 92 feet east of the west end of the concrete wall, at the split with the white fence.

Mile 4 – On Power Line Road, at the center of the canal, 102 feet 8 inches north of power pole # 117W8.

Mile 5 – On Power Line Road, 226 Feet 10 Inches south of power pole # 116W9.

Mile 6 – On the concrete path paralleling Wickham Road, 352 feet 1 inch west of the underground cable marker SP1, just east of the "No Passing Zone" sign.

Mile 7 – On the concrete path paralleling Stadium Parkway, even with the southern edge of electrical box # PM S3.

Mile 8 – In the southern parking lot for the Moore Justice Center, 188 feet 5 inches east of concrete pole # 25 04 03.

Turnaround – On Judge Fran Jamieson Way, between Arroyo Drive and Legacy Blvd, 121 feet 8 inches west of the manhole cover/storm drain, even with the east end of the concrete wall at "The Villages of South Salerno".

Mile 9 – On the concrete path paralleling Judge Fran Jamieson Way, 33 feet 9 inches east of the western end of the median, just west of Breslay Drive.

Finish – On the north side of the Viera High School track, even with the center of the drainage grate at the center of the field.

Measured by: Jacob Smith

Jacob@RacesSmith.com

Measured on: 01/15/2014

USATF Certification #FL14016 EBM
Effective Feb. 5, 2014 to Dec. 31, 2024

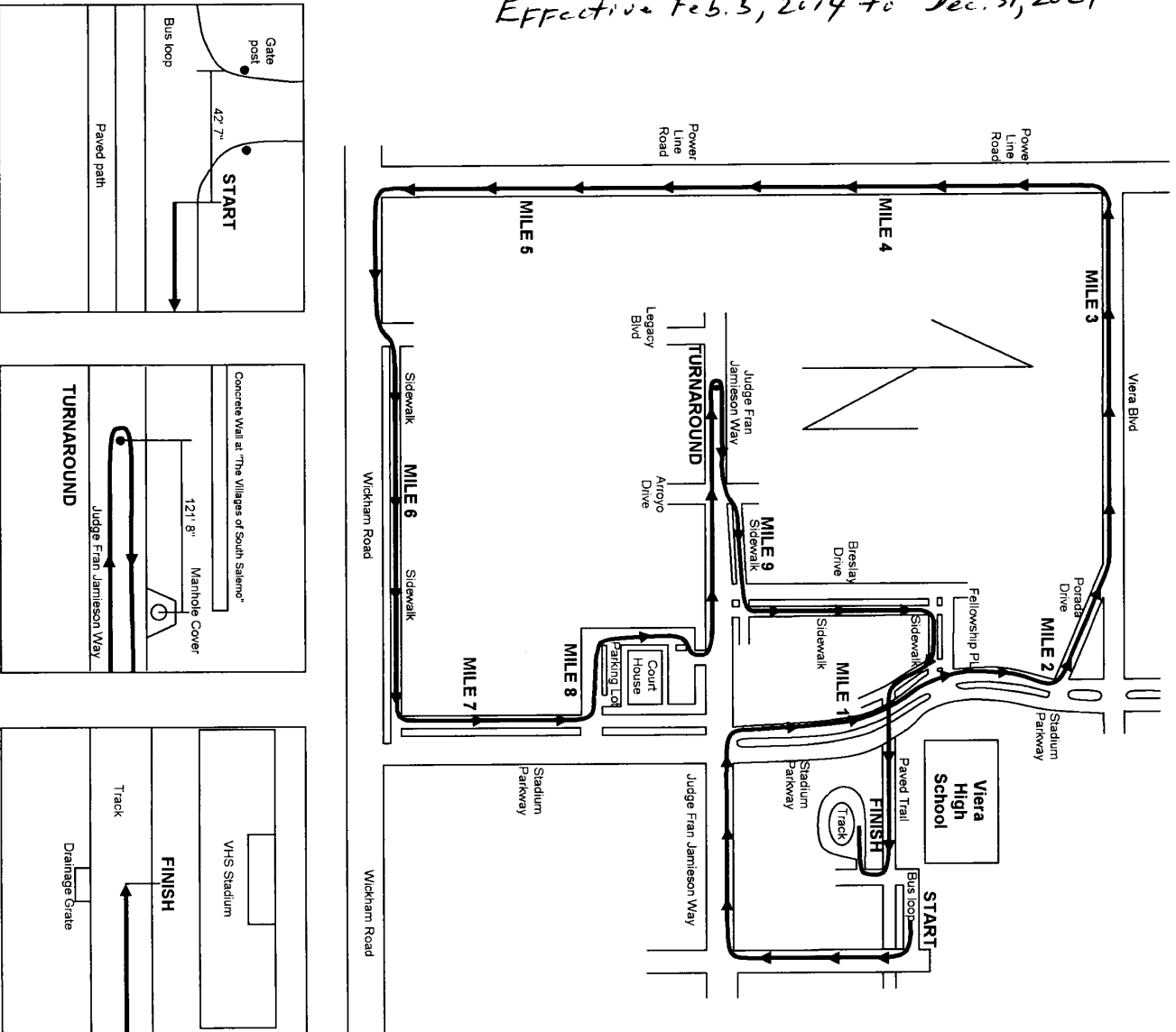



Road Running Technical Council
USA Track & Field
Measurement Certificate



Name of the course Excalibur 10 Miler Distance 16.09344km
Location (state) Florida (city) Viera
Type of course: road race ☒ calibration ☐ track ☐ Configuration: One Loop
Type of surface: paved 78.2 % dirt % gravel 21.8 % grass % track %
Elevation (meters above sea level) Start 7.9m Finish 7.3m Highest 11.9m Lowest 6.1m
Straight line distance between start & finish 106m Drop .04 m/km Separation .7 %
Measured by (name, address, phone & e-mail) Jacob Smith, 114 Oak Lane, East Palatka, Fl.
32131 386-747-3532 jacob@racesmith.com
Race contact (name, address, phone & e-mail) Don Piercy, 3696 North Wickham Road, Melbourne,
Fl. 32935 321-751-8890 info@excaliburrun.com
Measuring Methods: bicycle ☒ steel tape ☐ electronic distance meter ☐
Number of measurements of entire course: 2 Date(s) when course measured: Jan. 15, 2014
Race date: Mar. 2, 2014 Course certification effective date: Feb. 5, 2014
Certification code: FL14016EBM

Notice to Race Director: Use this Certification Code
in *all* public announcements relating to your race.

Be It Officially Noted That

Based on examination of data provided by the above named measurer, the course described above and in the map attached is hereby certified as reasonably accurate in measurement according to the standards adopted by the Road Running Technical Council. If *any* changes are made to the course, this certification becomes void, and the course must then be recertified.

Verification of Course — In the event a National Open Record is set on this course, or at the discretion of USA Track & Field, a verification remeasurement may be required to be performed by a member of the Road Running Technical Council. If such a remeasurement shows the course to be short, then all pending records will be rejected and the course certification will be cancelled.

This certification expires on December 31 in the year **2024**

AS NATIONALLY CERTIFIED BY:

Everett McDowell Date: Feb. 11, 2014
Everett McDowell – USATF/RRTC National Certifier
1256 Stony Brook Lane, Dunedin, Florida 34698 727-644-7608 emcdowell5@tampabay.rr.com