



**USATF Certificate  
Pre-verified**

NY180622JG

Effective: 07/26/2018  
through 12/31/2028

# Hamptons Marathon Southampton, NY

Note: The route for the full and half marathon is the same for both courses to the turn on Great Plains Rd approaching Mile 8.

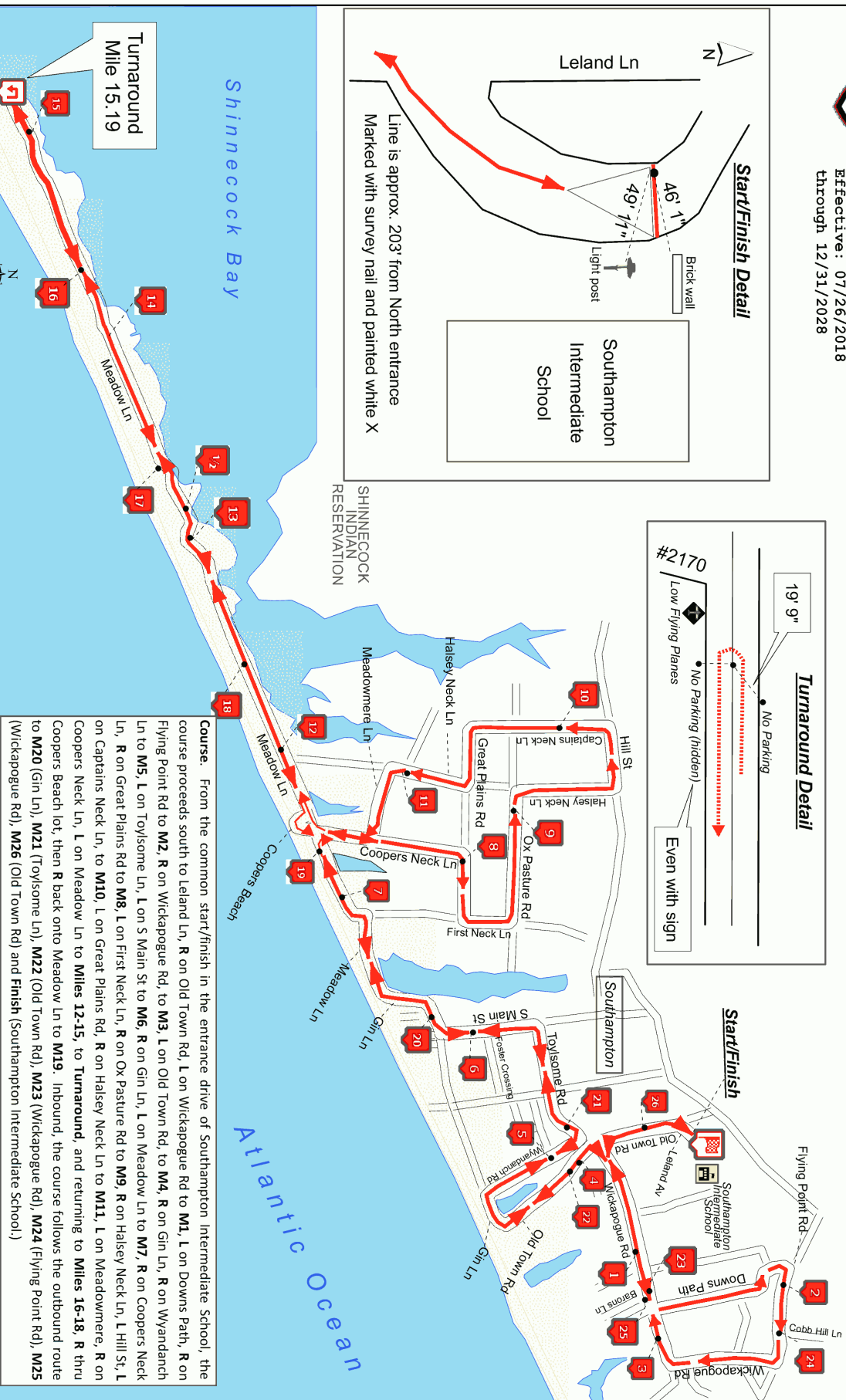
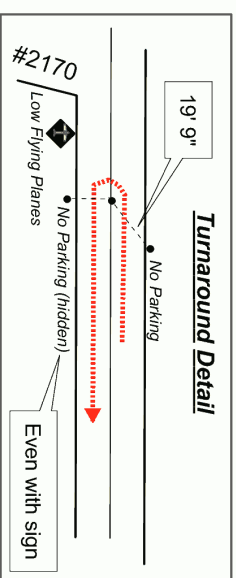
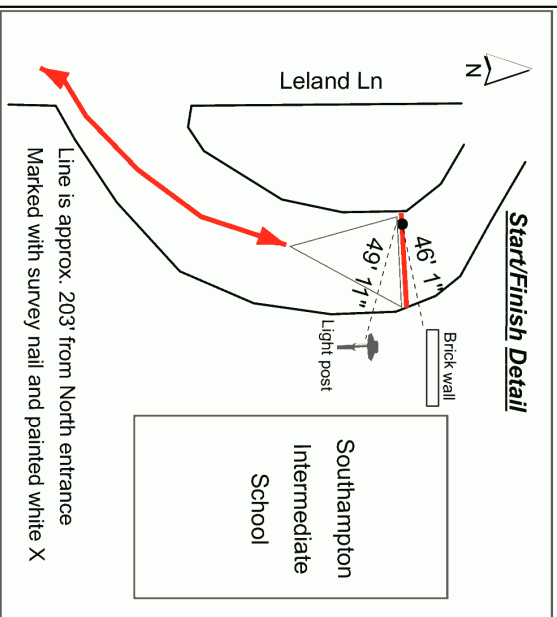

**Course.** From the common start/finish in the entrance drive of Southampton Intermediate School, the course proceeds south to Leland Ln, R on Old Town Rd, L on Wickapogue Rd to M1, L on Downs Path, R on Flying Point Rd to M2, R on Wickapogue Rd, to M3, L on Old Town Rd, to M4, R on Gin Ln, R on Wyandanch Ln to M5, L on Toysome Ln, L on S Main St to M6, R on Gin Ln, L on Meadow Ln to M7, R on Coopers Neck Ln, R on Great Plains Rd to M8, L on First Neck Ln, R on Ox Pasture Rd to M9, R on Halsey Neck Ln, L Hill St, L on Captains Neck Ln, to M10, L on Great Plains Rd, R on Halsey Neck Ln to M11, L on Meadowmere, R on Coopers Neck Ln, L on Meadow Ln to Miles 12-15, to Turnaround, and returning to Miles 16-18, R thru Coopers Beach lot, then R back onto Meadow Ln to M19. Inbound, the course follows the outbound route to M20 (Gin Ln), M21 (Toysome Ln), M22 (Old Town Rd), M23 (Wickapogue Rd), M24 (Flying Point Rd), M25 (Wickapogue Rd), M26 (Old Town Rd) and Finish (Southampton Intermediate School.)

Pre-verified 7/20-21/18 by Jim Gilmer | IAAF-A | jim.gilmer@gmail.com | 518-852-3562 and Gary Westerfield | IAAF-B  
Mapped by Jim Gilmer



**Road Running Technical Council  
USA Track & Field**

# *Measurement Certificate*

recognized by



Name of the course Hamptons Marathon Distance 42.195 km  
 Location (state) NY (city) Southampton  
 Type of course: road race  calibration course   
 Measuring method: bicycle  steel tape  electronic distance meter   
 Measured by (name, address, phone & e-mail) Pre-verified by Jim Gilmer, IAAF-A, 232 Van Wies Point Rd,  
Glenmont, NY 12077; 518-852-3562; jim.gilmer@gmail.com; and Gary Westerfield, IAAF-B  
 Race contact (name, address, phone & e-mail) Harrison Schenck, Capstone Event Group 3803-B Computer Dr  
Raleigh, NC 27609, 919-417-3887, harrison@capstoneraces.com  
 Date(s) when course measured: July 20-21, 2018  
 Number of measurements of entire course: 2 Course Configuration: Complex of loops (with turnaround)  
 Elevation (meters above sea level) Start 10.06 Finish 10.06 Highest 12.50 Lowest 1.83  
 Straight line distance between start & finish 0.00 Drop 0.00 m/km Separation 0.00 %  
 Type of surface: paved 100 % dirt - % gravel - % grass - % track - %  
 Effective date of certification: July 26, 2018 Certification code: NY18062JG

Notice to Race Director: Use this Certification Code in **all** public announcements relating to your race.

## *Be It Officially Noted That*

Based on examination of data provided by the above named measurer, the course described above and in the map attached is hereby certified as reasonably accurate in measurement according to the standards adopted by the Road Running Technical Council. If **any** changes are made to the course, this certification becomes void, and the course must then be recertified.

**Verification of Course** — In the event a National Open Record is set on this course, or at the discretion of USA Track & Field, a verification remeasurement may be required to be performed by a member of the Road Running Technical Council. If such a remeasurement shows the course to be short, then all pending records will be rejected and the course certification will be cancelled.

***This certification expires on December 31 in the year*** **2028**

**AS NATIONALLY CERTIFIED BY:**

Digitally signed by Jim Gilmer  
DN: cn=Jim Gilmer, o=USATF Road Running Technical  
Council, ou=Regional Certifier, New York,  
email=jim.gilmer@gmail.com, c=US  
Date: 2018.07.26 13:04:33 -0400

Date: July 26, 2018

James A. Gilmer, USATF/RRTC Certifier • 232 Van Wies Point Rd., Glenmont, NY 12077-4222  
 Phone: 518-852-3562 • Email: jim.gilmer@gmail.com

Hamptons Marathon Key Points		
Point	Description (described as course is run)	Lat/Long (DD)
Start/Finish	At Southampton Intermediate School, ~203' from north entrance on Leland	
M1-Both	#288 Wickapogue Rd, before entrance and 9' before pole #21	40.886380°, -72.369747°
M2-Both	#142 Flying Point Rd, 27' after mailbox, across from gate	40.896041°, -72.367155°
M3-Both	#451 Wickapogue Rd, across from, at pole #40, 49' after drive for #451 and 49' before hydrant.	40.887665°, -72.361453°
M4-Both	Old Town Rd after Old Town Crossing at Cherry Tree Park; 8' after double storm drains	40.882772°, -72.377844°
M5-Both	#81 Wyandanch Ln, 33' before "No Parking" sign, 62' after #101 driveway	40.880178°, -72.377087°
M6-Both	#322 S Main St, opposite south edge of driveway	40.875409°, -72.387904°
M7-Both	#53 Meadow Ln, 150' after driveway, 4' after telecom box on R	40.867054°, -72.399604°
M8-Full	#133 Great Plains Rd (across from), east of Coopers Neck, 60' after pole #34, 41' before pole 26	40.875084°, -72.402971°
M9-Full	#275 Ox Pasture Rd, 60' after pole #35, 55' before pole #34	40.878197°, -72.407391°
M10-Full	#110 Captain's Neck Ln, between driveways for #110, 36' after north drive	40.881178°, -72.414031°
M11-Full	#543 Halsey Neck Ln on L, 22' before driveway, 90' before Meadowmere Ln	40.870470°, -72.410516°
M12-Full	#450 Meadow Ln after Coopers Beach, 9' before "Dead End" sign	40.862962°, -72.412392°
M13-Full	#980 Meadow Ln, across from util box "105794"	40.857255°, -72.429894°
½ Marathon-Full	#1030 Meadow Ln, 35' after mailbox	40.856827°, -72.431793°
M14-Full	#1496 Meadow Ln, 38' after mailbox at LIPA util box	40.851980°, -72.447461°
M15-Full	#2140 Meadow Ln, 33' after electric box "76432" and 60' before mailbox	40.846568°, -72.465058°
Turnaround-Full	#2150 Meadow Ln at hidden "No Paarking" sign on south	40.845446°, -72.468181°
M16-Full	#1710 Meadow Ln across from mailbox	40.849819°, -72.454489°
M17-Full	#1191 Meadow Ln, east edge of driveway apron	40.855392°, -72.436903°
M18-Full	#650 Meadow Ln, 320' before T-Bone Landing sign, 5' before iron util box at "No Parking" sign	40.860726°, -72.419404°
M19-Full	#170 Meadow Ln, 279' after mailbox, 56' after "No Parking" sign	40.865778°, -72.403394°
M20-Full	#46 Gin Ln, across from mailbox for #26, 17' before #46 driveway	40.873194°, -72.388560°
M21-Full	#258 Toylesome Ln, 59' before driveway, across from #245	40.881580°, -72.379792°
M22-Full	Old Town Rd at before Old Town Crossing; 10' before Olde Towne (Kean Development) sign	40.882356°, -72.377254°
M23-Full	#350 Wickapogue Rd, 6' before mailbox for #375 and across from Mile 25	40.886982°, -72.365568°
M24-Full	Flying Point Rd at Cobb Hill Ln, 20' after street sign	40.895423°, -72.363020°
M25-Full	#350 Wickapogue Rd, 12' after mailbox	40.886949°, -72.365568°
M26-Full	#111 Old Town Rd, across from, 16' after pole #54.	40.887804°, -72.379622°

Note: All points are marked with survey nail thru orange tape. No marking paint applied except Start/Finish.