



**Road Running Technical Council  
USA Track & Field  
Measurement Certificate**



Name of the course Mud Mountain Marathon Distance 42.195 km  
Location (state) WA (city) McMillan  
Type of course: Road Race  
Measuring Methods: Bicycle  
Measured By Tony Phillippi, 4815 N 49th St, Tacoma, WA 98407, tony@tcmaevents.com, 253-227-3545  
Race Contact Tony Phillippi, 4815 N 49th St, Tacoma, WA 98407, tony@tcmaevents.com, 253-227-3545  
Date(s) when course measured: 9/7/2021, 9/15/2021  
Number of measurements of entire course: 2 Course Configuration: Point to Point  
Elevation (meters above sea level) Start 402.00 Finish 40.00 Lowest 40.00 Highest 402.00  
Straight line distance between start and finish 22917m Drop 8.58 m/km Separation 54.30 %  
Type of surface: Paved 99.9 % Dirt 0.1 % Gravel 0 % Grass 0 % Track 0 %  
Effective date of certification: September 28, 2021 Certification code: WA21013RMB

Note to Race Director: Use this Certification Code  
in all public announcements relating to your race.

## ***Be It Officially Noted That***

Based on examination of data provided by the above named measurer, the course described above and in the map attached is hereby certified as reasonably accurate in measurement according to the standards adopted by the Road Running Technical Council. If any changes are made to the course, this certification becomes void, and the course must then be recertified.

**Verification of Course ---** In the event a National Open Record is set on the course, or at the discretion of USA Track & Field, a verification measurement may be required to be performed by a member of the Road Running Technical Council. If such a remeasurement shows the course to be short, then all pending records will be rejected and the course certification will be cancelled.

***This certification expires on December 31 of the year:*** **2031**

**AS NATIONALLY CERTIFIED BY:**

Date: September 30, 2021

Bob Brennand - USATF/RRTC Certifier - 4113 Banbridge Loop SE, Olympia WA 98501  
(360) 310-0747 - bobbrennand@comcast.net

# Mud Mountain Marathon

Measured by Tony Phillippi  
tony@marathonmaniacs.com  
9-7-21, 9-15-21

Start: Enumclaw, WA; Fin: McMillan, WA  
300m Calibration Course Used  
WA18004RMB

North

W  
S  
E

Enumclaw Buckley Rd Hwy 410  
Fish Hatchery Rd

**USATF Certificate**  
WA21013RMB  
Effective: 09/28/2021  
Through: 12/31/2031

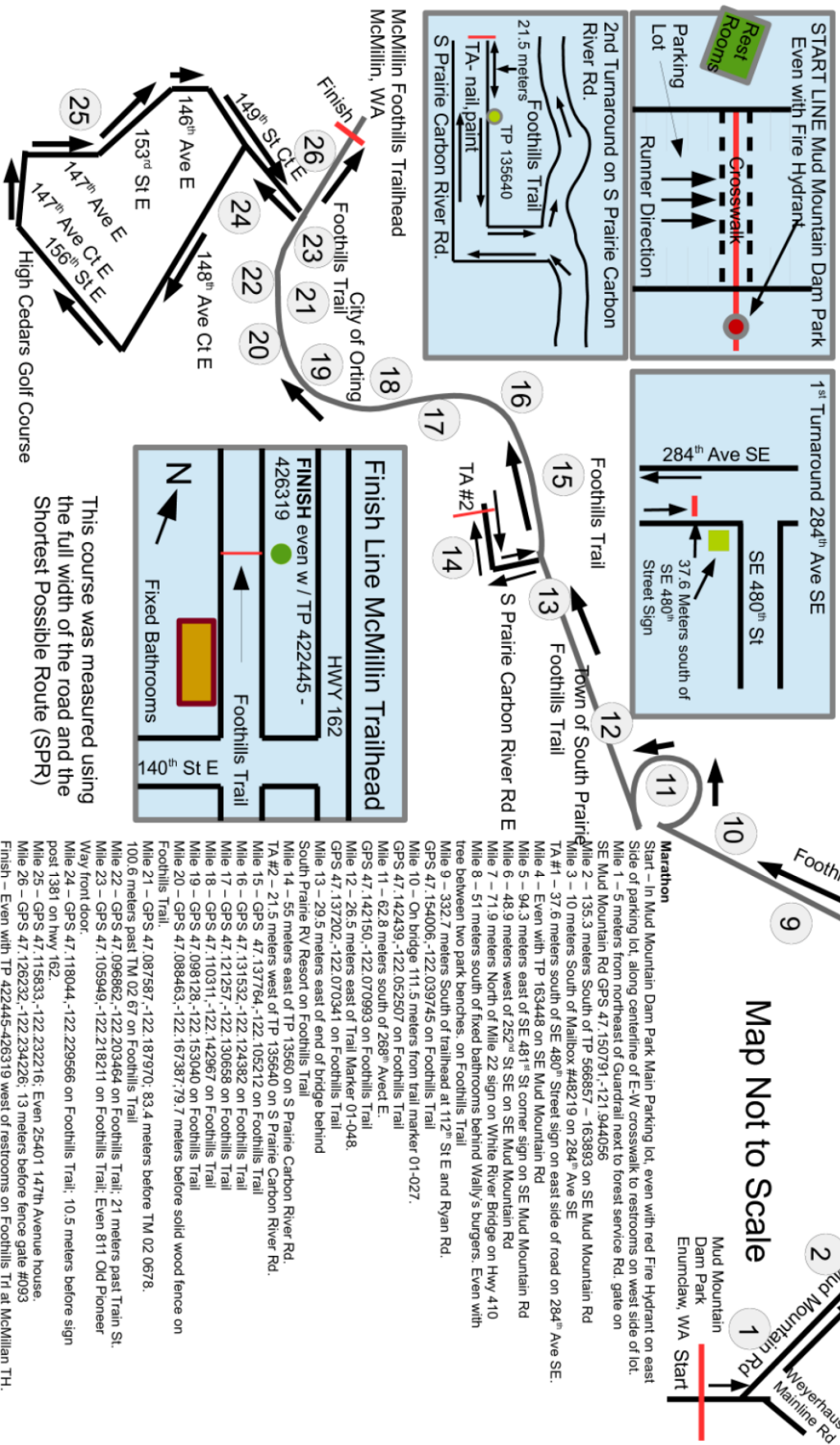

This course was measured using the full width of the road and the Shortest Possible Route (SPR)

- Marathon**
- Start - In Mud Mountain Dam Park Main Parking lot, even with red Fire Hydrant on east side of parking lot, along centerline of E-W crosswalk to restrooms on west side of lot.
  - Mile 1 - 5 meters from northeast of Guardrail next to forest service Rd. gate on SE Mud Mountain Rd GPS 47.150791, -121.944056
  - Mile 2 - 135.3 meters South of TP 566857 - 163893 on SE Mud Mountain Rd
  - Mile 3 - 10 meters South of Mailbox #48219 on 284th Ave SE
  - Mile 4 - Even with TP 163448 on SE Mud Mountain Rd
  - Mile 5 - 37.6 meters south of SE 480th Street sign on east side of road on 284th Ave SE.
  - Mile 6 - 48.9 meters west of 252nd St SE on SE Mud Mountain Rd
  - Mile 7 - 11.9 meters North of Mile 22 sign on White River Bridge on Hwy 410
  - Mile 8 - 51 meters south of fixed bathrooms behind Walley's burgers. Even with tree between two park benches. on Foothills Trail
  - Mile 9 - 332.7 meters South of trailhead at 112nd St E and Ryan Rd.
  - GPS 47.154006, -122.039745 on Foothills Trail
  - Mile 10 - On bridge 111.5 meters from trail marker 01-027.
  - GPS 47.142439, -122.052507 on Foothills Trail
  - Mile 11 - 62.8 meters south of 268th Aved E.
  - GPS 47.142150, -122.070993 on Foothills Trail
  - Mile 12 - 26.5 meters east of Trail Marker 01-048.
  - GPS 47.137202, -122.070341 on Foothills Trail
  - Mile 13 - 29.5 meters east of end of bridge behind South Prairie RV Resort on Foothills Trail
  - Mile 14 - 55 meters east of TP 13560 on S Prairie Carbon River Rd.
  - TA#2 - 21.5 meters west of TP 135640 on S Prairie Carbon River Rd.
  - Mile 15 - GPS 47.137764, -122.105212 on Foothills Trail
  - Mile 16 - GPS 47.131532, -122.124382 on Foothills Trail
  - Mile 17 - GPS 47.121257, -122.130658 on Foothills Trail
  - Mile 18 - GPS 47.110311, -122.142967 on Foothills Trail
  - Mile 19 - GPS 47.098128, -122.153040 on Foothills Trail
  - Mile 20 - GPS 47.088463, -122.167387, 79.7 meters before solid wood fence on Foothills Trail.
  - Mile 21 - GPS 47.087587, -122.187970, 83.4 meters before TM 02 0678.
  - 100.6 meters past TM 02 67 on Foothills Trail
  - Mile 22 - GPS 47.096862, -122.203464 on Foothills Trail, 21 meters past Train St.
  - Mile 23 - GPS 47.105949, -122.218211 on Foothills Trail, Even 811 Old Pioneer Way front door.
  - Mile 24 - GPS 47.118044, -122.229566 on Foothills Trail, 10.5 meters before sign post 1381 on Hwy 162
  - Mile 25 - GPS 47.115833, -122.232216, Even 25401 147th Avenue house.
  - Mile 26 - GPS 47.126232, -122.234226, 13 meters before fence gate #093
  - Finish - Even with TP 422445-426319 west of restrooms on Foothills Trl at McMillan TH.