



Road Running Technical Council
USA Track & Field

Measurement Certificate



Name of the course Walt Disney World Marathon Distance 42.195km

Location (state) FL (city) Lake Buena Vista

Type of course: Road Race

Measuring Methods: Bike

Measured By Toni Youngman (IAAF-A), Tom Ward (IAAF-B), 1013 Montana Street, Orlando FL 32803, 407-761-4918, toniyoungman@trackshack.com

Race Contact Jon Hughes, 1013 Montana Street, Orlando FL 32803, 407-896-1160, jon@trackshack.com

Date(s) when course measured: 11/21/2019, 11/22/2019

Number of measurements of entire course: 2 Course Configuration: loop

Elevation (meters above sea level) Start 30m Finish 29m Lowest 22m Highest 36m

Straight line distance between start and finish 542m Drop 0.02 m/km Separation 1.28 %

Type of surface: Paved 100 % Dirt 0 % Gravel 0 % Grass 0 % Track 0 %

Effective date of certification: December 31, 2019 Certification code: FL20001JK

Note to Race Director: Use this Certification Code in all public announcements relating to your race.

Be It Officially Noted That

Based on examination of data provided by the above named measurer, the course described above and in the map attached is hereby certified as reasonably accurate in measurement according to the standards adopted by the Road Running Technical Council. If any changes are made to the course, this certification becomes void, and the course must then be recertified.

Verification of Course --- In the event a National Open Record is set on the course, or at the discretion of USA Track & Field, a verification measurement may be required to be performed by a member of the Road Running Technical Council. If such a remeasurement shows the course to be short, then all pending records will be rejected and the course certification will be cancelled.

This certification expires on December 31 of the year: **2030**

AS NATIONALLY CERTIFIED BY:

Date: January 8, 2020

Justin Kuo - USATF/RRTC Certifier - 39 Oakland Rd, Brookline MA 02445
(617) 487-4463 - jkuo+certifier@usatfne.org

Walt Disney World Marathon

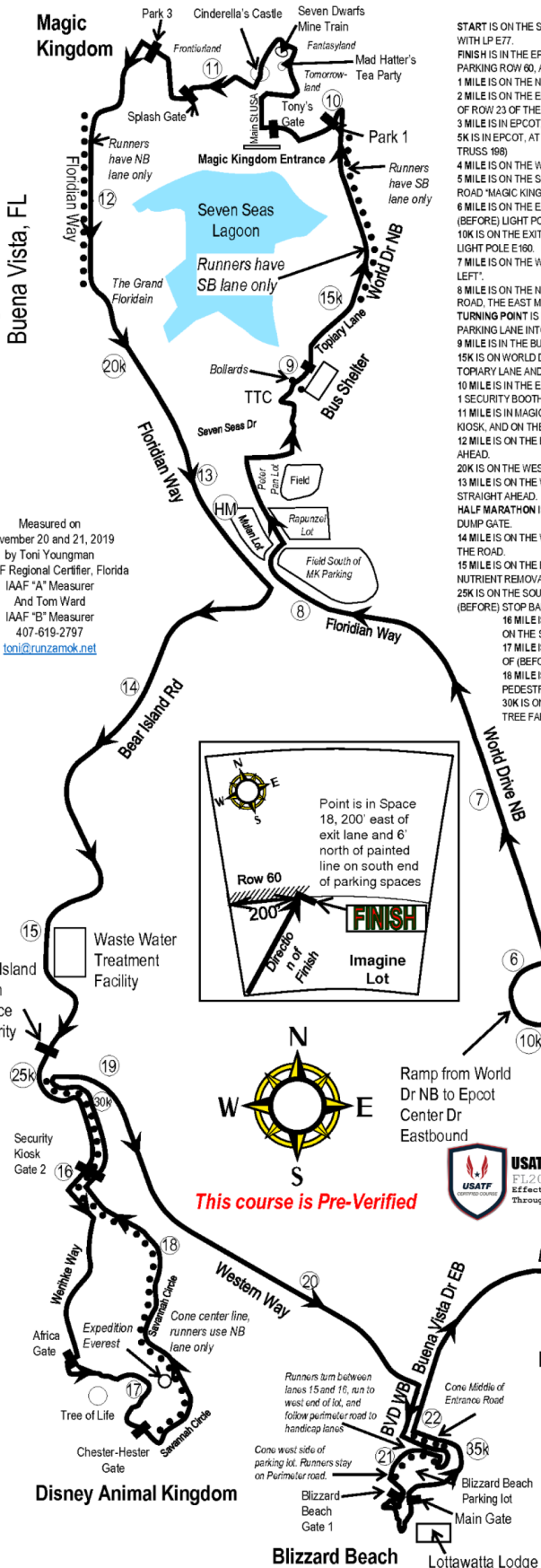

KEY POINTS

- START IS ON THE SOUTH SIDE OF EPCOT CENTER DRIVE (ECD) WESTBOUND, FACING WEST. POINT IS 68' WEST OF LINE WITH LP E75 AND 107' EAST OF LINE WITH LP E77.
- FINISH IS IN THE EPCOT IMAGINE PARKING LOT, FACING NORTHEAST. POINT IS 200' EAST OF THE EXIT LANE OF THE PARKING LOT AT THE SOUTH SIDE OF PARKING ROW 60, AT THE 18" PARKING SPACE FROM THE WEST END OF THE ROW, AND 6 FEET NORTH OF THE SOUTH EDGE OF THE SOLID LINE OF THE ROW.
- 1 MILE IS ON THE NORTH SIDE OF ECD WESTBOUND EXIT RAMP TO EPCOT AUTOPLAZA, FACING WEST. POINT IS 35.2' EAST OF (BEFORE) LIGHT POLE EL219.
- 2 MILE IS ON THE EPCOT PARKING LOT PERIMETER ROAD ON THE EAST SIDE OF THE DISCOVER LOT, FACING SOUTH. POINT IS IN LINE WITH THE NORTH END OF ROW 23 OF THE DISCOVER LOT.
- 3 MILE IS IN EPCOT, ON THE SOUTH END OF INNOVENTIONS WEST, FACING EAST. POINT IS 48.2' EAST OF (AFTER) OVERHEAD MONORAIL BEAM.
- 5K IS IN EPCOT, AT THE NORTH END OF THE 'LIGHTS OF WINTER' BRIDGE, FACING SOUTH. POINT IS 45.4' NORTH OF (BEFORE) MONORAIL BEAM (MONORAIL TRUSS 198).
- 4 MILE IS ON THE WEST SIDE OF EPCOT CENTER DRIVE EASTBOUND, FACING NORTH. POINT IS 16.2' SOUTH OF (BEFORE) LIGHT POLE E48.
- 5 MILE IS ON THE SOUTH SIDE OF EPCOT CENTER DRIVE EASTBOUND, FACING WEST. POINT IS 10' EAST OF (BEFORE) SIGN ON WESTBOUND SIDE OF THE ROAD 'MAGIC KINGDOM, MAGIC KINGDOM RESORTS, DISNEY'S ANIMAL KINGDOM, DISNEY HOLLYWOOD STUDIO, LEFT LANE'.
- 6 MILE IS ON THE EXIT RAMP FROM WORLD DRIVE SOUTHBOUND TO EPCOT CENTER DRIVE EASTBOUND, FACING SOUTHWEST. POINT IS 26.9' EAST OF (BEFORE) LIGHT POLE E152.
- 10K IS ON THE EXIT RAMP FROM WORLD DRIVE SOUTHBOUND TO EPCOT CENTER DRIVE EASTBOUND, FACING SOUTHWEST. POINT IS 120.4' EAST OF (AFTER) LIGHT POLE E160.
- 7 MILE IS ON THE WEST SIDE OF WORLD DRIVE SOUTHBOUND, FACING NORTH. POINT IS 188' NORTH OF (AFTER) SIGN 'RETURN TO MAGIC KINGDOM, NEXT LEFT'.
- 8 MILE IS ON THE NORTH SIDE OF FLORIDIAN WAY, FACING NORTHWEST. POINT IS 68.8' EAST OF (BEFORE) PAINTED MERGE ON THE SOUTH SIDE OF THE ROAD. THE EAST MOST PAINTED MERGE.
- TURNING POINT IS IN THE WDM MAGIC KINGDOM PARKING PETER PAN PARKING LOT, AT THE NORTHWEST SIDE OF PARKING ROW 210, ENTERING FROM THE PARKING LANE INTO THE LOT. POINT IS 70' 6" SOUTH OF THE NORTH CURB OF THE PARKING LOT.
- 9 MILE IS IN THE BUS TURNAROUND LOOP AT TTC, FACING NORTHEAST. POINT IS 113' EAST OF (AFTER) THE BOLLARDS.
- 15K IS ON WORLD DRIVE NORTHBOUND, FACING NORTH. POINT IS 194.2' NORTH OF (AFTER) THE NORTH TIP OF THE MEDIAN AT THE INTERSECTION OF TOPIARY LANE AND WORLD DRIVE.
- 10 MILE IS IN THE ENTRANCE OF PARK 1 SECURITY BOOTH FOR BACKSTAGE MAGIC KINGDOM, FACING SOUTHWEST. POINT IS 15.8' NORTH OF (BEFORE) PARK 1 SECURITY BOOTH.
- 11 MILE IS IN MAGIC KINGDOM, BETWEEN LIBERTY SQUARE AND FRONTIERLAND, FACING WEST. POINT IS IN LINE WITH 'GETAWAY, DISNEY VACATION CLUB' KIOSK, AND ON THE BRIDGE BETWEEN LIBERTY SQUARE AND FRONTIERLAND, 5' EAST OF (BEFORE) THE WEST END OF THE BRIDGE.
- 12 MILE IS ON THE EAST SIDE OF FLORIDIAN WAY, FACING SOUTH. POINT IS 294' NORTH OF (BEFORE) THE 1-4/192 SIGN WITH AN ARROW POINTING STRAIGHT AHEAD.
- 20K IS ON THE WEST SIDE OF FLORIDIAN WAY, FACING SOUTH. POINT IS 99.8' NORTH OF (BEFORE) THE WEDDING PAVILLION.
- 13 MILE IS ON THE WEST SIDE OF FLORIDIAN WAY FACING SOUTHEAST. POINT IS 291.8' NORTH OF (BEFORE) SIGN 'MAGIC KINGDOM PARKING, TO 1-4/192, STRAIGHT AHEAD. THIS SIGN IS NORTH OF (BEFORE) MULAN DUMP GATE.
- HALF MARATHON IS ON THE WEST SIDE OF FLORIDIAN WAY, FACING SOUTH EAST. POINT IS 51.2' SOUTH OF (AFTER) PAVED DRIVEWAY ENTRANCE TO MULAN DUMP GATE.
- 14 MILE IS ON THE WEST SIDE OF BEAR ISLAND ROAD, FACING SOUTH. POINT IS 136' SOUTH OF (AFTER) THE DOUBLE RED BOLLARDS ON THE EAST SIDE OF THE ROAD.
- 15 MILE IS ON THE EAST SIDE OF BEAR ISLAND ROAD, FACING SOUTH. POINT IS 17.6' NORTH OF (BEFORE) THE NORTHWEST CORNER OF THE BIOLOGICAL NUTRIENT REMOVAL BASINS (BLUE SIGN INDICATING BUILDING).
- 25K IS ON THE SOUTH SIDE AND CENTER OF THE INTERSECTION OF BEAR ISLAND ROAD AND WESTERN WAY, FACING SOUTH. POINT IS 23.3' NORTH OF (BEFORE) STOP BAR ON THE SOUTHEAST CORNER OF THE INTERSECTION.
- 16 MILE IS AT THE SECURITY GATE 2 LIFT PAD ON INBOUND LANE, IN LINE WITH THE MIDDLE BOLLARD ON THE WEST SIDE OF THE PAD.
- 17 MILE IS IN DISNEY ANIMAL KINGDOM, AT THE NORTH END OF THE BRIDGE BETWEEN EVEREST AND THEATRE IN THE WILD. POINT IS 38' NORTH OF (BEFORE) NORTH END OF BRIDGE.
- 18 MILE IS ON THE EAST SIDE OF SAVANNAH CIRCLE, FACING NORTHWEST. POINT IS 103.2' SOUTH OF (BEFORE) CONVEX MIRROR, NEXT TO THE PEDESTRIAN WALKWAY AND 15 MPH SIGN, IN FRONT OF THE ANIMAL NUTRITION CENTER.
- 30K IS ON THE EAST SIDE OF BEAR ISLAND ROAD, FACING NORTH. POINT IS 113' NORTH OF (AFTER) LINE WITH NORTHERNMOST GATE OF THE TREE FARM, WITH LIGHT POLE H2 JUST INSIDE THE GATE.
- 19 MILE IS ON THE SOUTH SIDE OF WESTERN WAY EASTBOUND, FACING EAST. POINT IS 47.8' WEST OF (BEFORE) LINE WITH LIGHT POLE WW58.
- 20 MILE IS ON THE SOUTH SIDE OF WESTERN WAY EASTBOUND, FACING EAST. POINT IS 46' WEST OF (BEFORE) LINE WITH LIGHT POLE WW99.
- 21 MILE IS ON THE PARKING LOT PERIMETER ROAD OF BLIZZARD BEACH, ON THE WEST SIDE OF THE LOT, FACING SOUTHWEST. POINT IS IN LINE WITH THE END OF ROW 13, AND 23.2' SOUTH OF (AFTER) THE SIGN 'HANDICAP PARKING ONLY-FOLLOW THE BLUE LINE'.
- 35K IS ON THE EXIT LANE FROM BLIZZARD BEACH TO BUENA VISTA DR, FACING NORTHWEST. POINT IS 57' WEST OF (BEFORE) LIGHT POLE BVE254.
- 22 MILE IS ON THE EAST SIDE BUENA VISTA DR, EASTBOUND, FACING NORTH. POINT IS 26.2' NORTH OF (AFTER) LIGHT POLE BVE310.
- 23 MILE IS ON THE SOUTH SIDE OF BUENA VISTA DRIVE EASTBOUND, FACING EAST. POINT IS 57' WEST OF (BEFORE) LIGHT POLE BVE254.
- 24 MILE IS ON THE EAST SIDE OF THE BOARDWALK PATH FROM DISNEY HOLLYWOOD STUDIOS TO EPCOT, FACING NORTH. POINT IS 98' NORTH OF (AFTER) SIDEWALK TO TENNIS COURTS.
- 40K IS ON BACKSTAGE EPCOT, UK J WORLD SHOWCASE, FACING EAST, TOWARD UK GATE. POINT IS IN LINE WITH THE WEST FACING SIDE OF WALK-IN FREEZER FOR UNITED KINGDOM FOOD AND BEVERAGE. POINT IS IN LINE WITH THE SIGN 'UK FOOD AND BEVERAGE, FOR AFTER HOURS DELIVERIES'.
- 25 MILE IS IN EPCOT, ON WORLD SHOWCASE. ON UK-FRANCE BRIDGE, FACING FRANCE. POINT IS 28.6' SOUTH OF (AFTER) ENTRANCE PATH TO FRENCH ISLAND.
- 26 MILE IS ON BACKSTAGE EPCOT, ON SOUTH SIDE OF AVENUE OF THE STARS, FACING WEST. POINT IS 24' WEST OF (AFTER) THE WEST FACING WALL OF 'THE GUARDIANS OF THE GALAXY' BUILDING.

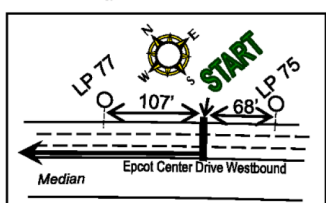
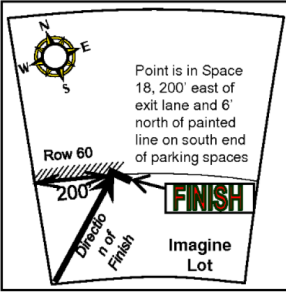

Measured on November 20 and 21, 2019 by Toni Youngman USATF Regional Certifier, Florida IAAF 'A' Measurer And Tom Ward IAAF 'B' Measurer 407-619-2797 toni@runzamik.net



This course is Pre-Verified

Walt Disney World MARATHON

KEY POINTS

Measured on
November 20 and 21, 2019
by Toni Youngman
USATF Regional Certifier, Florida
IAAF "A" Measurer
And Tom Ward
IAAF "B" Measurer
Maps December 2019

Supplemental Map 1 of 21

START IS ON THE SOUTH SIDE OF EPCOT CENTER DRIVE (ECD) WESTBOUND, FACING WEST. POINT IS 68' WEST OF LINE WITH LP E75 AND 107' EAST OF LINE WITH LP E77.

FINISH IS IN THE EPCOT IMAGINE PARKING LOT, FACING NORTHEAST. POINT IS 200' EAST OF THE EXIT LANE OF THE PARKING LOT AT THE SOUTH SIDE OF PARKING ROW 60, AT THE 18TH PARKING SPACE FROM THE WEST END OF THE ROW, AND 6 FEET NORTH OF THE SOUTH EDGE OF THE SOLID LINE OF THE ROW.

1 MILE IS ON THE NORTH SIDE OF ECD WESTBOUND EXIT RAMP TO EPCOT AUTOPLAZA, FACING WEST. POINT IS 35.2' EAST OF (BEFORE) LIGHT POLE EL219.

2 MILE IS ON THE EPCOT PARKING LOT PERIMETER ROAD ON THE EAST SIDE OF THE DISCOVER LOT, FACING SOUTH. POINT IS IN LINE WITH THE NORTH END OF ROW 23 OF THE DISCOVER LOT.

3 MILE IS IN EPCOT, ON THE SOUTH END OF INNOVENTIONS WEST, FACING EAST. POINT IS 48.2' EAST OF (AFTER) OVERHEAD MONORAIL BEAM.

5K IS IN EPCOT, AT THE NORTH END OF THE "LIGHTS OF WINTER" BRIDGE, FACING SOUTH. POINT IS 45.4' NORTH OF (BEFORE) MONORAIL BEAM (MONORAIL TRUSS 198)

4 MILE IS ON THE WEST SIDE OF EPCOT CENTER DRIVE EASTBOUND, FACING NORTH. POINT IS 16.2' SOUTH OF (BEFORE) LIGHT POLE E48.

5 MILE IS ON THE SOUTH SIDE OF EPCOT CENTER DRIVE EASTBOUND, FACING WEST. POINT IS 10' EAST OF (BEFORE) SIGN ON WESTBOUND SIDE OF THE ROAD "MAGIC KINGDOM, MAGIC KINGDOM RESORTS, DISNEY'S ANIMAL KINGDOM, DISNEY HOLLYWOOD STUDIO, LEFT LANE".

6 MILE IS ON THE EXIT RAMP FROM WORLD DRIVE SOUTHBOUND TO EPCOT CENTER DRIVE EASTBOUND, FACING SOUTHWEST. POINT IS 26.9' EAST OF (BEFORE) LIGHT POLE E152.

10K IS ON THE EXIT RAMP FROM WORLD DRIVE SOUTHBOUND TO EPCOT CENTER DRIVE EASTBOUND, FACING SOUTHEAST. POINT IS 120.4' EAST OF (AFTER) LIGHT POLE E160.

7 MILE IS ON THE WEST SIDE OF WORLD DRIVE SOUTHBOUND, FACING NORTH. POINT IS 188' NORTH OF (AFTER) SIGN "RETURN TO MAGIC KINGDOM, NEXT LEFT".

8 MILE IS ON THE NORTH SIDE OF FLORIDIAN WAY, FACING NORTHWEST. POINT IS 68.8' EAST OF (BEFORE) PAINTED MERGE ON THE SOUTH SIDE OF THE ROAD, THE EAST MOST PAINTED MERGE.

TURNING POINT IS IN THE WDW MAGIC KINGDOM PARKING PETER PAN PARKING LOT, AT THE NORTHWEST SIDE OF PARKING ROW 210, ENTERING FROM THE PARKING LANE INTO THE LOT. POINT IS 70'-6" SOUTH OF THE NORTH CURB OF THE PARKING LOT.

9 MILE IS IN THE BUS TURNAROUND LOOP AT TTC, FACING NORTHEAST. POINT IS 113' EAST OF (AFTER) THE BOLLARDS.

15K IS ON WORLD DRIVE NORTHBOUND, FACING NORTH. POINT IS 194.2' NORTH OF (AFTER) THE NORTH TIP OF THE MEDIAN AT THE INTERSECTION OF TOPIARY LANE AND WORLD DRIVE.

10 MILE IS IN THE ENTRANCE OF PARK 1 SECURITY BOOTH FOR BACKSTAGE MAGIC KINGDOM, FACING SOUTHWEST. POINT IS 15.8' NORTH OF (BEFORE) PARK 1 SECURITY BOOTH.

11 MILE IS IN MAGIC KINGDOM, BETWEEN LIBERTY SQUARE AND FRONTIERLAND, FACING WEST. POINT IS IN LINE WITH "GETAWAY, DISNEY VACATION CLUB" KIOSK, AND ON THE BRIDGE BETWEEN LIBERTY SQUARE AND FRONTIERLAND, 5' EAST OF (BEFORE) THE WEST END OF THE BRIDGE.

12 MILE IS ON THE EAST SIDE OF FLORIDIAN WAY, FACING SOUTH. POINT IS 294' NORTH OF (BEFORE) THE I-4/192 SIGN WITH AN ARROW POINTING STRAIGHT AHEAD.

20K IS ON THE WEST SIDE OF FLORIDIAN WAY, FACING SOUTH. POINT IS 59.6' NORTH OF (BEFORE) THE WEDDING PAVILLION

13 MILE IS ON THE WEST SIDE OF FLORIDIAN WAY FACING SOUTHEAST. POINT IS 291.6' NORTH OF (BEFORE) SIGN "MAGIC KINGDOM PARKING, TO I-4/192, STRAIGHT AHEAD. THIS SIGN IS NORTH OF (BEFORE) MULAN DUMP GATE.

HALF MARATHON IS ON THE WEST SIDE OF FLORIDIAN WAY, FACING SOUTH EAST. POINT IS 51.2' SOUTH OF (AFTER) PAVED DRIVEWAY ENTRANCE TO MULAN DUMP GATE.

14 MILE IS ON THE WEST SIDE OF BEAR ISLAND ROAD, FACING SOUTH. POINT IS 136' SOUTH OF (AFTER) THE DOUBLE RED BOLLARDS ON THE EAST SIDE OF THE ROAD.

15 MILE IS ON THE EAST SIDE OF BEAR ISLAND ROAD, FACING SOUTH. POINT IS 17.6' NORTH OF (BEFORE) THE NORTHWEST CORNER OF THE BIOLOGICAL NUTRIENT REMOVAL BASINS (BLUE SIGN INDICATING BUILDING).

25K IS ON THE SOUTH SIDE AND CENTER OF THE INTERSECTION OF BEAR ISLAND ROAD AND WESTERN WAY, FACING SOUTH. POINT IS 23.3' NORTH OF (BEFORE) STOP BAR ON THE SOUTHEAST CORNER OF THE INTERSECTION.

16 MILE IS AT THE SECURITY KIOSK/GATE 2 DAK AT THE INTERSECTION OF BEAR ISLAND ROAD AND SAVANNAH CIRCLE, FACING SOUTH. POINT IS ON THE SECURITY GATE 2 LIFT PAD ON INBOUND LANE, IN LINE WITH THE MIDDLE BOLLARD ON THE WEST SIDE OF THE PAD.

17 MILE IS IN DISNEY ANIMAL KINGDOM, AT THE NORTH END OF THE BRIDGE BETWEEN EVEREST AND THEATRE IN THE WILD. POINT IS 38' NORTH OF (BEFORE) NORTH END OF BRIDGE.

18 MILE IS ON THE EAST SIDE OF SAVANNAH CIRCLE, FACING NORTHWEST. POINT IS 103.2' SOUTH OF (BEFORE) CONVEX MIRROR, NEXT TO THE PEDESTRIAN WALKWAY AND 15 MPH SIGN, IN FRONT OF THE ANIMAL NUTRITION CENTER

30K IS ON THE EAST SIDE OF BEAR ISLAND ROAD, FACING NORTH. POINT IS 113' NORTH OF (AFTER) LINE WITH NORTHERNMOST GATE OF THE TREE FARM, WITH LIGHT POLE H2 JUST INSIDE THE GATE.

19 MILE IS ON THE SOUTH SIDE OF WESTERN WAY EASTBOUND, FACING EAST. POINT IS 47.8' WEST OF (BEFORE) LINE WITH LIGHT POLE WW58.

20 MILE IS ON THE SOUTH SIDE OF WESTERN WAY EASTBOUND, FACING EAST. POINT IS 46' WEST OF (BEFORE) LINE WITH LIGHT POLE WW99.

21 MILE IS ON THE PARKING LOT PERIMETER ROAD OF BLIZZARD BEACH, ON THE WEST SIDE OF THE LOT, FACING SOUTHWEST. POINT IS IN LINE WITH THE END OF ROW 13, AND 23.2' SOUTH OF (AFTER) THE SIGN "HANDICAP PARKING ONLY-FOLLOW THE BLUE LINE".

35K IS ON THE EXIT LANE FROM BLIZZARD BEACH TO BUENA VISTA DR, FACING NORTHWEST. POINT IS 95.2' NORTH OF (AFTER) SIGN "DISNEY TRANSPORT ONLY".

22 MILE IS ON THE EAST SIDE BUENA VISTA DR, EASTBOUND, FACING NORTH. POINT IS 26.2' NORTH OF (AFTER) LIGHT POLE BVE310.

23 MILE IS ON THE SOUTH SIDE OF BUENA VISTA DRIVE EASTBOUND, FACING EAST. POINT IS 57' WEST OF (BEFORE) LIGHT POLE BVE254.

24 MILE IS ON THE EAST SIDE OF THE BOARDWALK PATH FROM DISNEY HOLLYWOOD STUDIOS TO EPCOT, FACING NORTH. POINT IS 98' NORTH OF (AFTER) SIDEWALK TO TENNIS COURTS.

40K IS ON BACKSTAGE EPCOT, UK / WORLD SHOWCASE, FACING EAST, TOWARD UK GATE. POINT IS IN LINE WITH THE WEST FACING SIDE OF WALK-IN FREEZER FOR UNITED KINGDOM FOOD AND BEVERAGE. POINT IS IN LINE WITH THE SIGN "UK FOOD AND BEVERAGE, FOR AFTER HOURS DELIVERIES".

25 MILE IS IN EPCOT, ON WORLD SHOWCASE, ON UK-FRANCE BRIDGE, FACING FRANCE. POINT IS 26.6' SOUTH OF (AFTER) ENTRANCE PATH TO FRENCH ISLAND.

26 MILE IS ON BACKSTAGE EPCOT, ON SOUTH SIDE OF AVENUE OF THE STARS, FACING WEST. POINT IS 24' WEST OF (AFTER) THE WEST FACING WALL OF "THE GUARDIANS OF THE GALAXY" BUILDING.

Walt Disney World Marathon START Map

Supplemental Map 2 of 21

START ON THE SOUTH SIDE OF
EPCOT CENTER DRIVE
WESTBOUND LANES, FACING
WEST. POINT IS 68' WEST OF LINE
WITH LP E75 AND 107' EAST OF
LINE WITH LP E77.

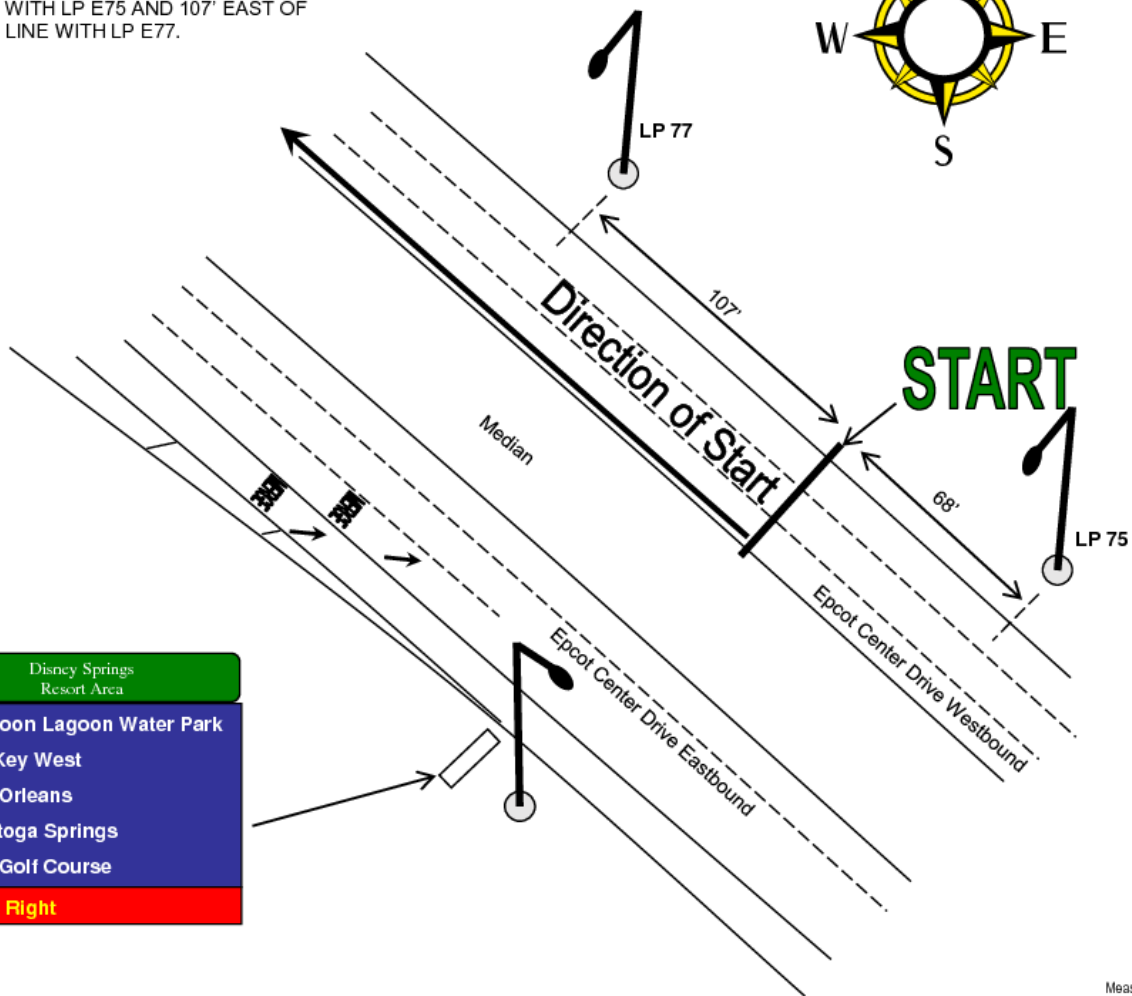
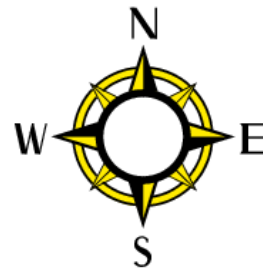

- Disney Springs Resort Area
- Typhoon Lagoon Water Park
- Old Key West
- Port Orleans
- Saratoga Springs
- LBV Golf Course
- Next Right

Measured on
November 20 and 21, 2019
by Toni Youngman
USATF Regional Certifier, Florida
IAAF "A" Measurer
And Tom Ward
IAAF "B" Measurer
Maps December 2019

Walt Disney World Marathon FINISH Map

Supplemental Map 3 of 21

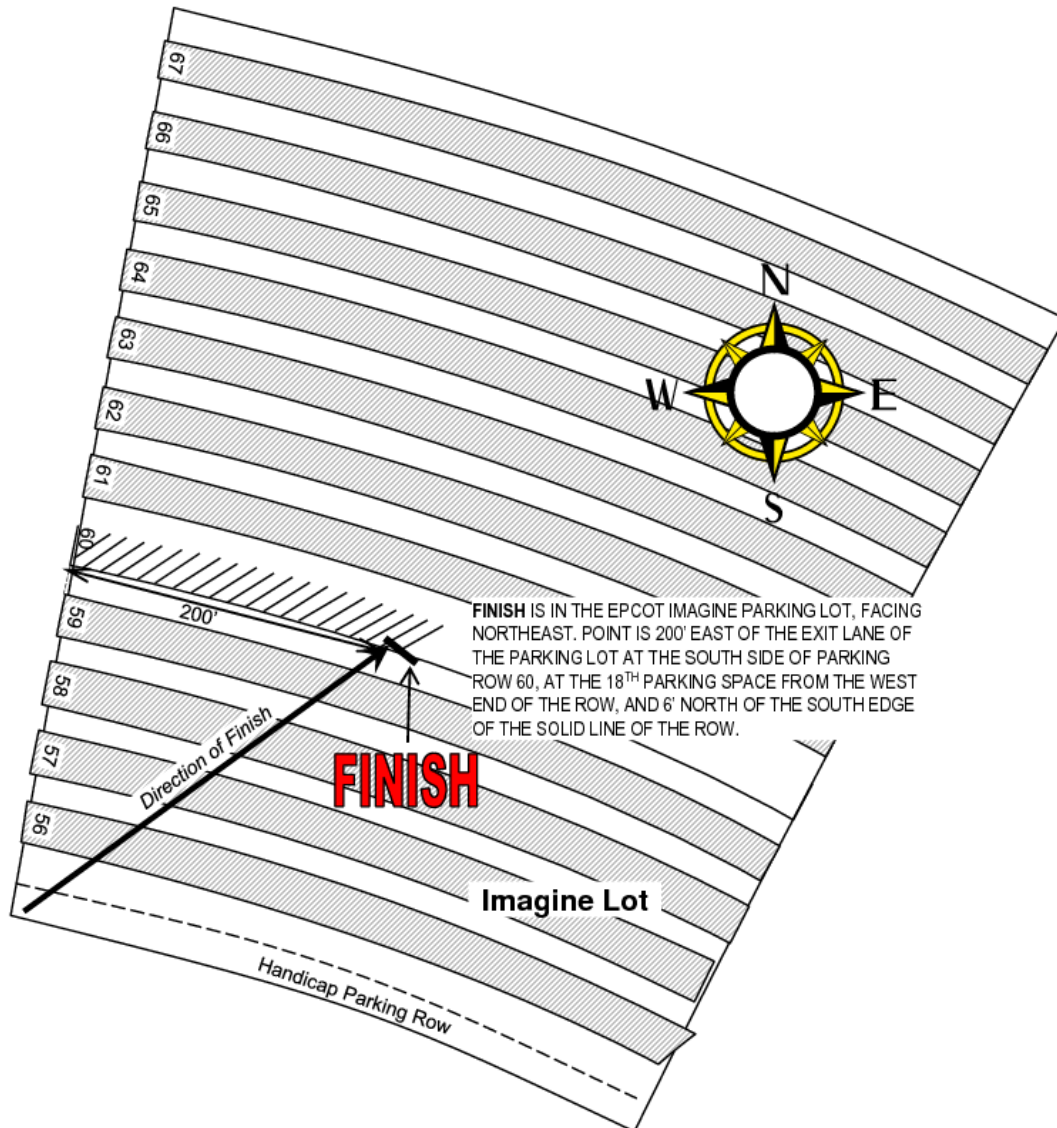

Measured on
November 20 and 21, 2019
by Toni Youngman
USATF Regional Certifier, Florida
IAAF 'A' Measurer
And Tom Ward
IAAF 'B' Measurer
Maps December 2019

Walt Disney World Marathon

Start to 2.1 Mile
4.15 Mile to 5.4 Mile

Supplemental Map 4 of 21

Magic Kingdom Magic Kingdom Resorts Disney's Animal Kingdom Disney Hollywood Studios	Left Lane
---	------------------

1 MILE IS ON THE NORTH SIDE OF ECD WESTBOUND EXIT RAMP TO EPCOT AUTOPLAZA, FACING WEST. POINT IS 35.2' EAST OF (BEFORE) LIGHT POLE EL219.

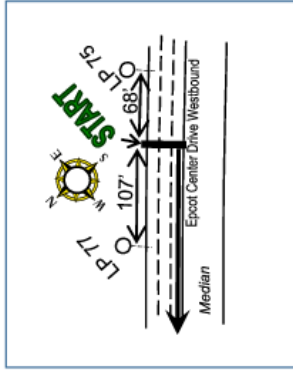

START

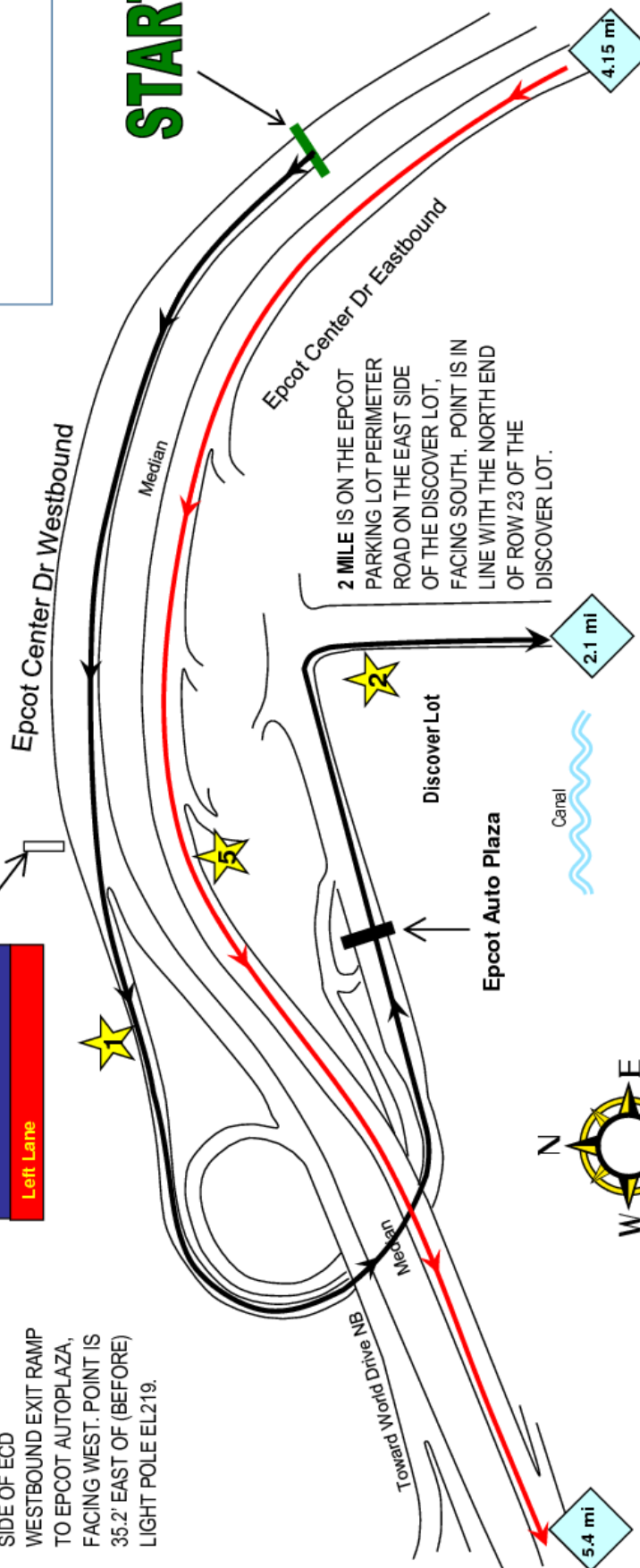

2 MILE IS ON THE EPCOT PARKING LOT PERIMETER ROAD ON THE EAST SIDE OF THE DISCOVER LOT, FACING SOUTH. POINT IS IN LINE WITH THE NORTH END OF ROW 23 OF THE DISCOVER LOT.

START ON THE SOUTH SIDE OF EPCOT CENTER DRIVE WESTBOUND LANES, FACING WEST. POINT IS 68' WEST OF LINE WITH LP E75 AND 107' EAST OF LINE WITH LP E77.

5 MILE IS ON THE SOUTH SIDE OF EPCOT CENTER DRIVE EASTBOUND, FACING WEST. POINT IS 10' EAST OF (BEFORE) SIGN ON WESTBOUND SIDE OF THE ROAD "MAGIC KINGDOM, MAGIC KINGDOM RESORTS, DISNEY'S ANIMAL KINGDOM, DISNEY HOLLYWOOD STUDIOS, LEFT LANE".

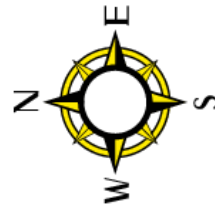

Measured on November 20 and 21, 2019 by Tom Youngman
 USATF Regional Center, Florida
 IAAF "A" Measurer
 And Tom Ward
 IAAF "B" Measurer
 Maps December 2019

Walt Disney World Marathon

2.1 Mile to 3.15 Mile

Supplemental Map 5 of 21

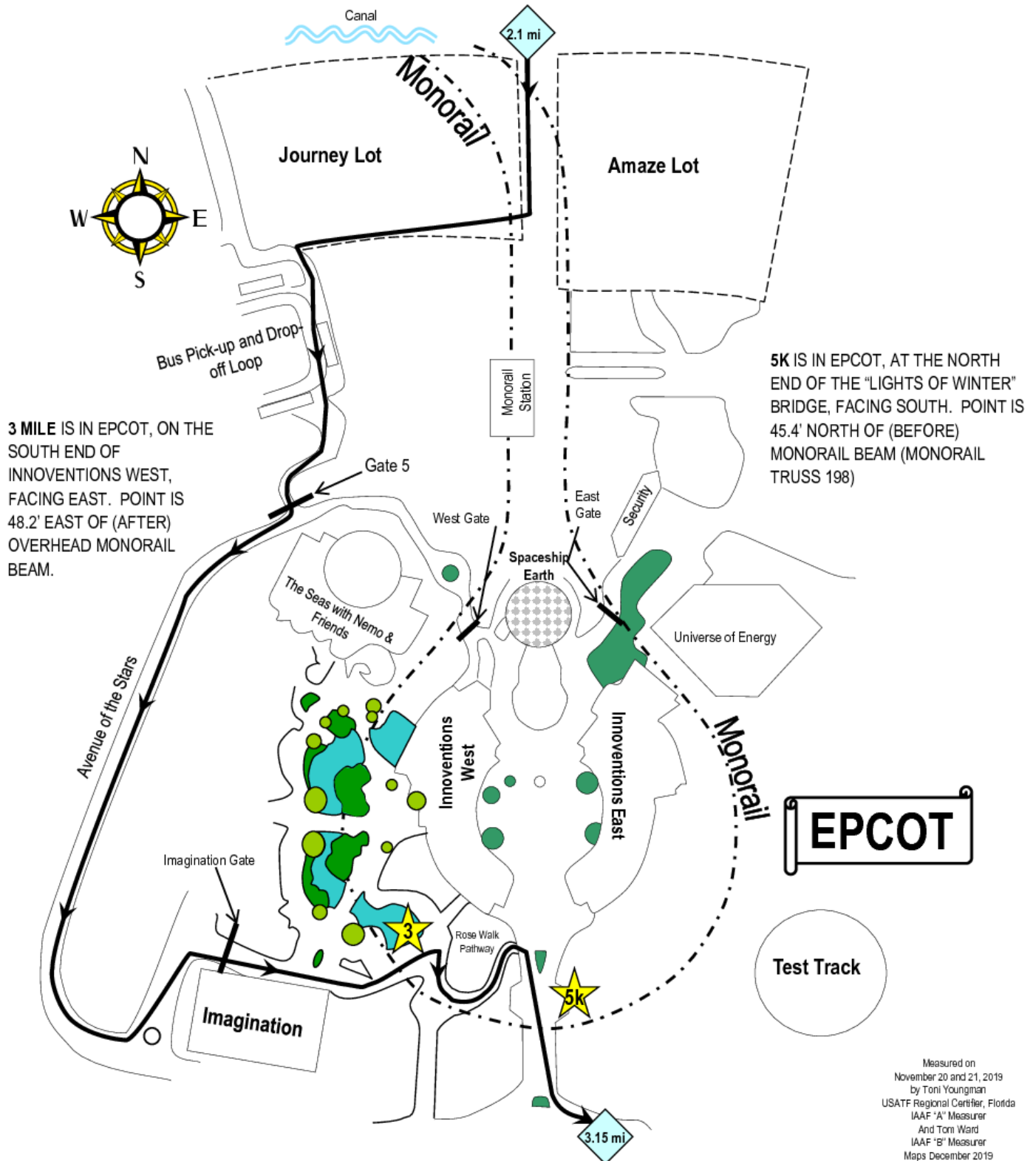

Walt Disney World Marathon

3.15 Mile to 4.15 Mile

25.4 Mile to 25.7 Mile

Supplemental Map 6 of 21

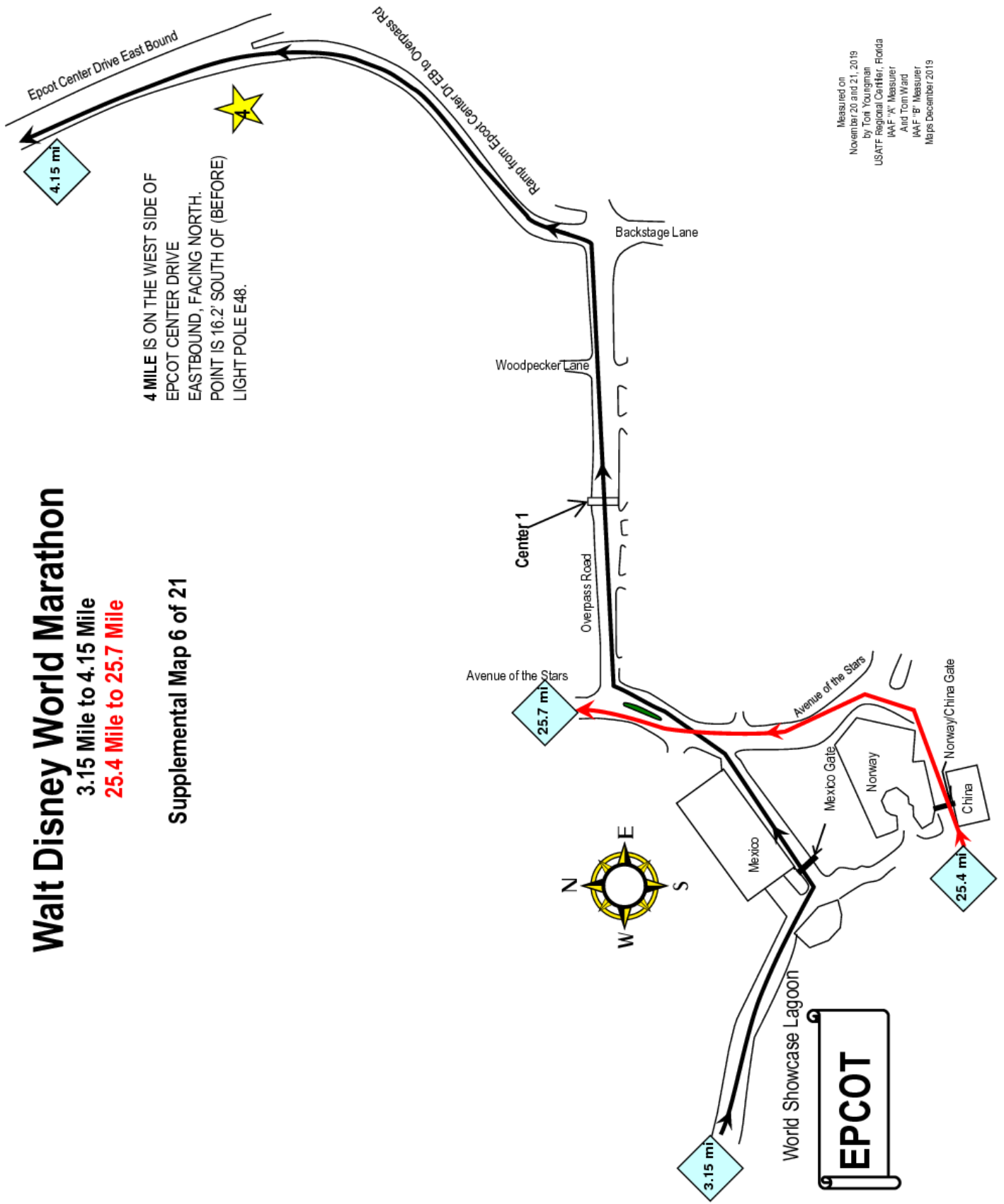

Walt Disney World Marathon

5.4 Mile to 8 Mile

Supplemental Map 7 of 21

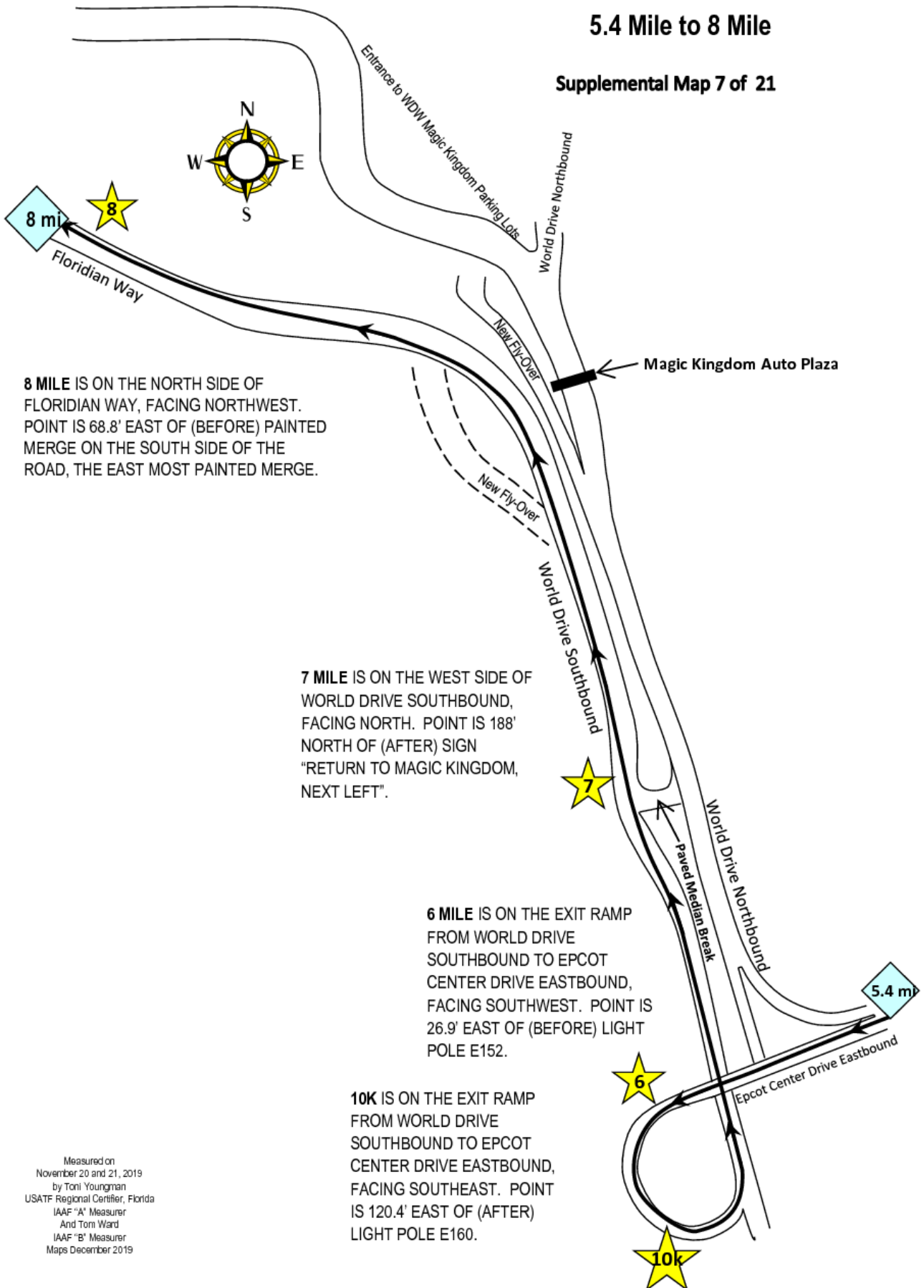

8 MILE IS ON THE NORTH SIDE OF FLORIDIAN WAY, FACING NORTHWEST. POINT IS 68.8' EAST OF (BEFORE) PAINTED MERGE ON THE SOUTH SIDE OF THE ROAD, THE EAST MOST PAINTED MERGE.

7 MILE IS ON THE WEST SIDE OF WORLD DRIVE SOUTHBOUND, FACING NORTH. POINT IS 188' NORTH OF (AFTER) SIGN "RETURN TO MAGIC KINGDOM, NEXT LEFT".

6 MILE IS ON THE EXIT RAMP FROM WORLD DRIVE SOUTHBOUND TO EPCOT CENTER DRIVE EASTBOUND, FACING SOUTHWEST. POINT IS 26.9' EAST OF (BEFORE) LIGHT POLE E152.

10K IS ON THE EXIT RAMP FROM WORLD DRIVE SOUTHBOUND TO EPCOT CENTER DRIVE EASTBOUND, FACING SOUTHEAST. POINT IS 120.4' EAST OF (AFTER) LIGHT POLE E160.

Measured on November 20 and 21, 2019 by Toni Youngman USATF Regional Certifier, Florida IAAF "A" Measurer And Tom Ward IAAF "B" Measurer Maps December 2019

Walt Disney World Marathon

7.9 Mile to 9.4 Mile

Supplemental Map 8 of 21

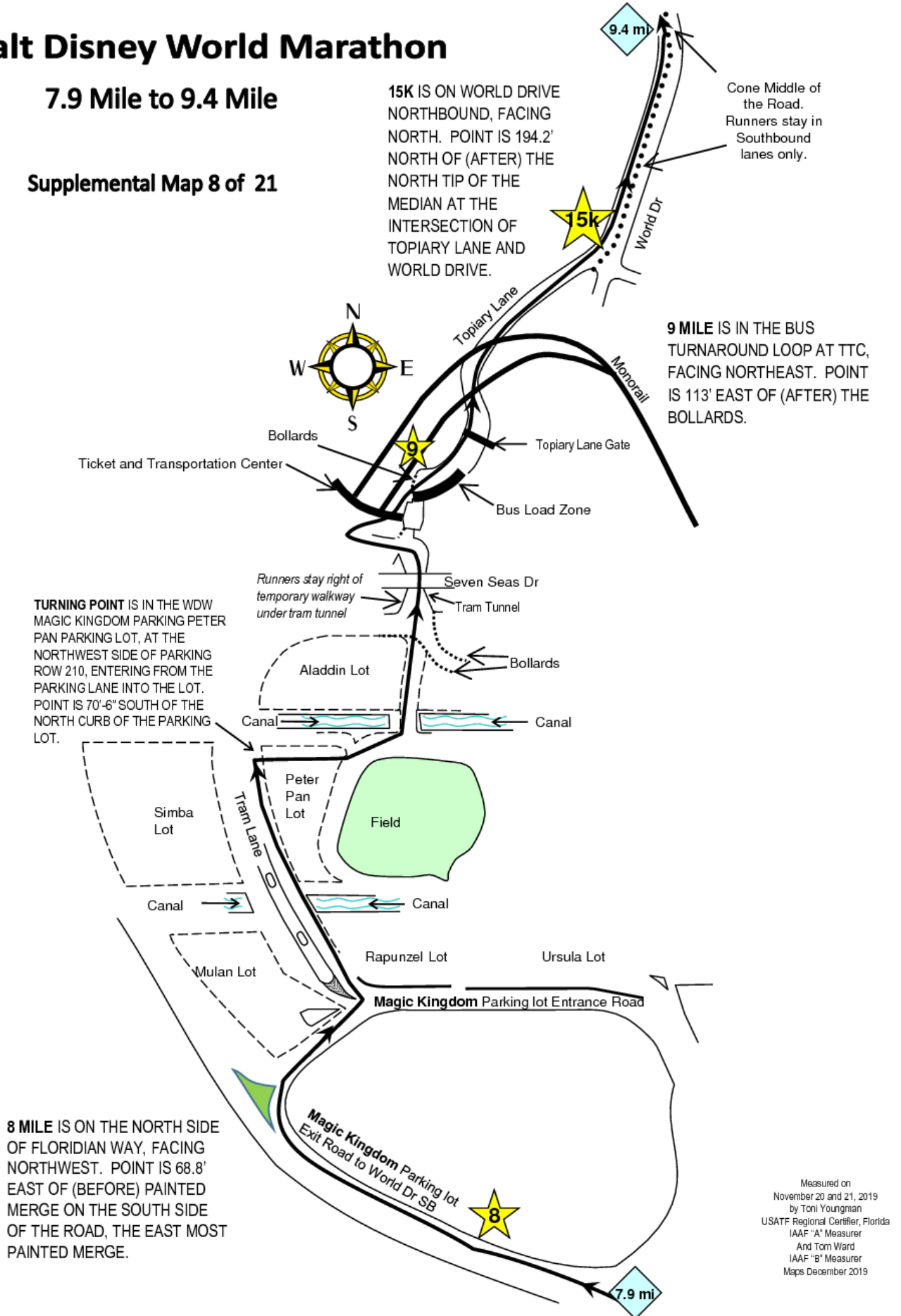

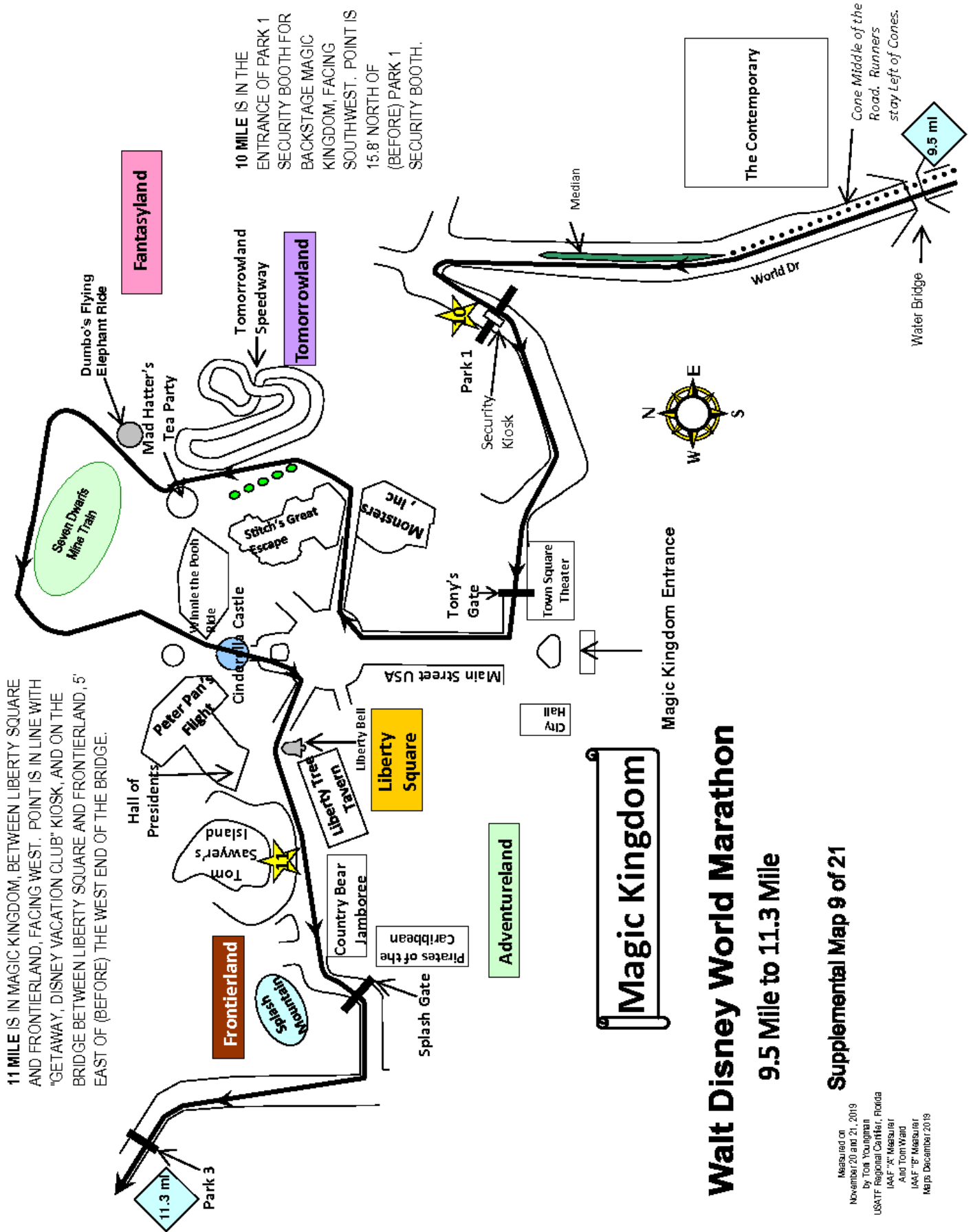

Walt Disney World Marathon

11.2 Mile to 12.8 Mile

Supplemental Map 10 of 21

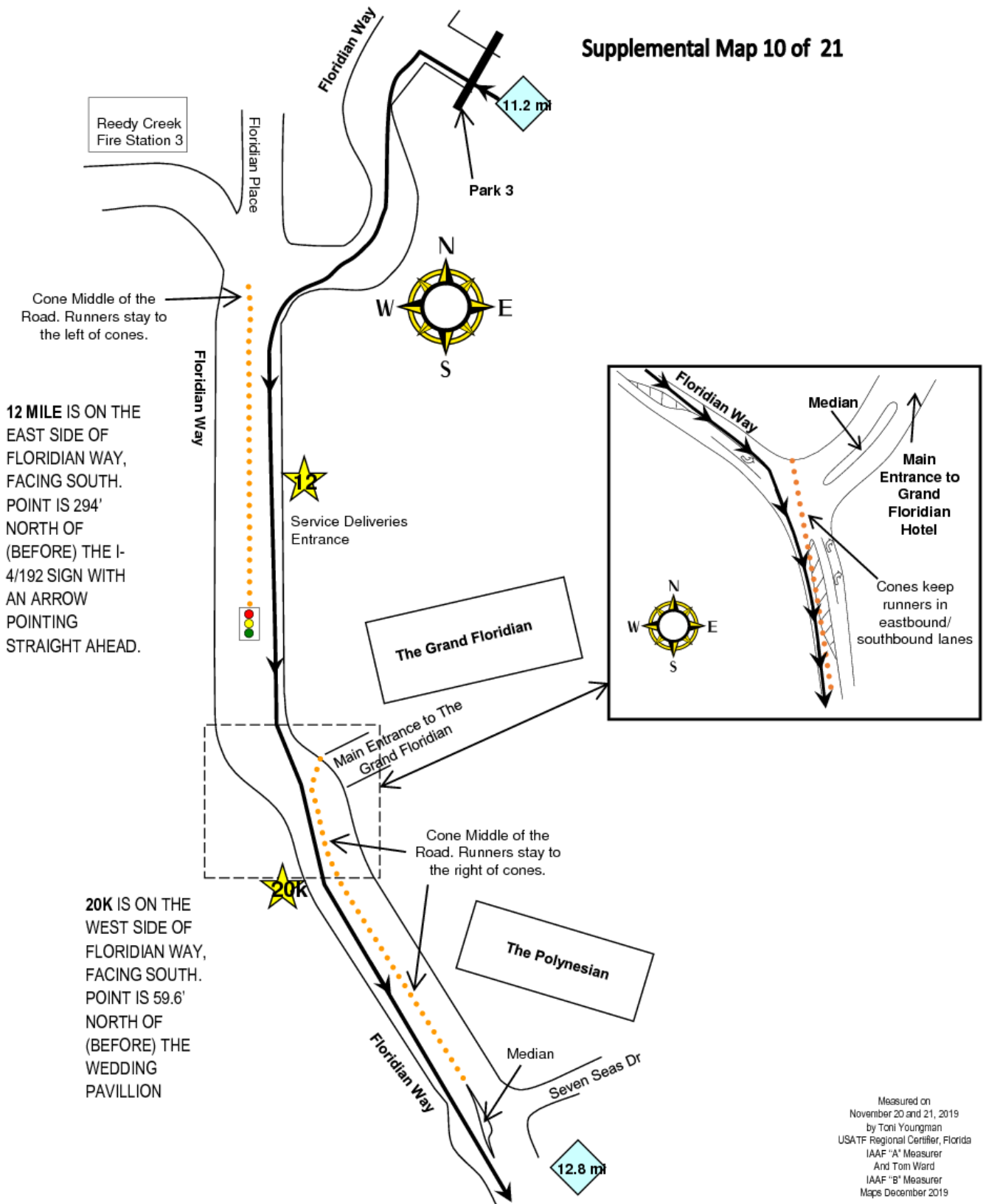

Measured on
November 20 and 21, 2019
by Toni Youngman
USATF Regional Certifier, Florida
IAAF 'A' Measurer
And Tom Ward
IAAF 'B' Measurer
Maps December 2019

Walt Disney World Marathon

7.8 Mile to 8.65 Mile

12.7 Mile to 13.3 Mile

Supplemental Map 11 of 21

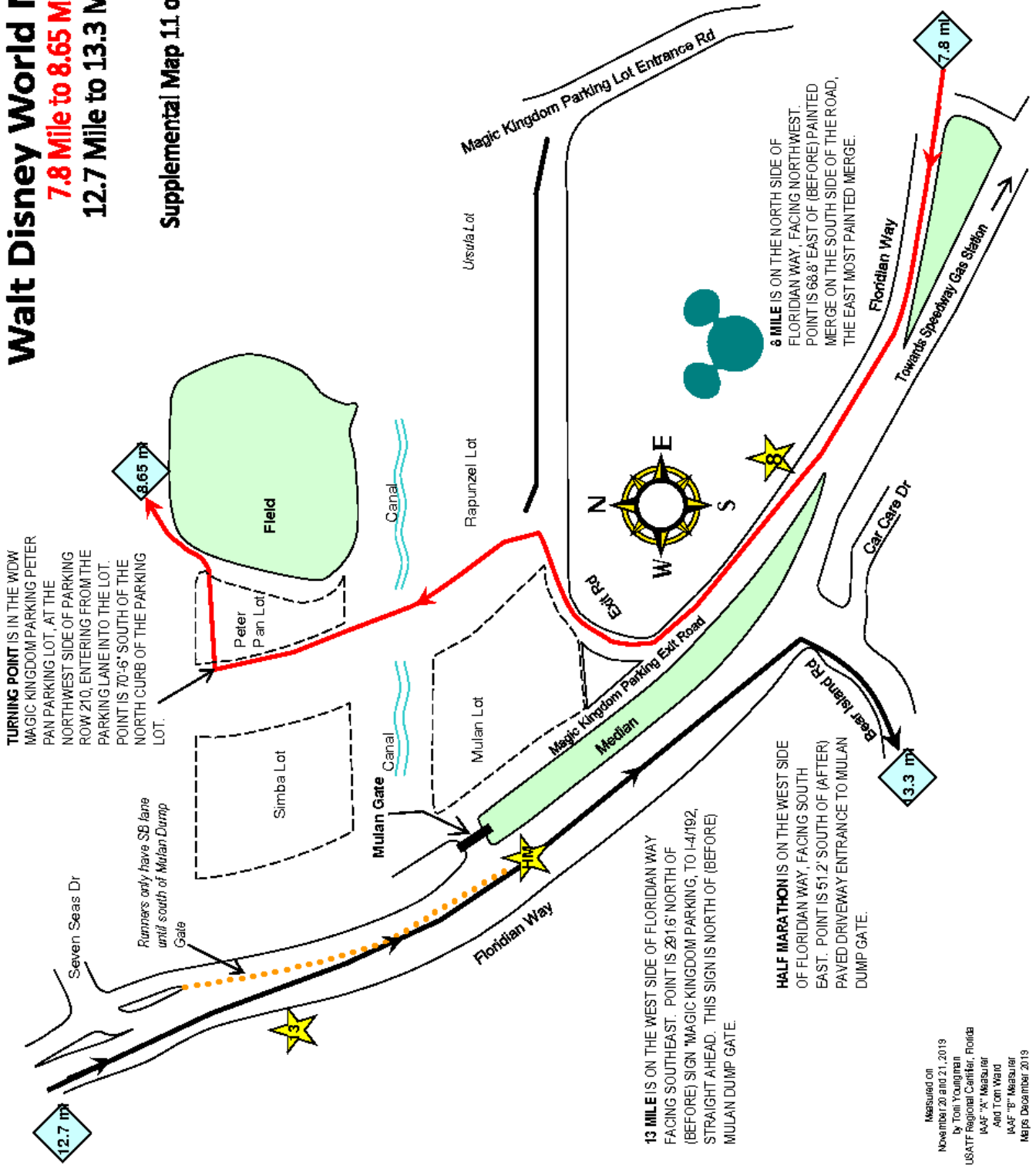

Measured On
November 20 and 21, 2019
by Tom Youngman
USATF Regional Certified, Florida
IAAF "A" Measurer
And Tom Ward
IAAF "B" Measurer
Maps December 2019

Walt Disney World Marathon

13.2 Mile to 15.2 Mile

Supplemental Map 12 of 21

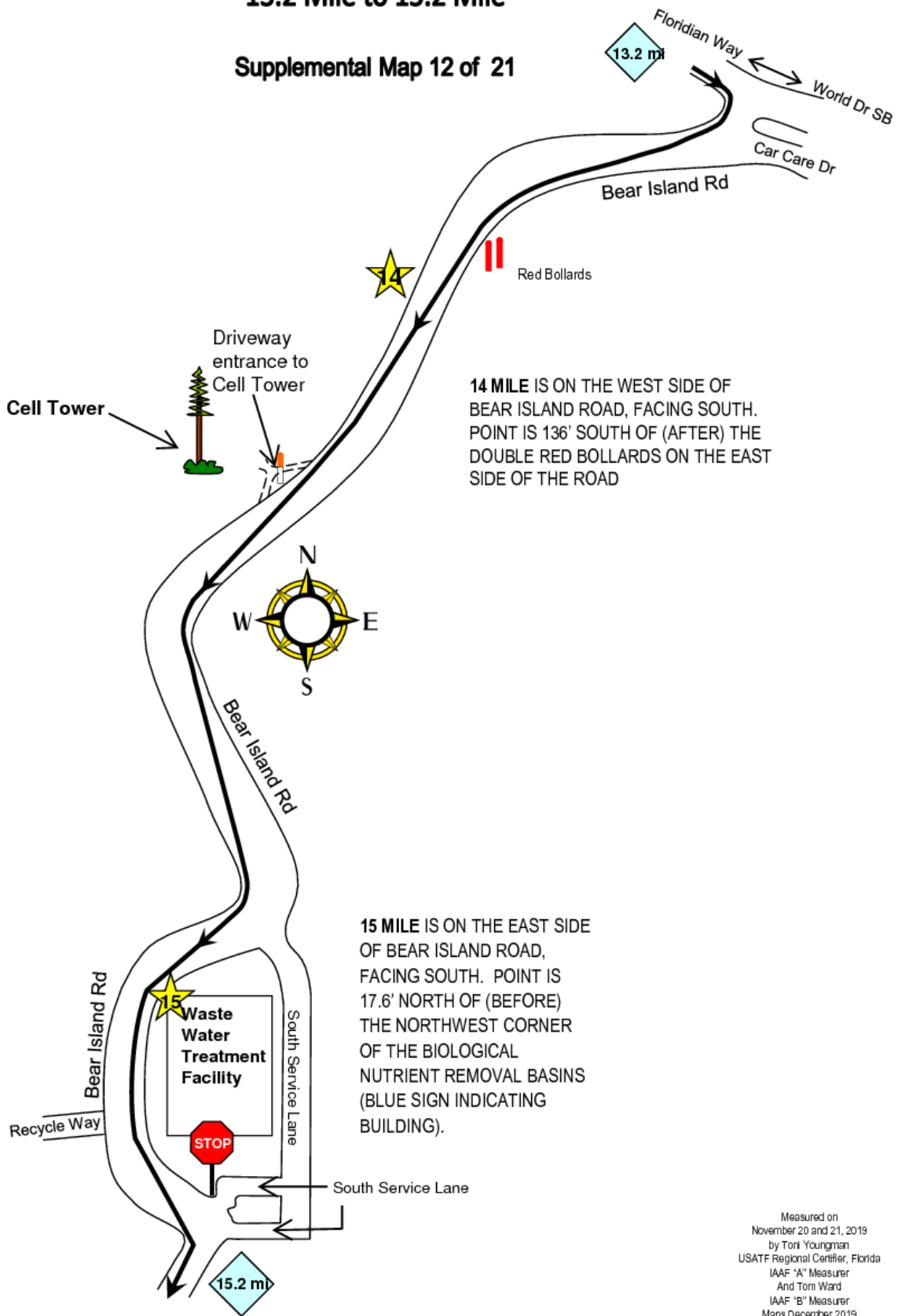

Walt Disney World Marathon

15.1 Mile to 16.5 Mile

17.4 Mile to 19.6 Mile

Supplemental Map 13 of 21

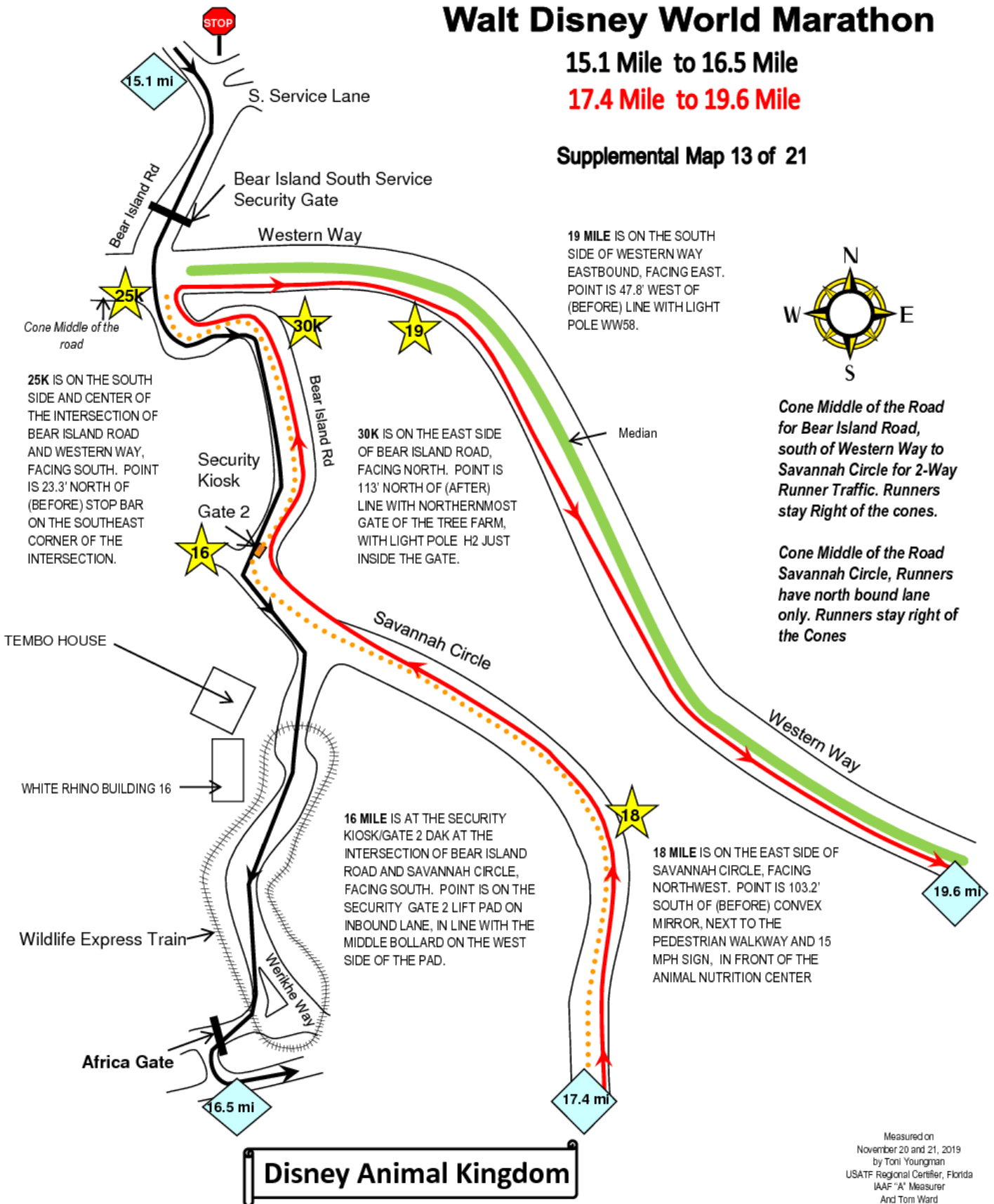

Walt Disney World Marathon

16.4 Mile to 17.5 Mile

Supplemental Map 14 of 21

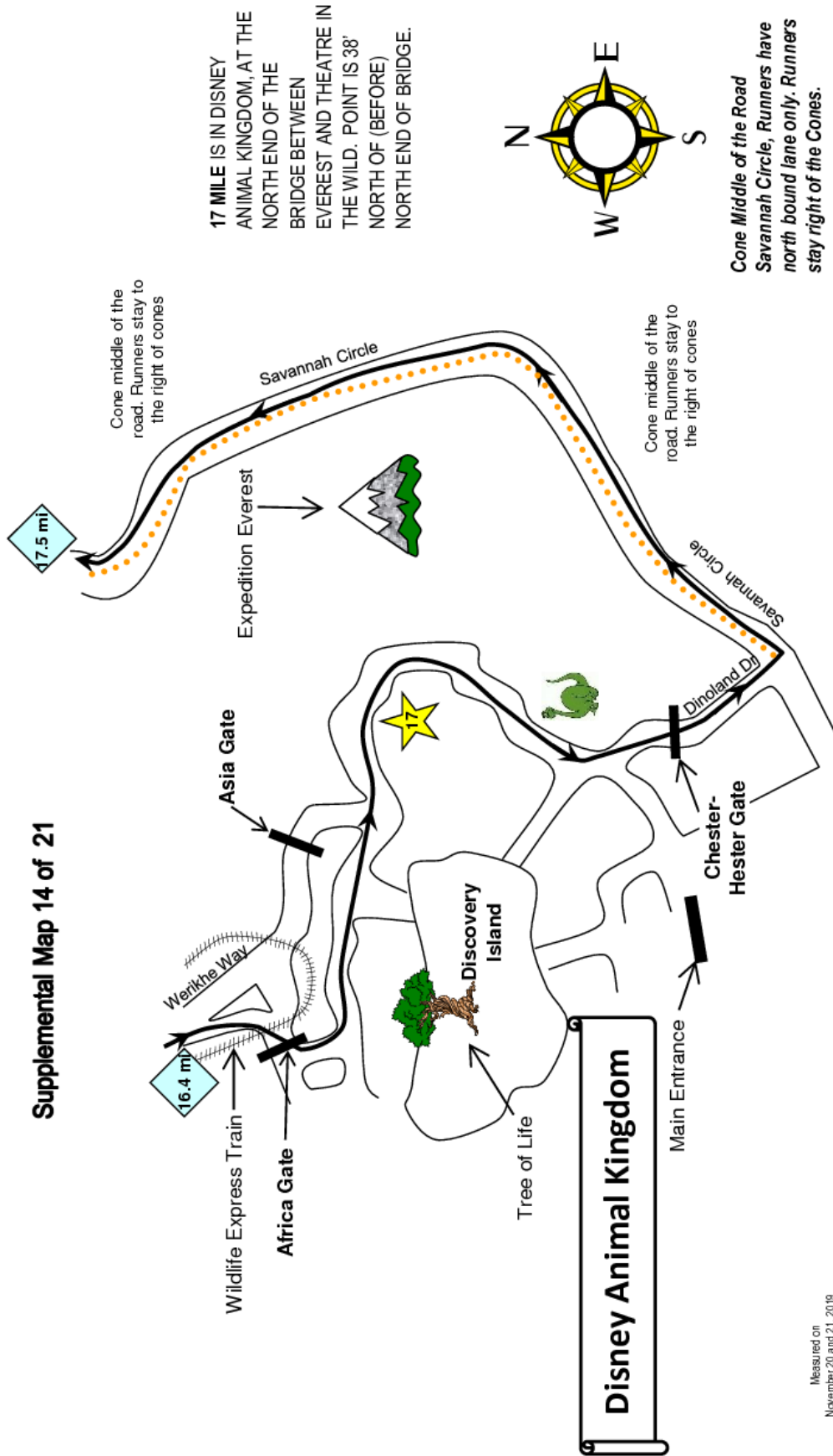

17 MILE IS IN DISNEY ANIMAL KINGDOM, AT THE NORTH END OF THE BRIDGE BETWEEN EVEREST AND THEATRE IN THE WILD. POINT IS 38' NORTH OF (BEFORE) NORTH END OF BRIDGE.

Cone Middle of the Road Savannah Circle, Runners have north bound lane only. Runners stay right of the Cones.

Measured on November 20 and 21, 2019 by Tom Youngman
 USATF Regional Certifier, Florida
 IAAF "A" Measurer
 And Tom Ward
 IAAF "B" Measurer
 Maps December 2019

Walt Disney World Marathon

19.6 Mile to 22.6 Mile

Supplemental Map 15 of 21

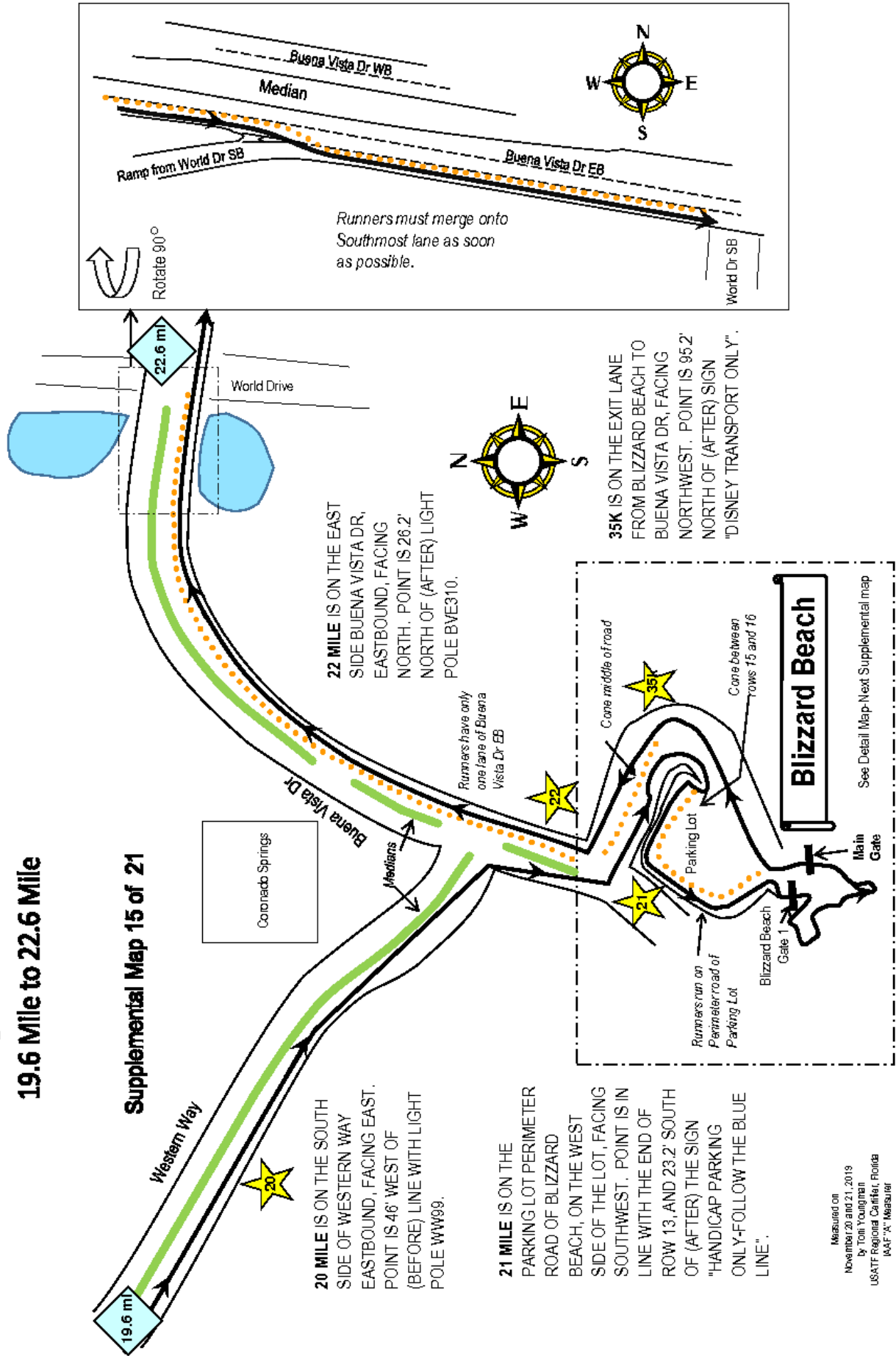

20 MILE IS ON THE SOUTH SIDE OF WESTERN WAY EASTBOUND, FACING EAST. POINT IS 46' WEST OF (BEFORE) LINE WITH LIGHT POLE WW99.

21 MILE IS ON THE PARKING LOT PERIMETER ROAD OF BLIZZARD BEACH, ON THE WEST SIDE OF THE LOT, FACING SOUTHWEST. POINT IS IN LINE WITH THE END OF ROW 13, AND 23.2' SOUTH OF (AFTER) THE SIGN "HANDICAP PARKING ONLY-FOLLOW THE BLUE LINE".

22 MILE IS ON THE EAST SIDE BUENA VISTA DR, EASTBOUND, FACING NORTH. POINT IS 28.2' NORTH OF (AFTER) LIGHT POLE BVE310.

35K IS ON THE EXIT LANE FROM BLIZZARD BEACH TO BUENA VISTA DR, FACING NORTHWEST. POINT IS 95.2' NORTH OF (AFTER) SIGN "DISNEY TRANSPORT ONLY".

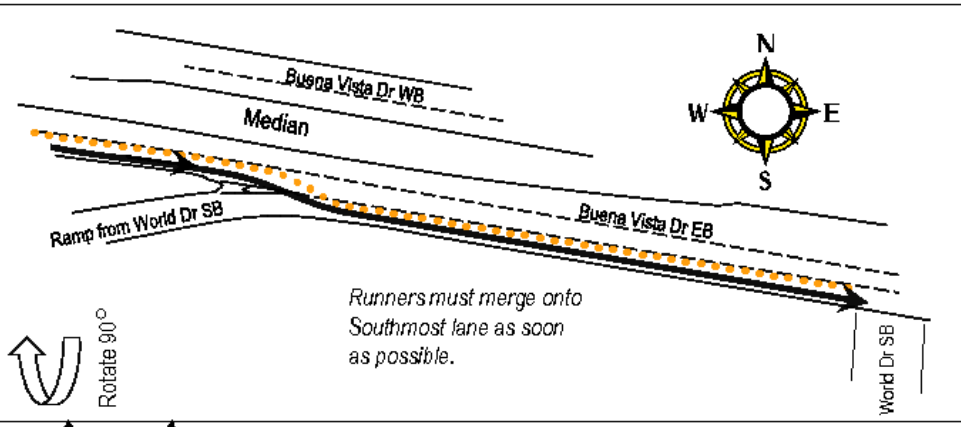

Measured on November 20 and 21, 2019 by Tom Youngren USATF Regional Classifier, Florida IAAF "A" Measurer IAAF "B" Measurer And Tom Ward Maps December 2019

Walt Disney World Marathon

20.4 Mile to 21.9 Mile

Supplemental Map 16 of 21

21 MILE IS ON THE PARKING LOT PERIMETER ROAD OF BLIZZARD BEACH, ON THE WEST SIDE OF THE LOT, FACING SOUTHWEST. POINT IS IN LINE WITH THE END OF ROW 13, AND 23.2' SOUTH OF (AFTER) THE SIGN "HANDICAP PARKING ONLY-FOLLOW THE BLUE LINE".

Cone center of Entrance Road.
Runners stay to the right of cones.

Runners run between Parking rows 15 and 16.

Runners stay on Perimeter Road of the Parking lot.

Runners turn in fast lane between parking rows 1 and 2.

35K IS ON THE EXIT LANE FROM BLIZZARD BEACH TO BUENA VISTA DR, FACING NORTHWEST. POINT IS 95.2' NORTH OF (AFTER) SIGN "DISNEY TRANSPORT ONLY".

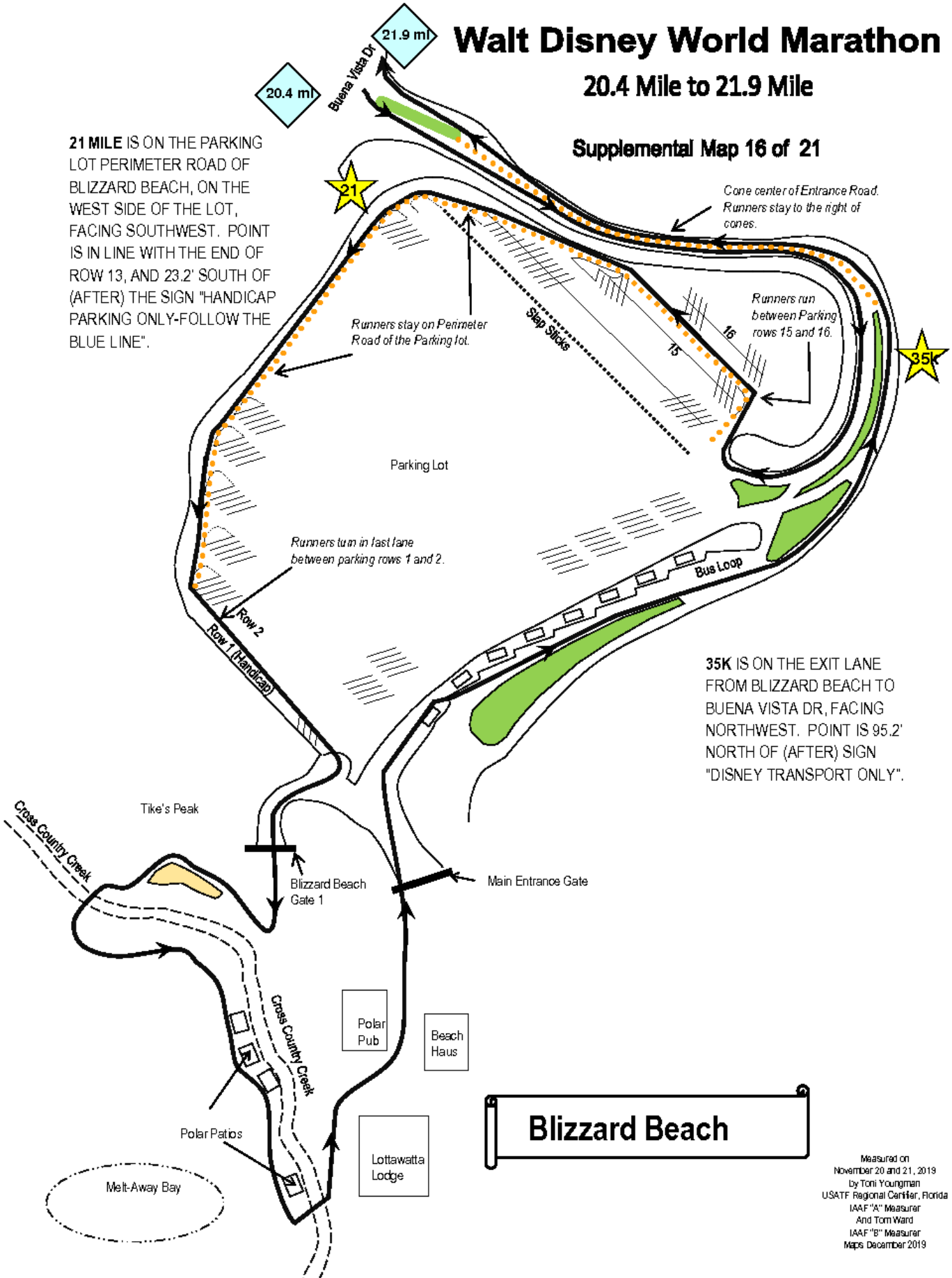

Blizzard Beach

Measured on November 20 and 21, 2019
 by Toni Youngman
 USATF Regional Certified, Florida
 IAAF "A" Measurer
 And Tom Ward
 IAAF "B" Measurer
 Maps December 2019

Walt Disney World Marathon

22.8 Mile to 23.8 Mile

Supplemental Map 17 of 21

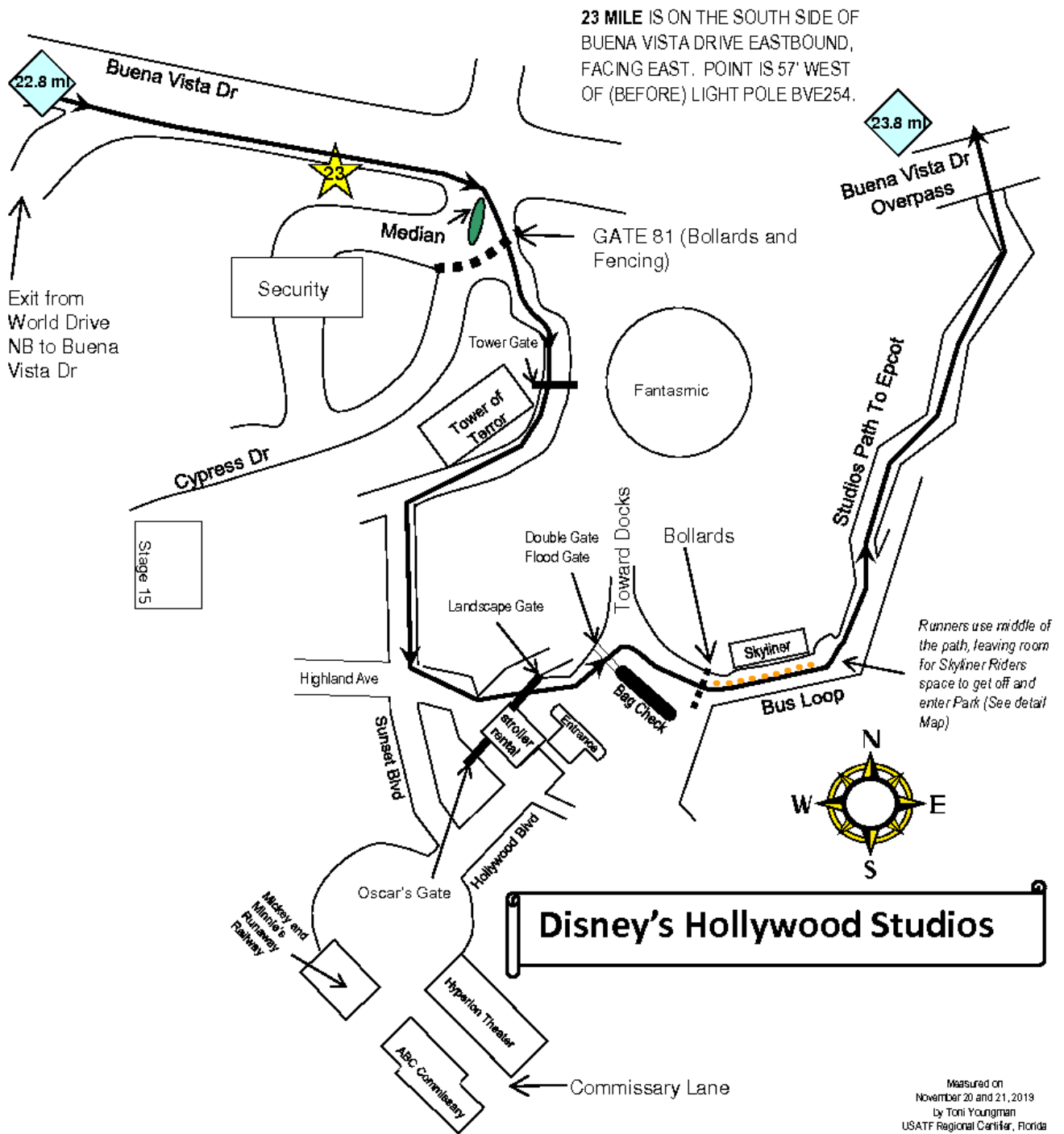

Measured on
November 20 and 21, 2019
by Toni Youngman
USATF Regional Certified, Florida
IAAF "A" Measurer
And Tom Ward
IAAF "B" Measurer
Maps December 2019

Walt Disney World Marathon

Path in front of Hollywood Studios

Supplemental Map 18 of 21

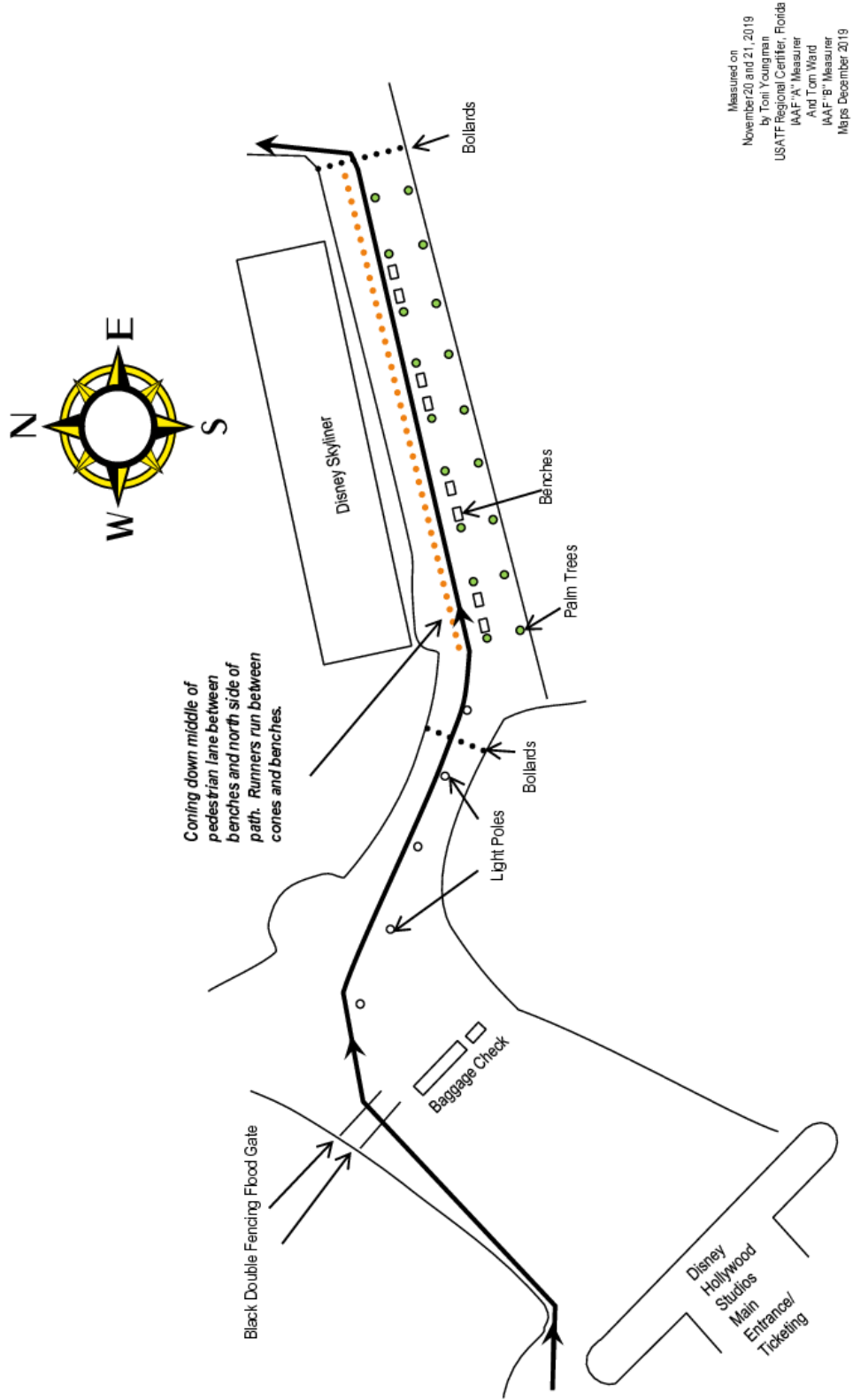

Measured on
November 20 and 21, 2019
By Tom Youngman
USATF Regional Certifier, Florida
IAAF "A" Measurer
And Tom Ward
IAAF "B" Measurer
Maps December 2019

Walt Disney World Marathon

23.6 Mile to 25.2 Mile

Supplemental Map 19 of 21

40K IS ON BACKSTAGE EPCOT, UK / WORLD SHOWCASE, FACING EAST, TOWARD UK GATE. POINT IS IN LINE WITH THE WEST FACING SIDE OF WALK-IN FREEZER FOR UNITED KINGDOM FOOD AND BEVERAGE. POINT IS IN LINE WITH THE SIGN "UK FOOD AND BEVERAGE, FOR AFTER HOURS DELIVERIES".

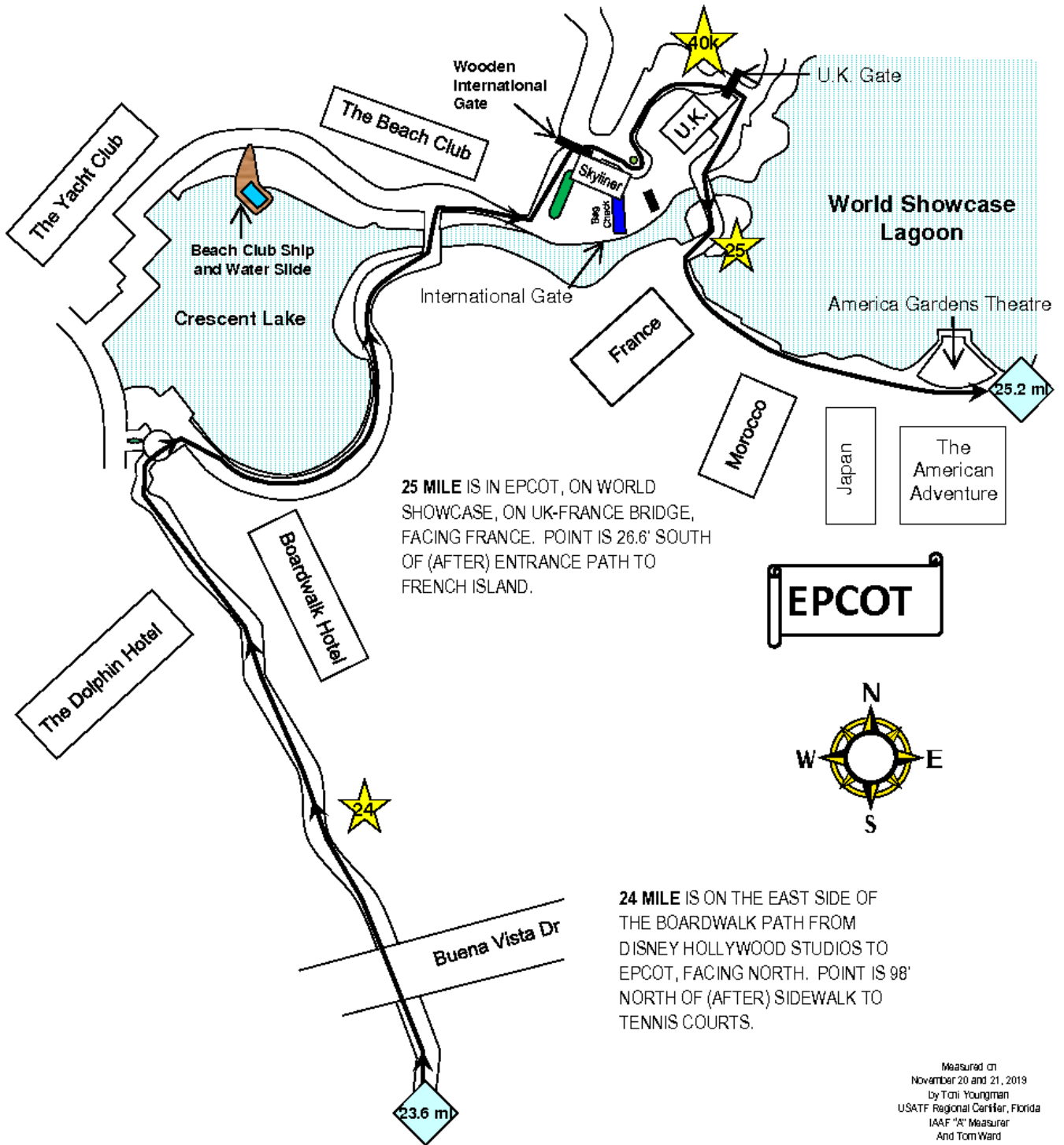

25 MILE IS IN EPCOT, ON WORLD SHOWCASE, ON UK-FRANCE BRIDGE, FACING FRANCE. POINT IS 26.6' SOUTH OF (AFTER) ENTRANCE PATH TO FRENCH ISLAND.

24 MILE IS ON THE EAST SIDE OF THE BOARDWALK PATH FROM DISNEY HOLLYWOOD STUDIOS TO EPCOT, FACING NORTH. POINT IS 98' NORTH OF (AFTER) SIDEWALK TO TENNIS COURTS.

Measured on November 20 and 21, 2019 by Toni Youngman USATF Regional Certifier, Florida IAAF "A" Measurer And Tom Ward IAAF "B" Measurer Maps December 2019

Walt Disney World Marathon

3.1 Mile to 3.4 Mile
25.1 Mile to 25.7 Mile

Supplemental Map 20 of 21

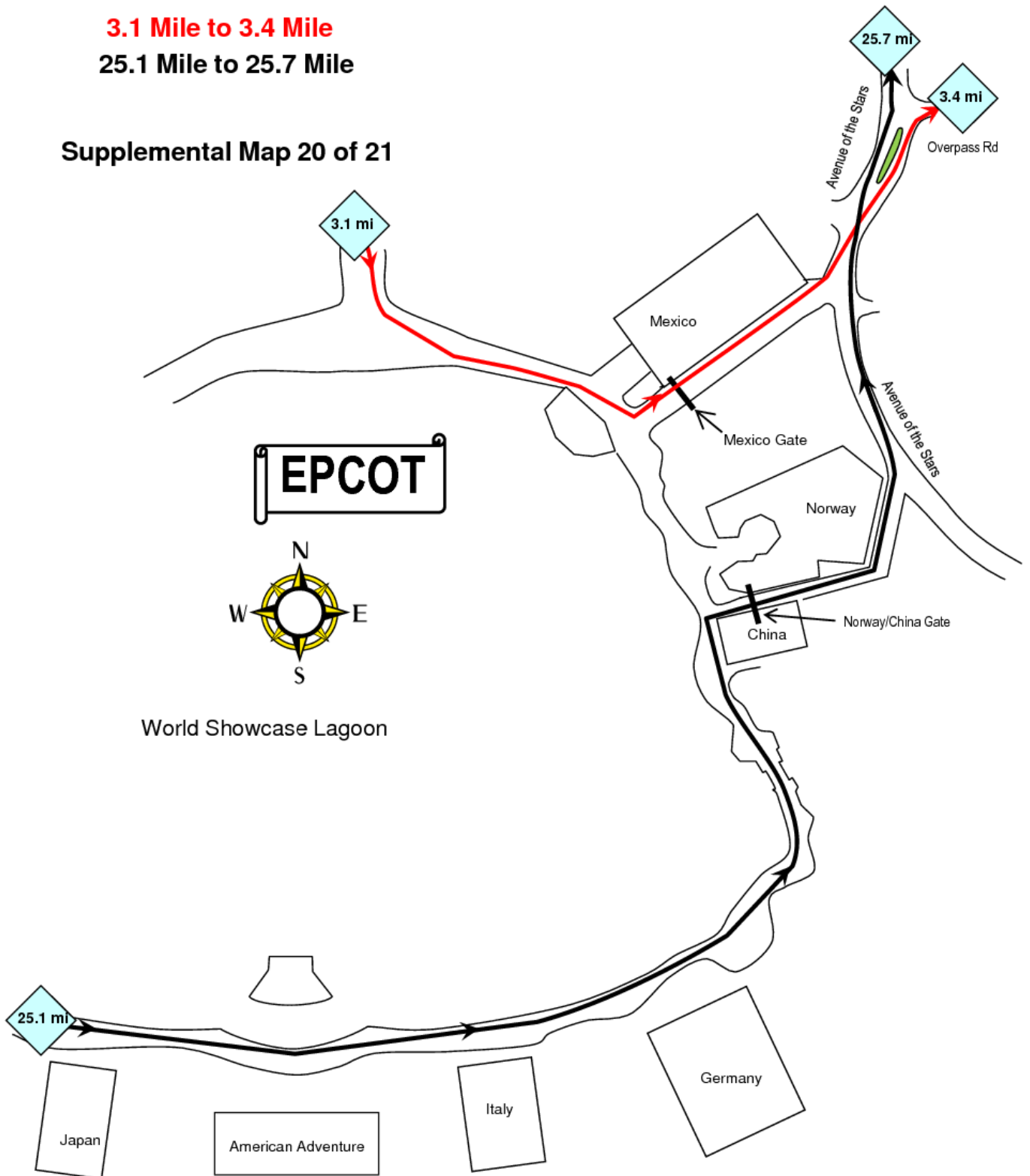

Measured on
November 20 and 21, 2019
by Tom Youngman
USATF Regional Certifier, Florida
IAAF 'A' Measurer
And Tom Ward
IAAF 'B' Measurer
Maps December 2019

Walt Disney World Marathon

2.9 Mile to 3.45 Mile

25.6 Mile to FINISH

Supplemental Map 21 of 21

