



Road Running Technical Council
USA Track & Field

Measurement Certificate



Name of the course Ogden Marathon 2026 Distance 42.195 km

Location (state) UT (city) Ogden

Type of course: Road Race

Measuring Methods: Bicycle

Measured By Caitlyn McKnight, 374 S 671 W, Pleasant Grove, UT 84062, caitlyn@laurelt.com, 385-985-8518

Race Contact Alex Docta, 2440 Washington Blvd, Ogden, UT 84401, (414) 517-9308, alex@goalfoundation.com

Date(s) when course measured: 4/21/2026, 5/1/2026

Number of measurements of entire course: 2 Course Configuration: Point-to-point

Elevation (meters above sea level) Start 1,652.00 Finish 1,313.00 Lowest 1,313.00 Highest 1,652.00

Straight line distance between start and finish 30224m Drop 8.03 m/km Separation 71.63 %

Type of surface: Paved 100 % Dirt 0 % Gravel 0 % Grass 0 % Track 0 %

Effective date of certification: May 12, 2026 Certification code: UT26008TJD

Note to Race Director: Use this Certification Code in all public announcements relating to your race.

Be It Officially Noted That

Based on examination of data provided by the above named measurer, the course described above and in the map attached is hereby certified as reasonably accurate in measurement according to the standards adopted by the Road Running Technical Council. If any changes are made to the course, this certification becomes void, and the course must then be recertified.

Verification of Course --- In the event a National Open Record is set on the course, or at the discretion of USA Track & Field, a verification measurement may be required to be performed by a member of the Road Running Technical Council. If such a remeasurement shows the course to be short, then all pending records will be rejected and the course certification will be cancelled.

This certification expires on December 31 of the year: **2036**

AS NATIONALLY CERTIFIED BY:

Date: May 13, 2026

Trevor Darmstetter - USATF/RRTC Certifier - 803 N Bristol St, Wichita KS 67206
(316) 833-6050 - trevor@timerguys.com

Ogden Marathon 2026

42.195 km
Ogden, UT

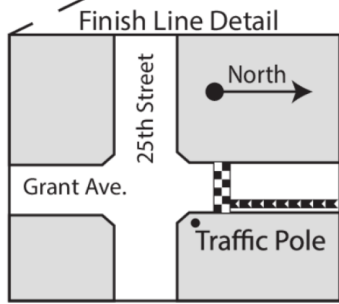

Finish is 3' North of the traffic pole on Grant Ave. on the North side of Grant and 25th



USATF Certificate
UT26008TJD
Effective: 05/12/2026
Through: 12/31/2036

Start (SR -39 through right hand turn onto N 7800 E): Restricted to Right of Center Line

N 7800 E: Remain in right lane until 50ft after raised roundabout concrete center line ends.

N 7800 E - E 500 N - N 7100 E - E 1900 N:
Restricted to Left of Center Lane

N 5500 E - E 2200 N - SR-158 to Ogden Canyon Entrance: No Restrictions

Right Hand Turn into Ogden - Bottom of Ogden Canyon: Restricted to Right Hand Lane

Ogden River Parkway to Park Blvd:
Restricted to asphalt parkway

Park Blvd to Washington Blvd:
Restricted to right of center lane

Park and Washington to 18th and Washington:
Shortest route from turn onto Washington to the left hand turn onto 18th

18th through Grant and Finish Line: No Restrictions

Course Measured by:

Caitlyn McKnight and Adam McKnight
21 Apr 2026
1 May 2026

Course measured used Shortest Possible Route

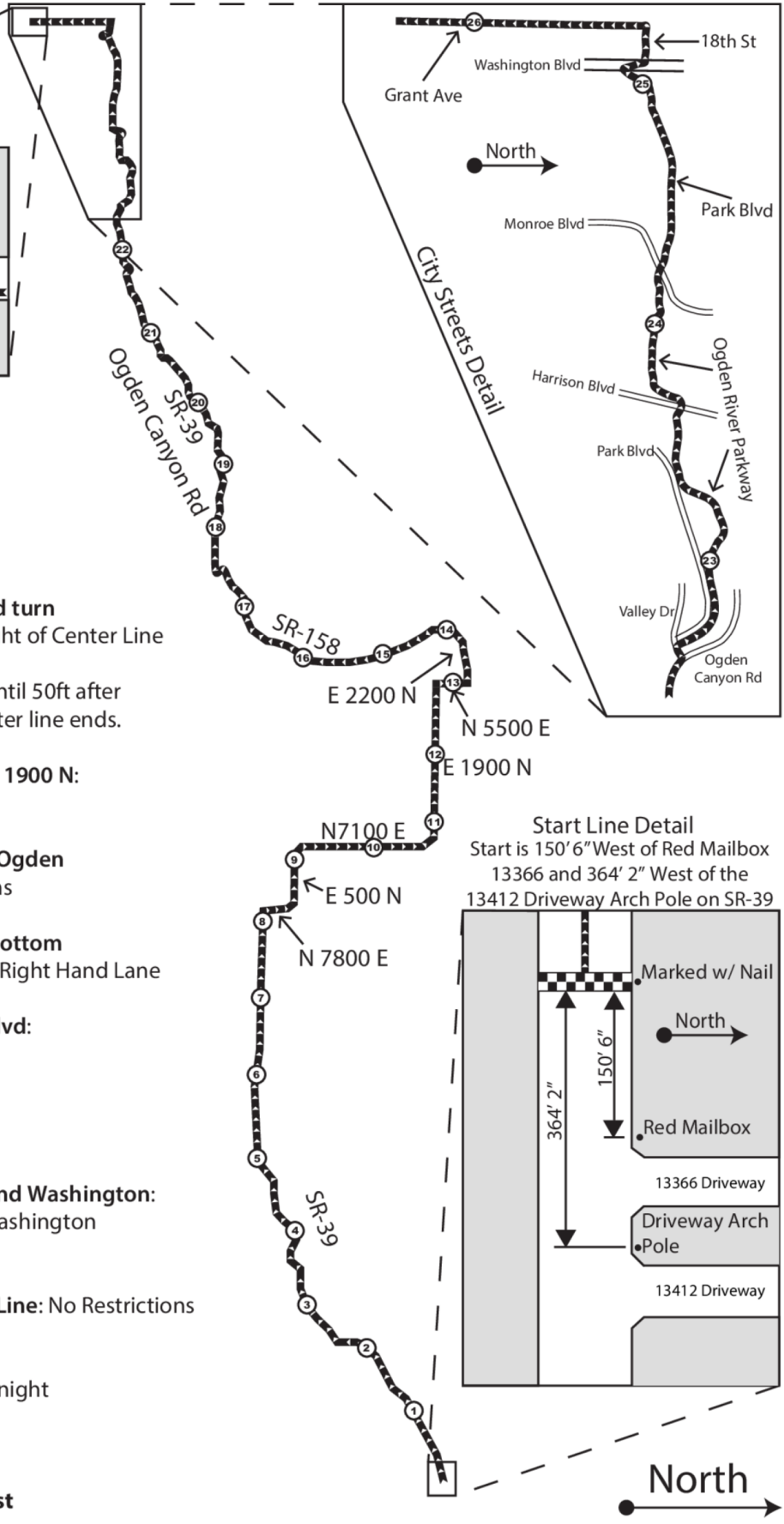

Start: 150' 6" West of Mailbox 13366 on SR-39
& 364' 2" West of Driveway 13412 on SR-39
Mile 1: 321' 3" W of National Forest Perception sign
Mile 2: 38' 2" W of white gate on private drive
Mile 3: 13' 8" W of green electrical box #11630 on
N side of Hwy 39
Mile 4: 21' 1" W of smaller green electrical box on
N side of Hwy 39
Mile 5: 78' 3" W of westside of green gate, knight residence
Mile 6: 97' 0" E of fence running N/S on W side of 9445E 200S property
Mile 7: 33' 6" W of power pole 179800 on S side of RD, E of 8624 E.
Mile 8: 60' 8" W of Hwy 39 Left sign
Mile 9: 92' 4" W of Sping Creek National Forest sign
Mile 10: 7' 0" N of green electrical box on W side of RD
Mile 11: Aligned with 50MHP sign on N of RD after curve
Mile 12: 52' 8" E of power pole with green electrical #189E box
Mile 13: 79' 3" S of power pole on E of RD in front of 2103 N
Mile 14: 110' 1" N of 55MPH sign N of 1915 N House driveway
Mile 15: 106' 6" N of Reserve Ridge sign and gate
Mile 16: 35' 4" S of "No parking" sign in front of 494 UT-158
Mile 17: 3' W of 4th reflector post N side from green
gate E of 128 home
Mile 18: 104' 6" E of "Northrop Grumman Conference Center" sign
Mile 19: 39' 6" W of power pole 172308
Mile 20: 130' W of power pole 184007 stream side
Mile 21: 3' E of power pole 245400 on S side
Mile 22: 43' E of incomplete brown rock gate on both sides of RD
Mile 23: 76' W of green benches
Mile 24: 66' W of manhole by pavilion #5
Mile 25: 28' 3" E of power pole 198918
Mile 26: 10' N of edge of concrete/ashphalt boundary of
ped walkway
Finish: 3' North of traffic light on north side of Grant and 25th

Common Point Alpha (~Mile 8): 68' to end of concrete and 53' 1" to Huntsville sign. Marked
with a nail

Common Point Bravo (~Mile 13): 9' 3" before northern edge of 2103 N 5500 E construction sign
and 38' before northern edge of gate. Marked with a nail